



ATHALIUM

Elevating Spaces with Italian Precision

FINO-U



SHUTTERS

Shutter With Integrated Handle

Designed With A Built-In Handle For Seamless Function And Clean Aesthetics

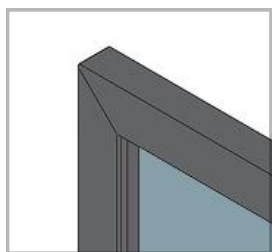
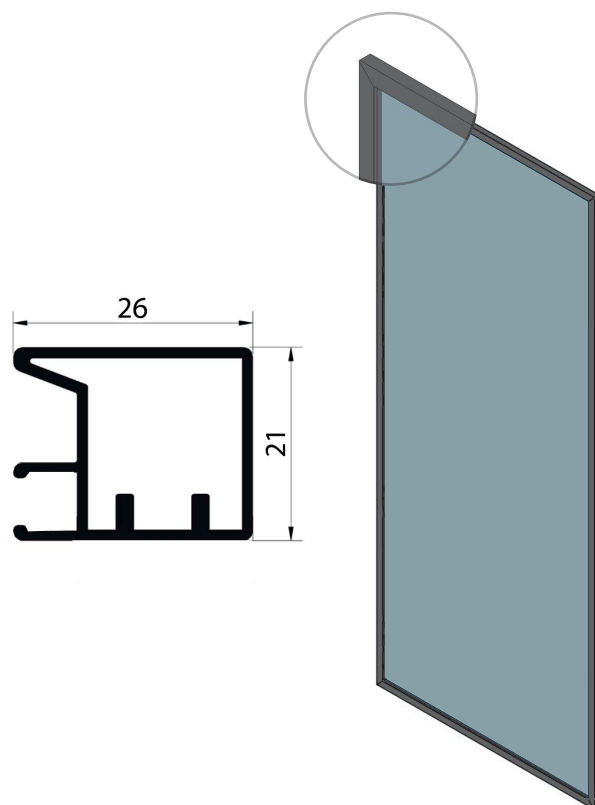

- This Profile Features A Wide Visible Face, Providing A Thicker Frame Around The Glass.

Introduction

Premium **Aluminium Profile** For Glass Applications, Combining Strength, Sleek Design, And Functionality.

Each Shutter Available With **Built-In Handle**, Includes Integrated **Rubber** For Glass Protection, And Is Designed For **4 mm Glass**.

Available In Two Finishes: Anthracite And Matt Black

Colors:



Anthracite

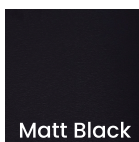

Matt Black

Glass Options

Discover The Different Glass Finishes To
Match Your Style And Function.

Fumé

Bronze

Clear

White Mirror

Bronze
Mirror

Black
Mirror

Ribbed

Back
Painted Black

Back
Painted White

Reflective
Bronze

Reflective
Black

Frosted

Frosted
Ribbed

Note: The Profile Is Designed For 4 Mm Glass.

Hinges And Connectors

Detailed Assembly Instructions For Hinges And Corner Connectors



- Hinges And Corner Connectors Are Available In Right And Left Configurations.

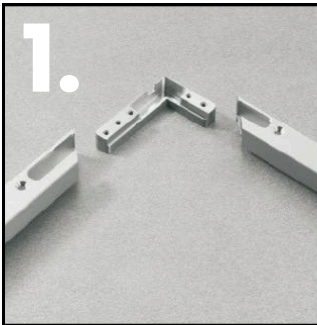

1. Place The Aluminium Profiles At 90° And Insert The Corner Connector.

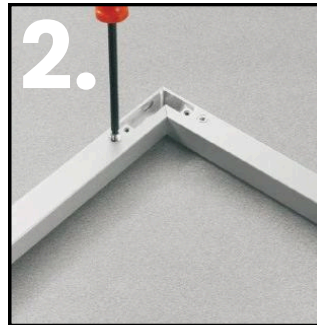

2. Tighten The Screws To Secure The Profiles Together.

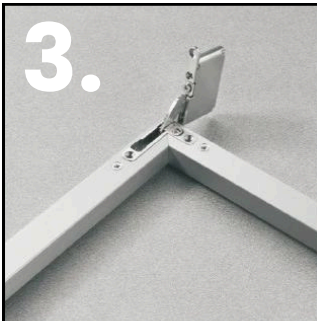

3. Place The Hinge On The Joint In The Marked Position.

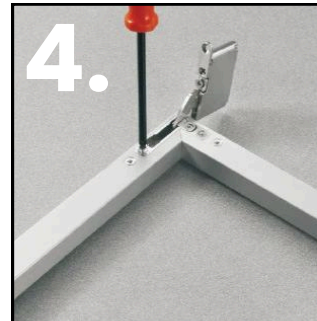

4. Tighten The Screws To Secure The Hinge To The Profile.

Installation Instructions

Follow These Steps To Ensure Accurate Drilling Positions.

- **Option 1: Direct Installation**

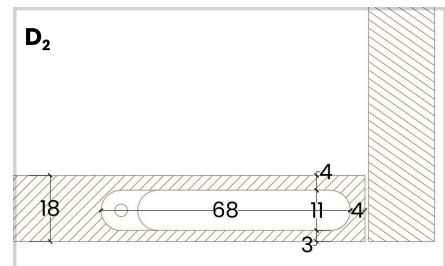
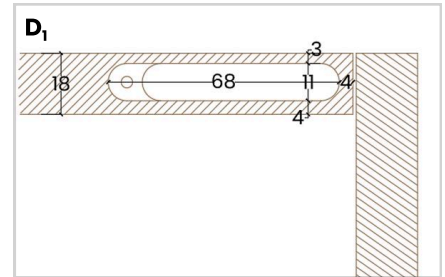
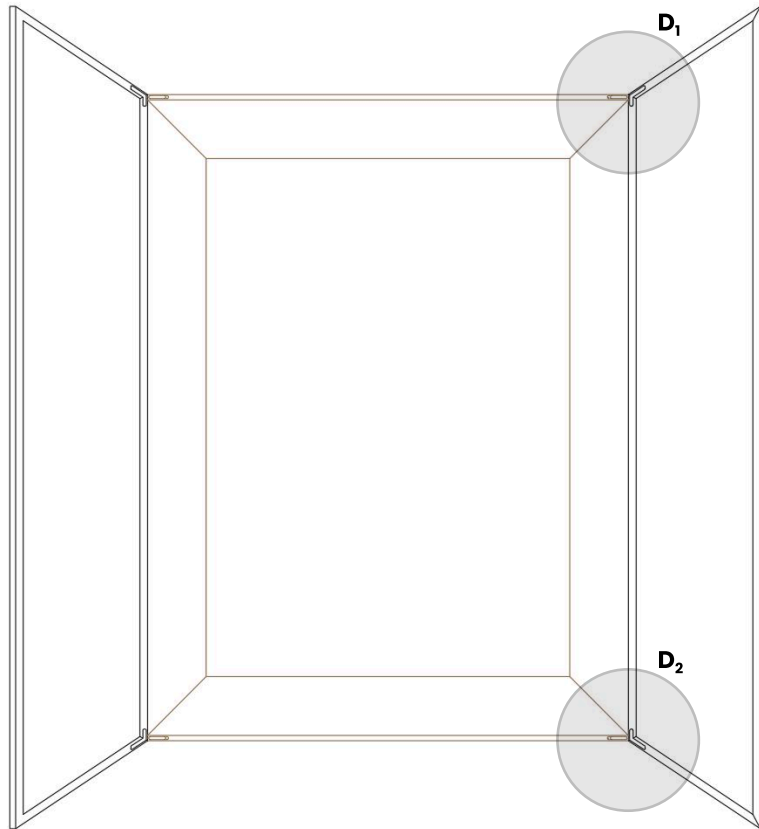

- The Top Panel Of The Wooden Unit Can **Vary In Thickness**.
- For 18 Mm Panels, Dimension X Must Be **At Least 3 Mm**.
- The Client Should Drill The Wood According To The **Dimensions Indicated Above**.

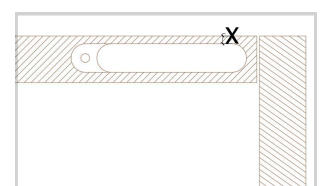
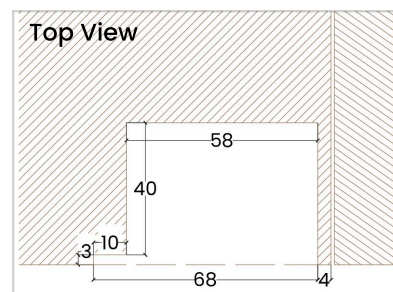

Installation Instructions

Follow These Steps To Ensure Accurate Drilling Positions.

- **Option 2: With Hinge Installation Bracket**

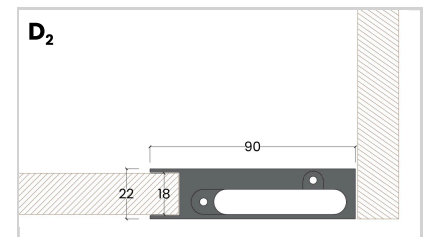
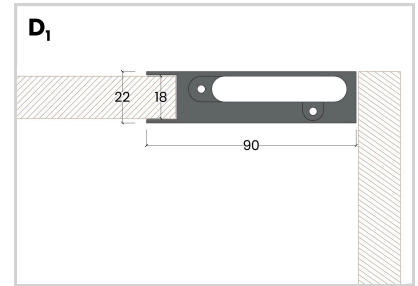
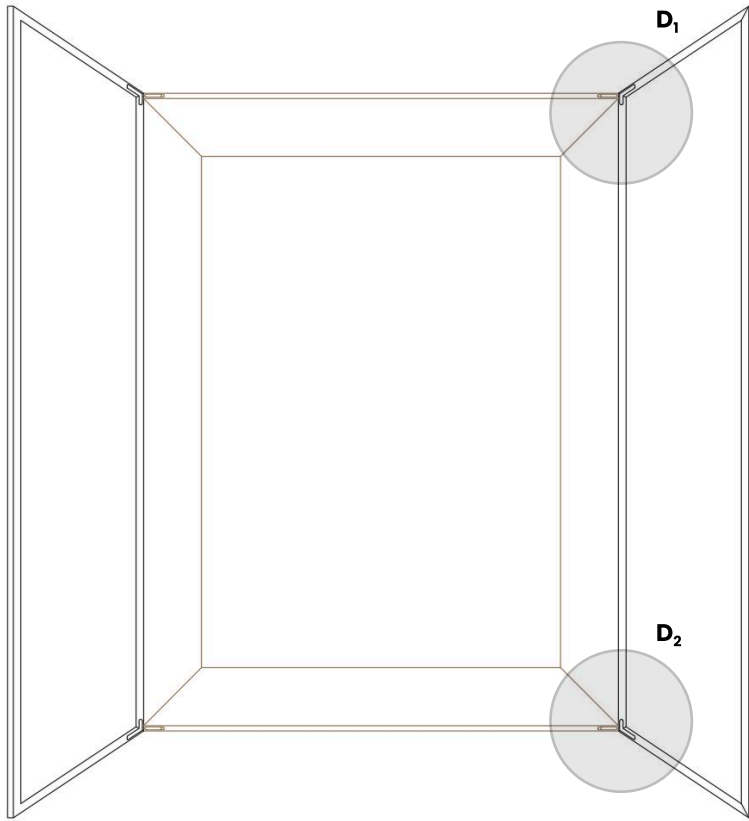

- Requires An **18 mm Thick Wooden Panel** Only.
- The Aluminium Mounting Profile Ensures **Secure Attachment** Of The Shutter.
- The Client Should Drill The Wood According To The **Indicated Dimensions To Fit The Profile**.

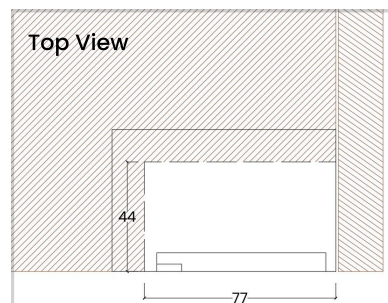

Hinge Installation Bracket



Shutter Adjustments

Easily Adjustable In Side, Depth, And Height For Perfect Alignment

- Sideways Adjustment

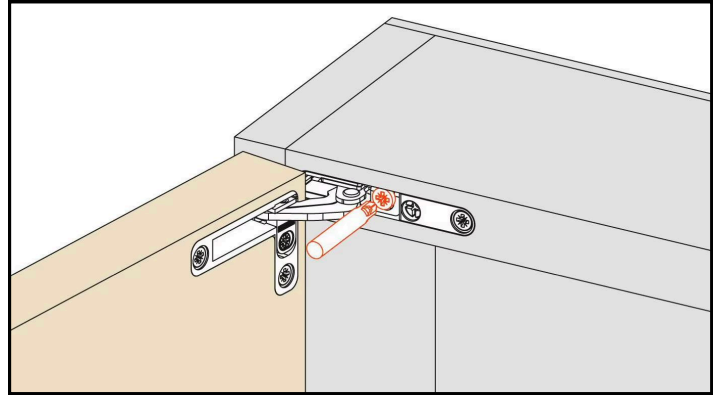
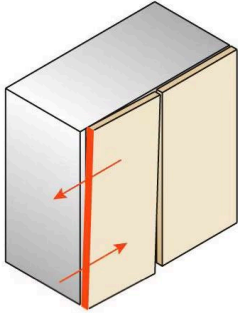

- Depth Adjustment

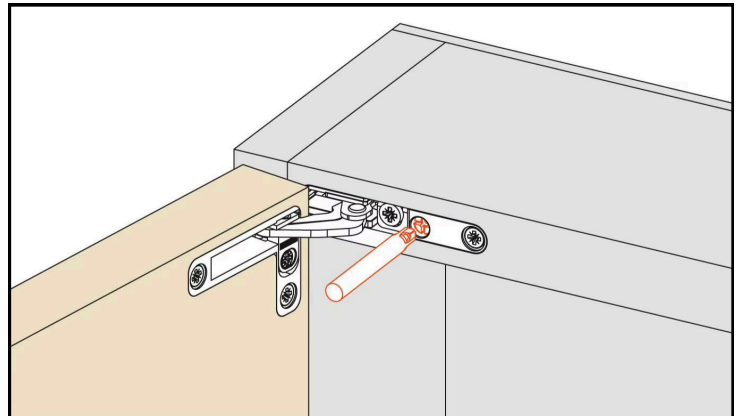
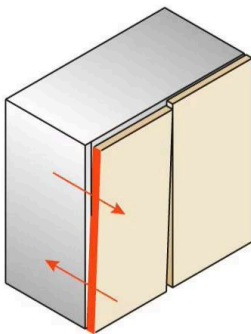

- Height Adjustment

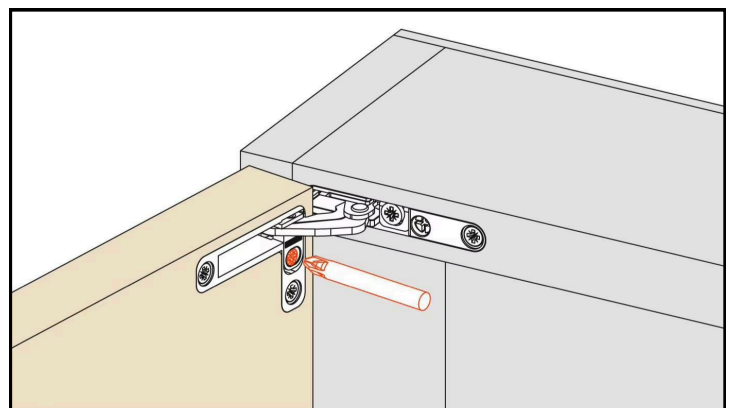
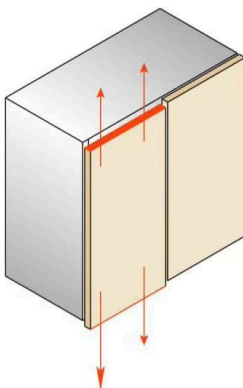



| Shutter

Nathalium .Co

Jamal Abdul Nasser Str. - Al Bahsas - Tripoli, Lebanon

Tel: 06/411790 , 06/411 791 - cell: 71/847529

www.nathalium.com - info@nathalium.com



© NATHALIUM 2025. All right reserved