



NATHALIUM

Elevating Spaces with Italian Precision

CLOSETS

gap
ITALIA

USUAL SYSTEM

MANHATTAN SHUTTERS

TABLE OF CONTENT

- 01** Introduction 03
- 02** Materials & Tools
 - Fittings 05
- 03** System Structure
 - Roller Sytems 06
 - Upper System 07
 - Lower System 08
- 04** System Installation
 - Upper & Lower Tracks 09
 - Upper Rollers 10
 - Lower Rollers 11
 - Activators On Rollers 12
 - Shutters Installation 13

- 05** Sliding Door Options
 - 2 Door Configuration 14
 - 3 Door Configuration 15
 - 3 Door Configuration 15
 - Dimensions 17
- 06** Shutter Options
 - Shutter Types 18
- 07** Manhattan Shutters
 - Shutter Types 19
 - Options 20
 - Plate Details 21
 - Partition Details 22

INTRODUCTION

The GAP Closet System is designed with functionality, durability, and clean design in mind. This catalogue provides detailed information on the installation process, including rail fixing and positioning, shutter profiles with dimensions, and available configurations for 2-door, 3-door, and 4-door systems. The catalogue also covers the soft-close mechanism for smooth and reliable operation.



MATERIALS & TOOLS

Fittings

FAP
Upper Soft Stopper
With Long Race

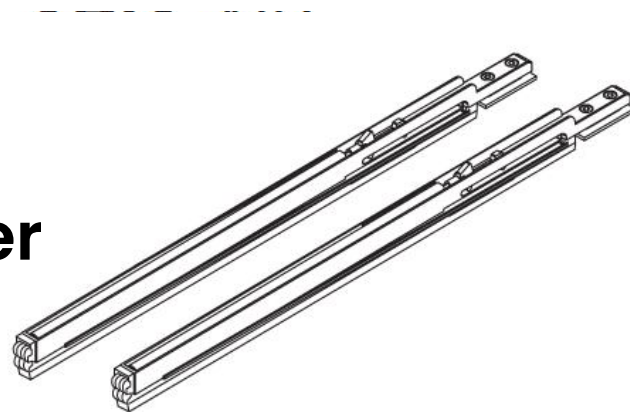

FDS
Upper
Soft Stopper

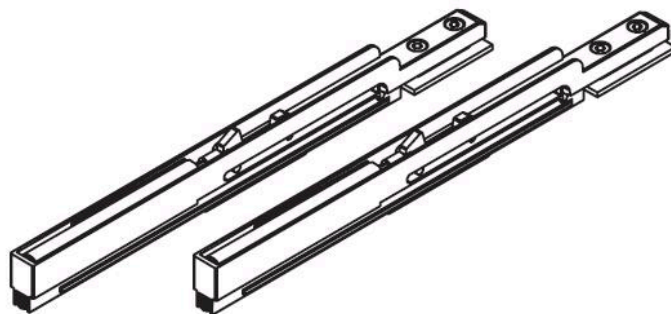

FDI
Lower
Soft Stopper

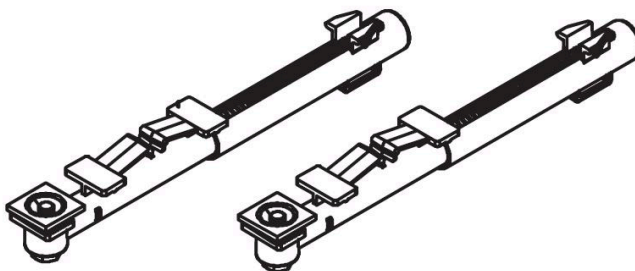

GFC
Rubber Stop
Between The
Doors

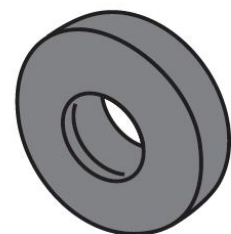

Upper Rail

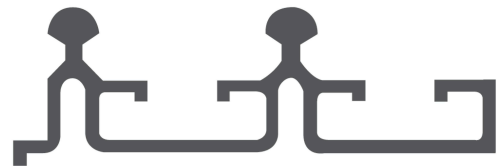

Lower Rail



FSS
Upper Stopper

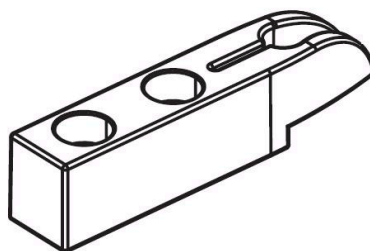

FSI
Lower Stopper

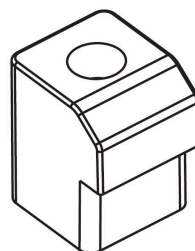

ATF
Activator

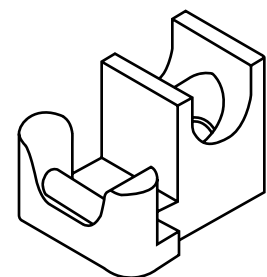

SYSTEM STRUCTURE

Roller Systems

Roller types:

- for doors weighing up to 100 kg.
- Two options available to suit doors with a maximum thickness of 26 mm or 35 mm.

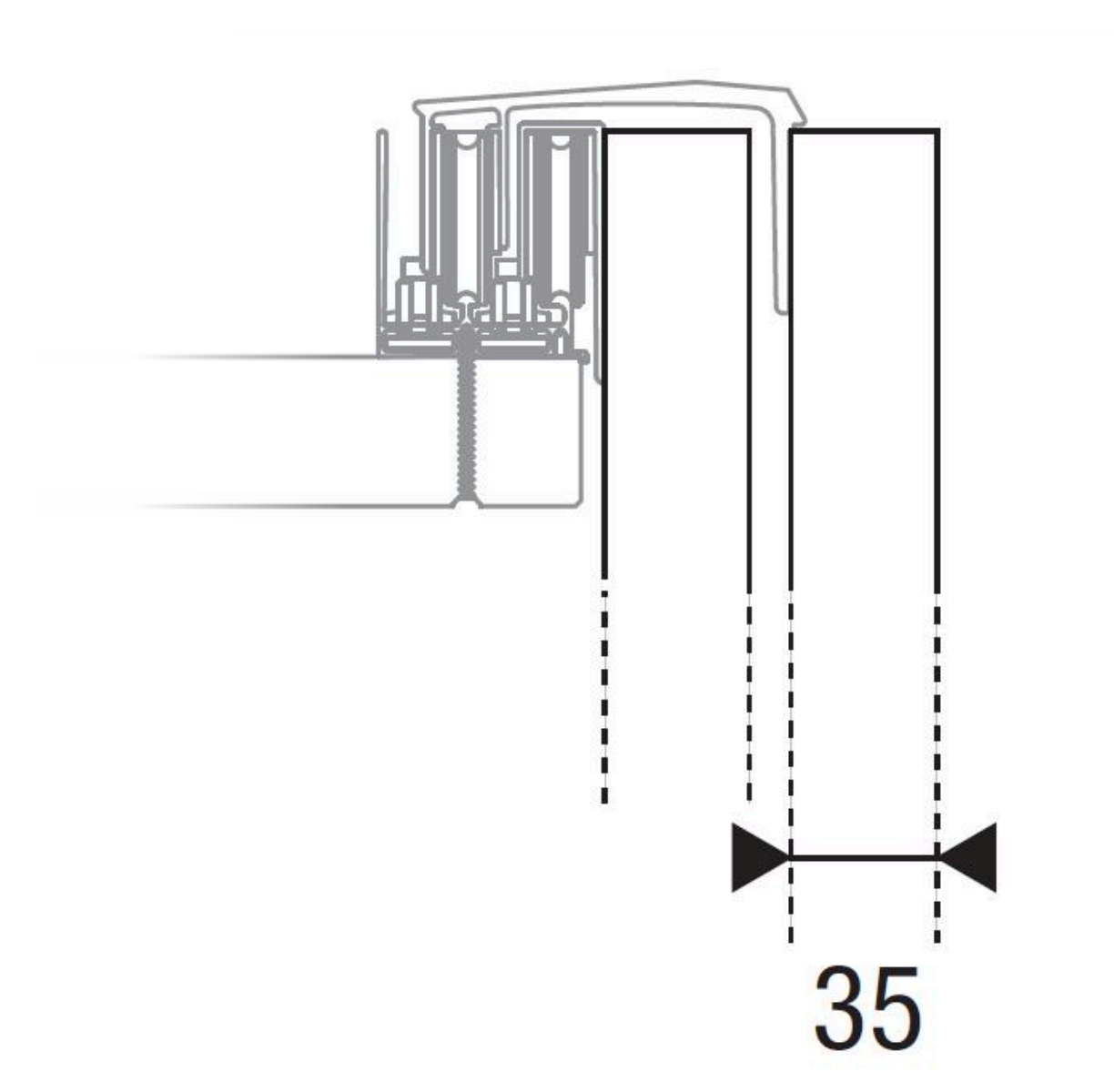
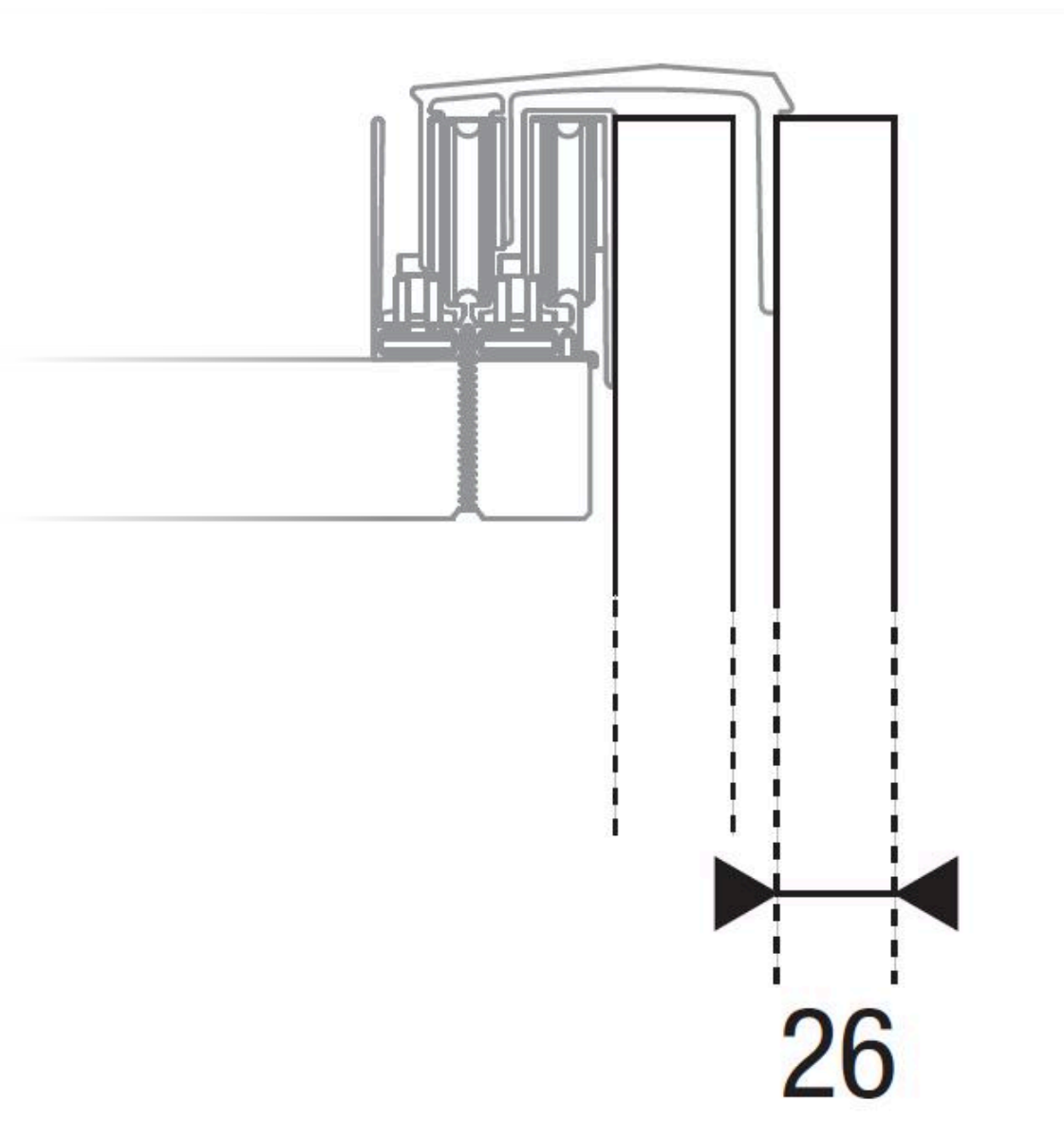

SYSTEM STRUCTURE

Upper System

- The upper system includes an upper rail with two rollers, inside and outside, to guide the shutters smoothly.
- Upper rollers, inside and outside, are designed in **two sizes** for **max. 26 mm and 35 mm** shutters.

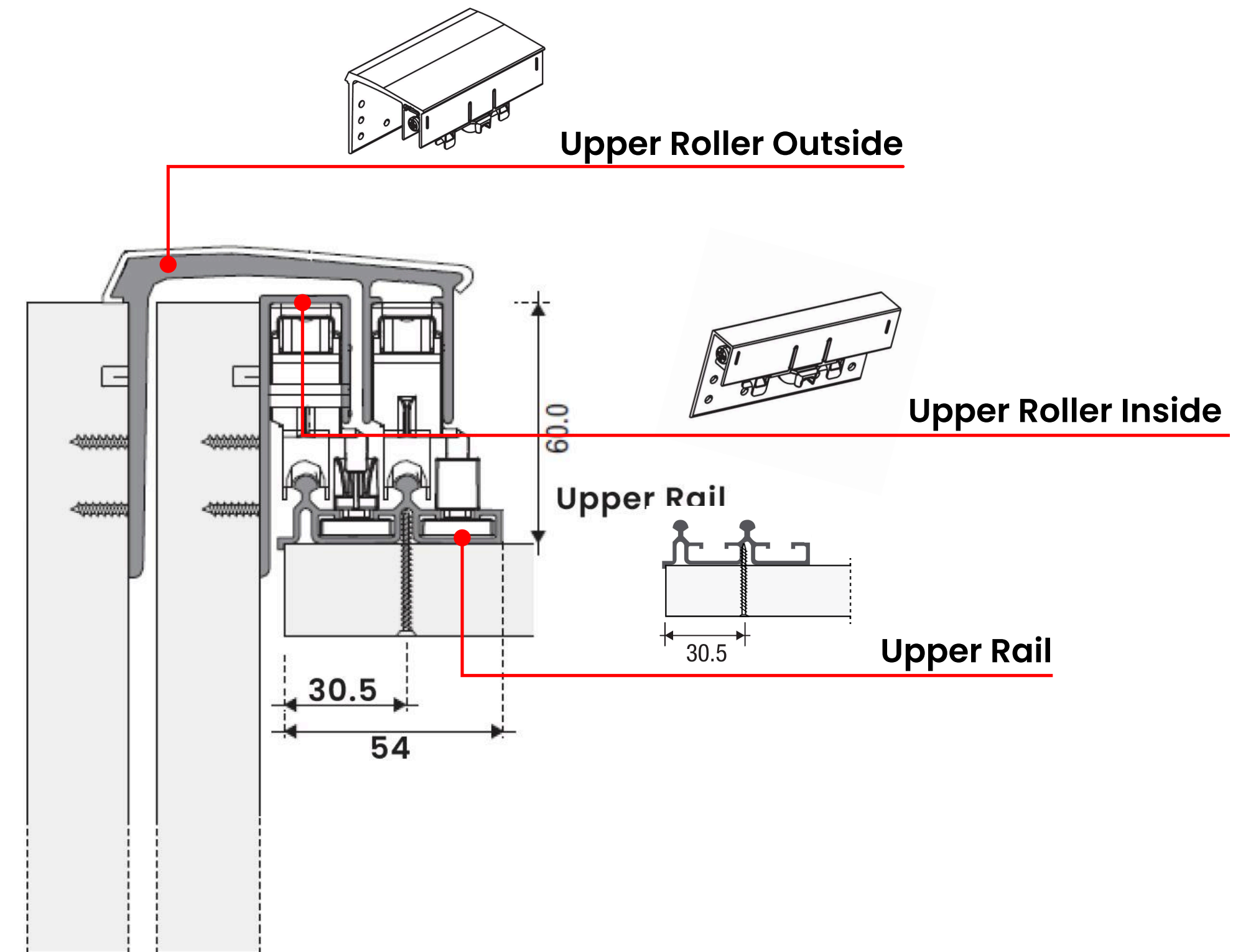
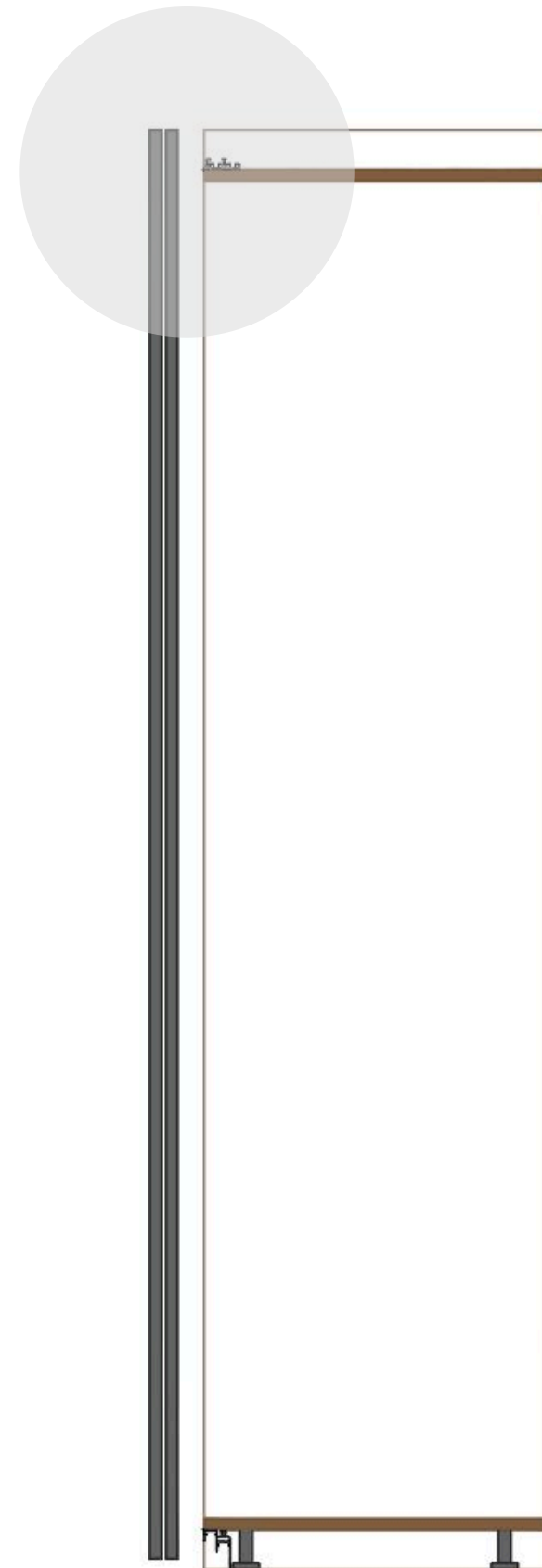

SYSTEM STRUCTURE

Lower System

- The lower system includes a lower rail with two rollers, inside and outside, to guide the shutters smoothly.
- Lower rollers, inside and outside, are designed in **two sizes** for **max. 26 mm and 35 mm** shutters.

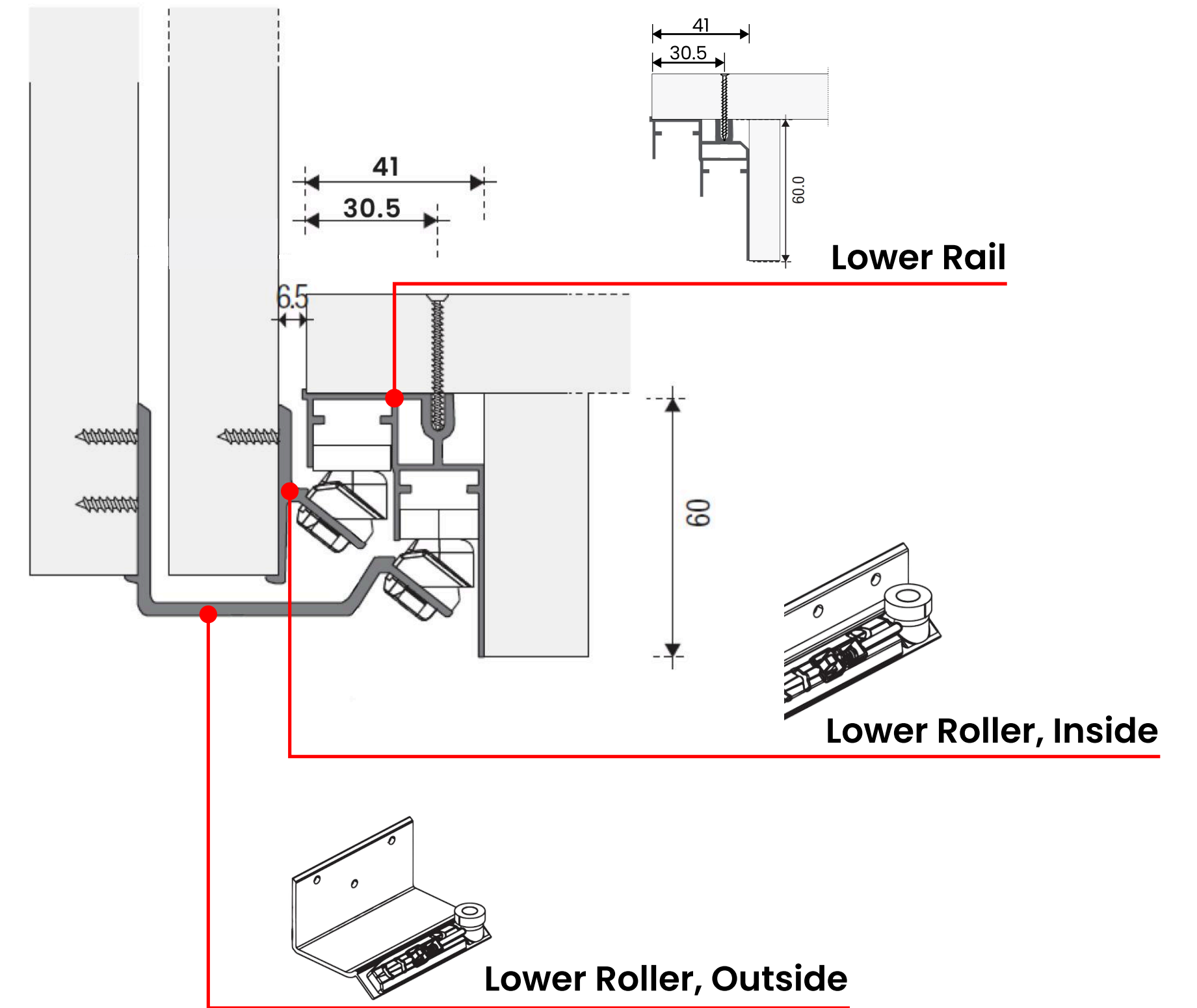
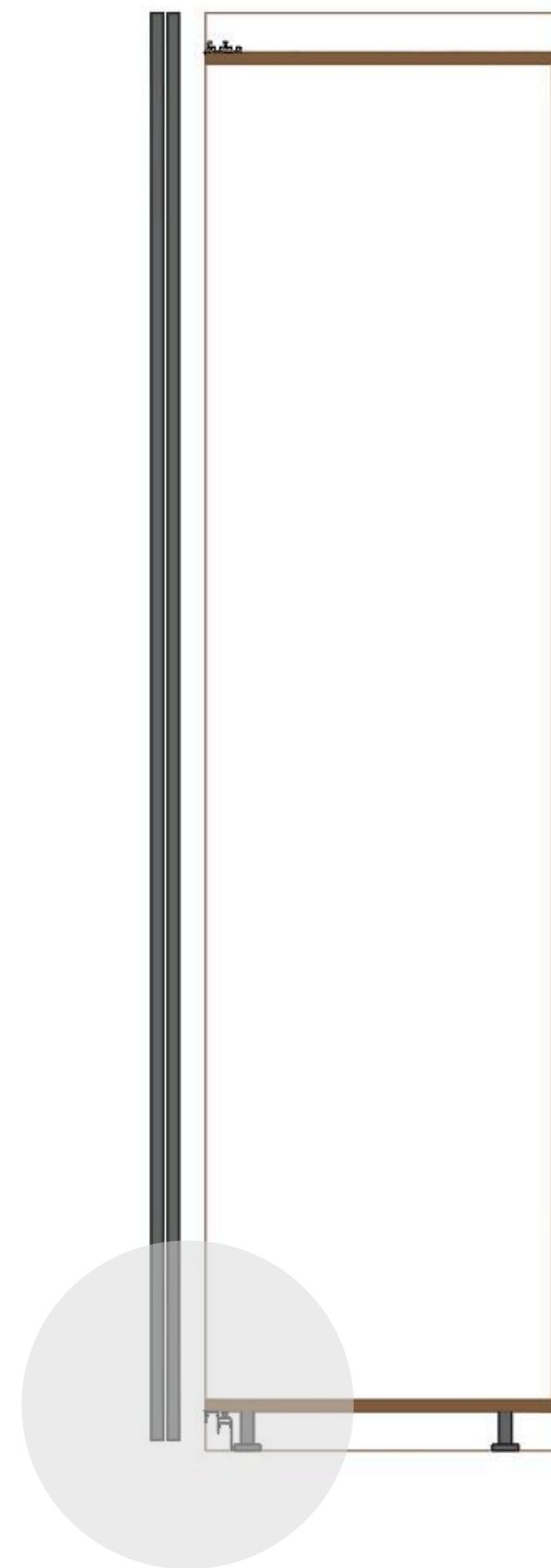

SYSTEM INSTALLATION

Upper And Lower Tracks

Upper and Lower tracks installed with two options:

- Option A: Soft Closing System

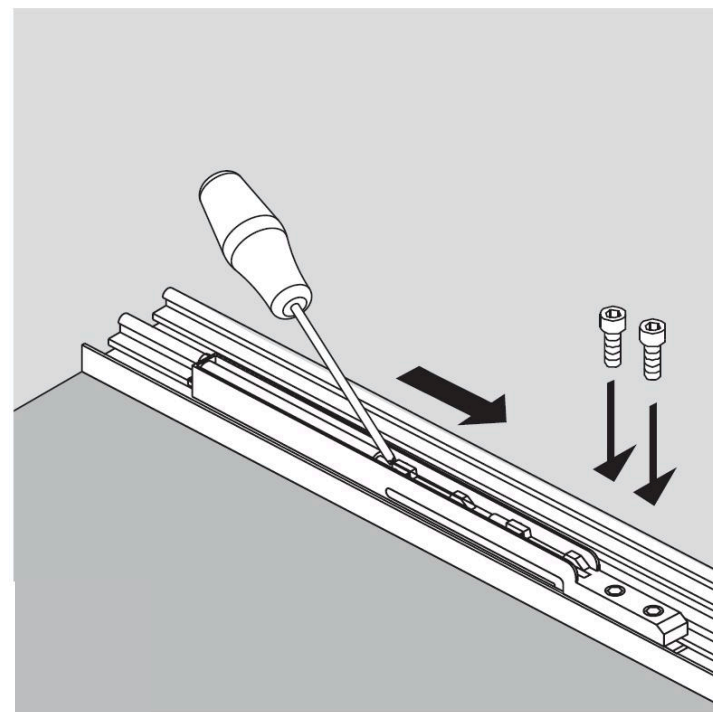

Insert the **upper soft stopper** (FAP or FDS) in the rail.

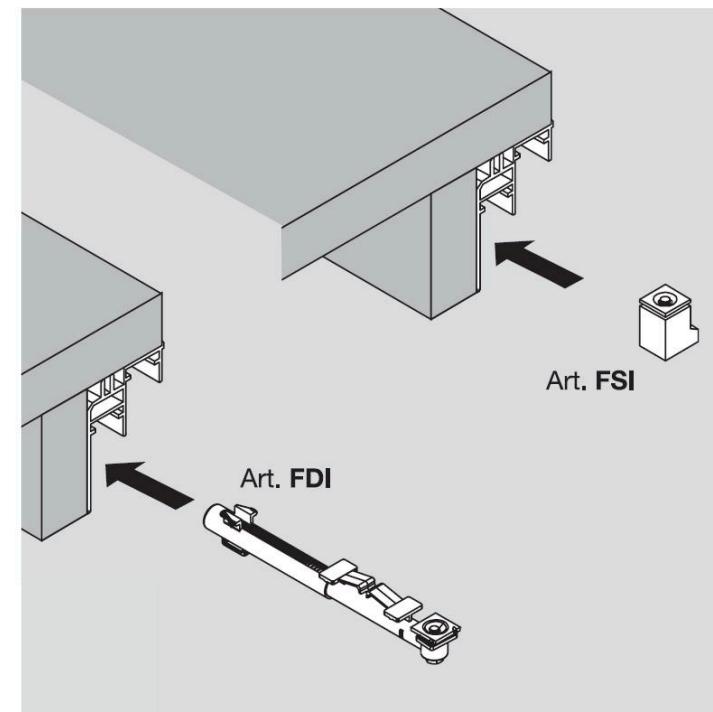

Insert the **lower soft stopper** (FDI), or the **lower stopper** (FSI), in the rail.

- Option B: Fixed Closing System

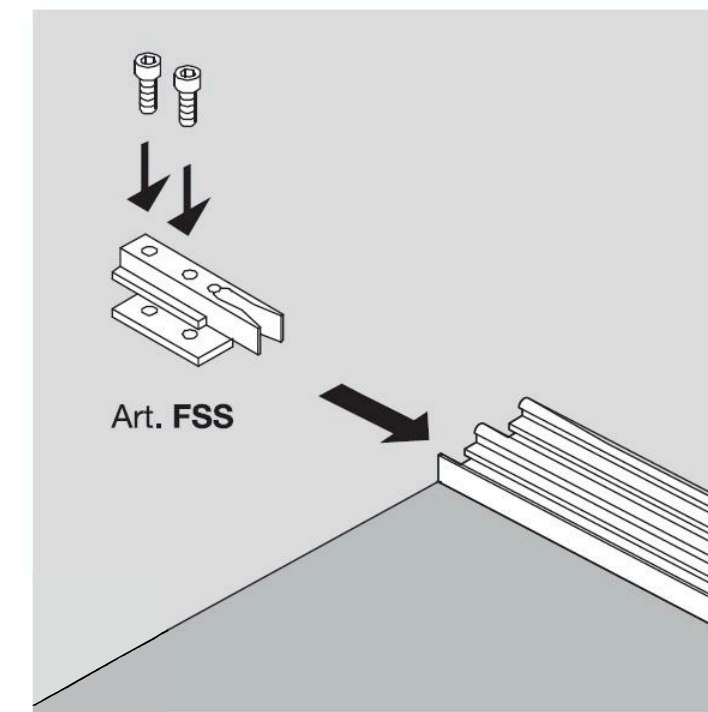

Insert the **upper stopper** (FSS) in the rail.

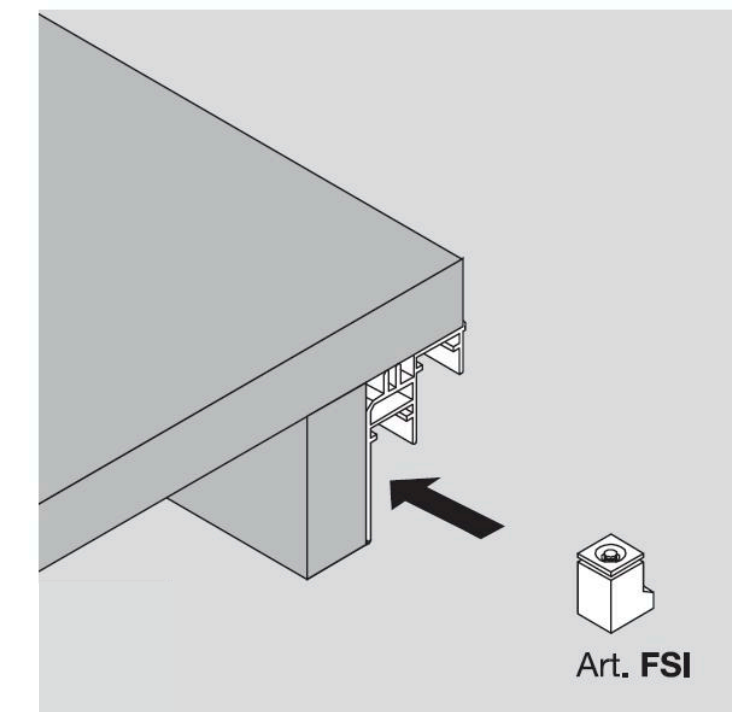

Insert the **lower stopper** (FSI) in the rail.

SYSTEM INSTALLATION

Upper Rollers

Install the Upper rollers for both internal and external door panels:

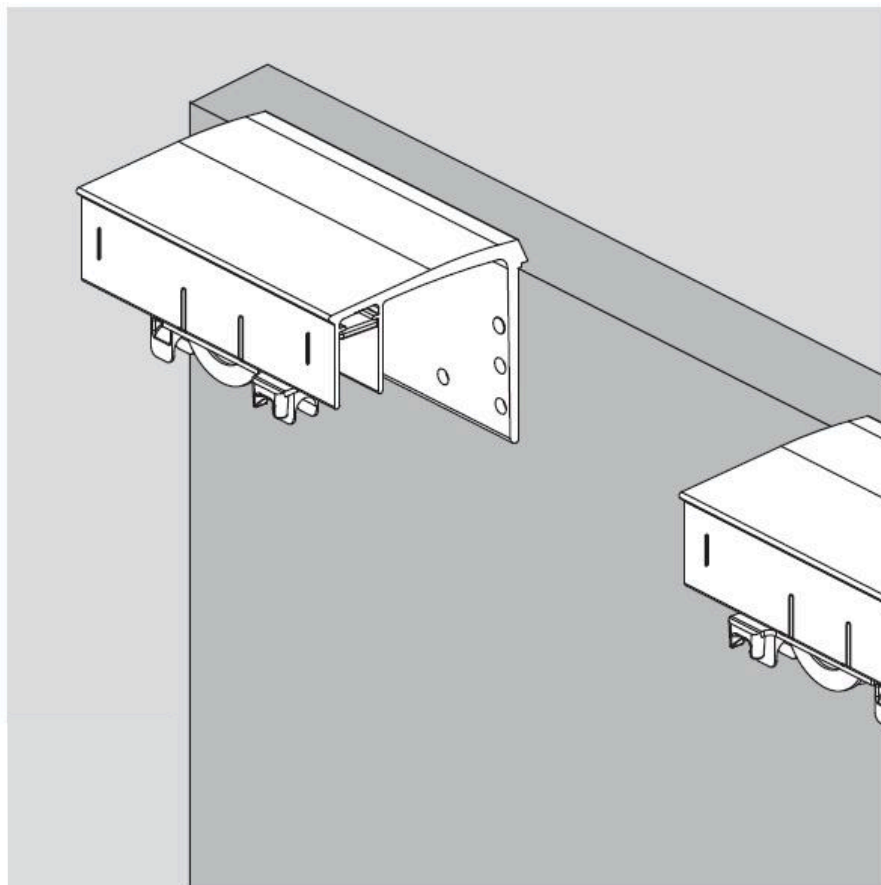

- **external door**
Mount the **upper roller for external door**, keeping the adjusting screw towards the internal part of the door.

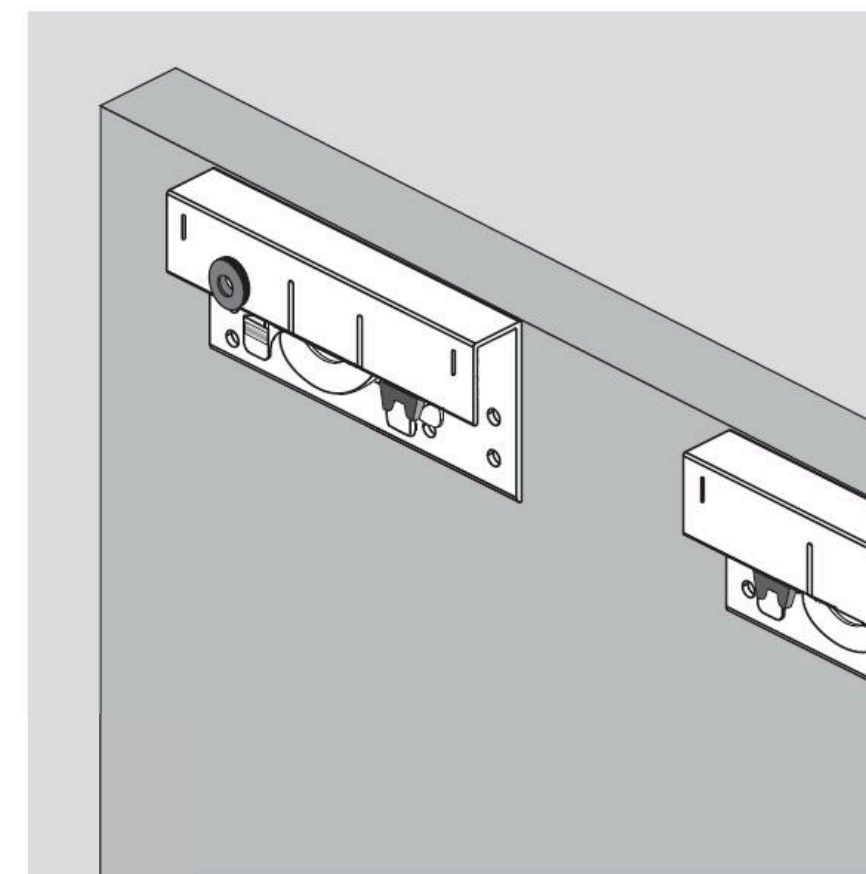

- **internal door**
Mount the **upper roller for internal door**, keeping the adjusting screw towards the internal part of the door.

SYSTEM INSTALLATION

Lower Rollers

Install the Lower rollers for both internal and external door panels:

- **internal door panels**

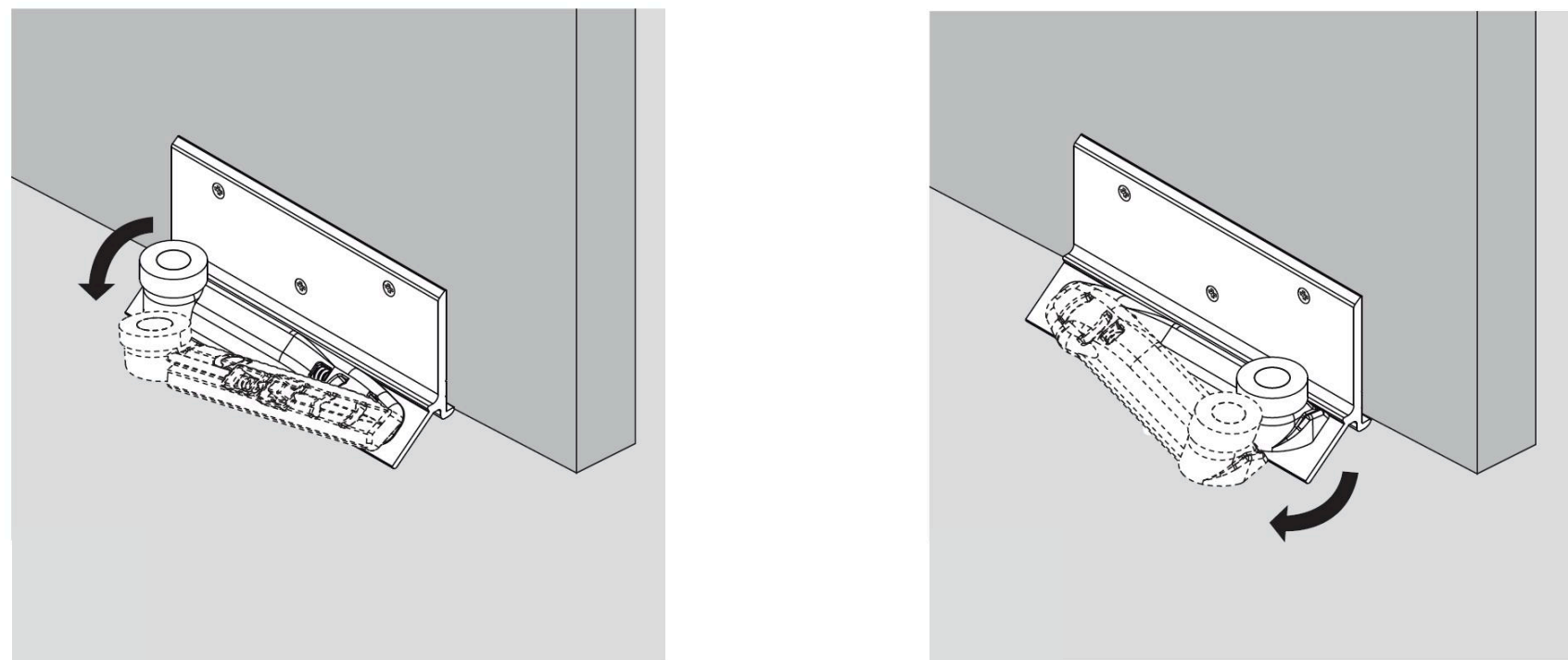

Mount the **left and right lower rollers** for the **internal door**, with the adjustment screw facing outward. Rotate the arms outward to open.

- **external door panels**

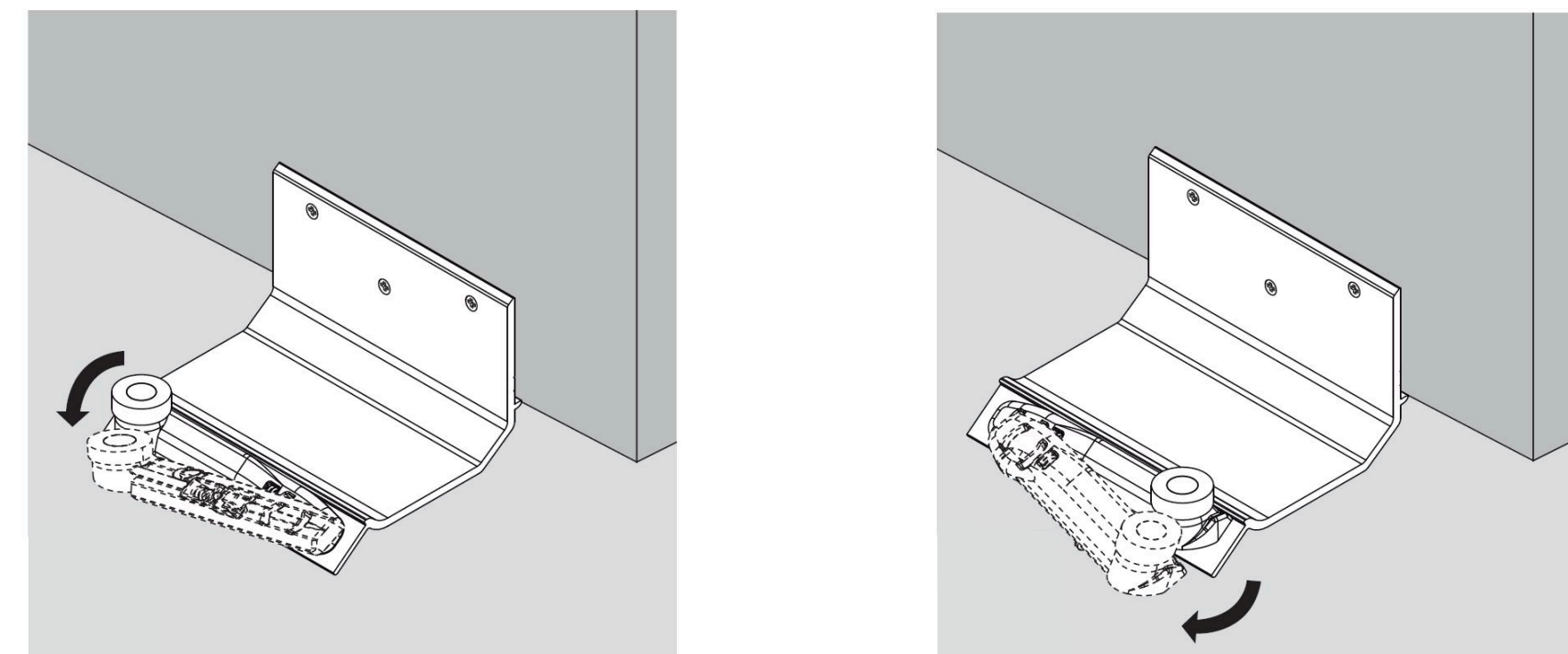

Mount the **left and right lower rollers** for the **external door**, with the adjustment screw facing outward. Rotate the arms outward to open.

SYSTEM INSTALLATION

Activators on Rollers

Install the Activators for both internal and external door panels:

- internal door

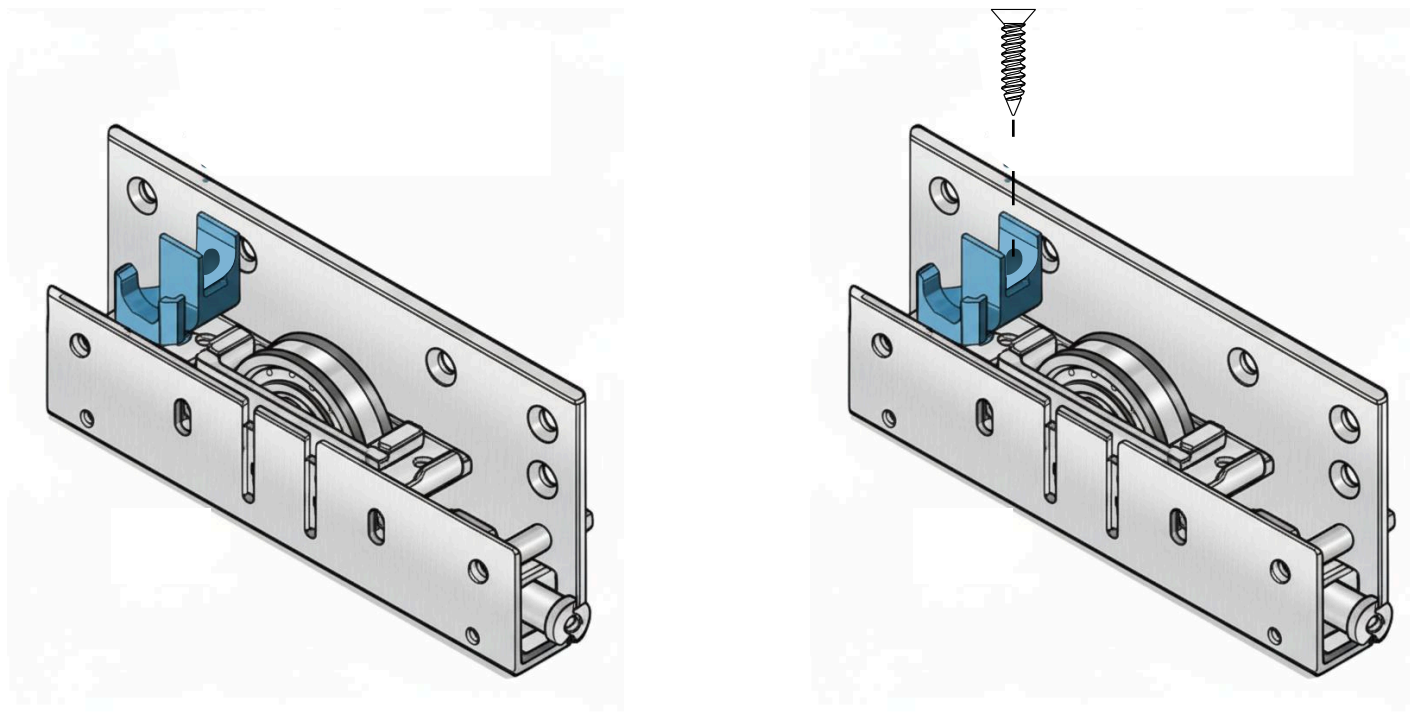

Put the **activator** in the **seat on the wheel roller** for the internal door, and screw it.

- external door

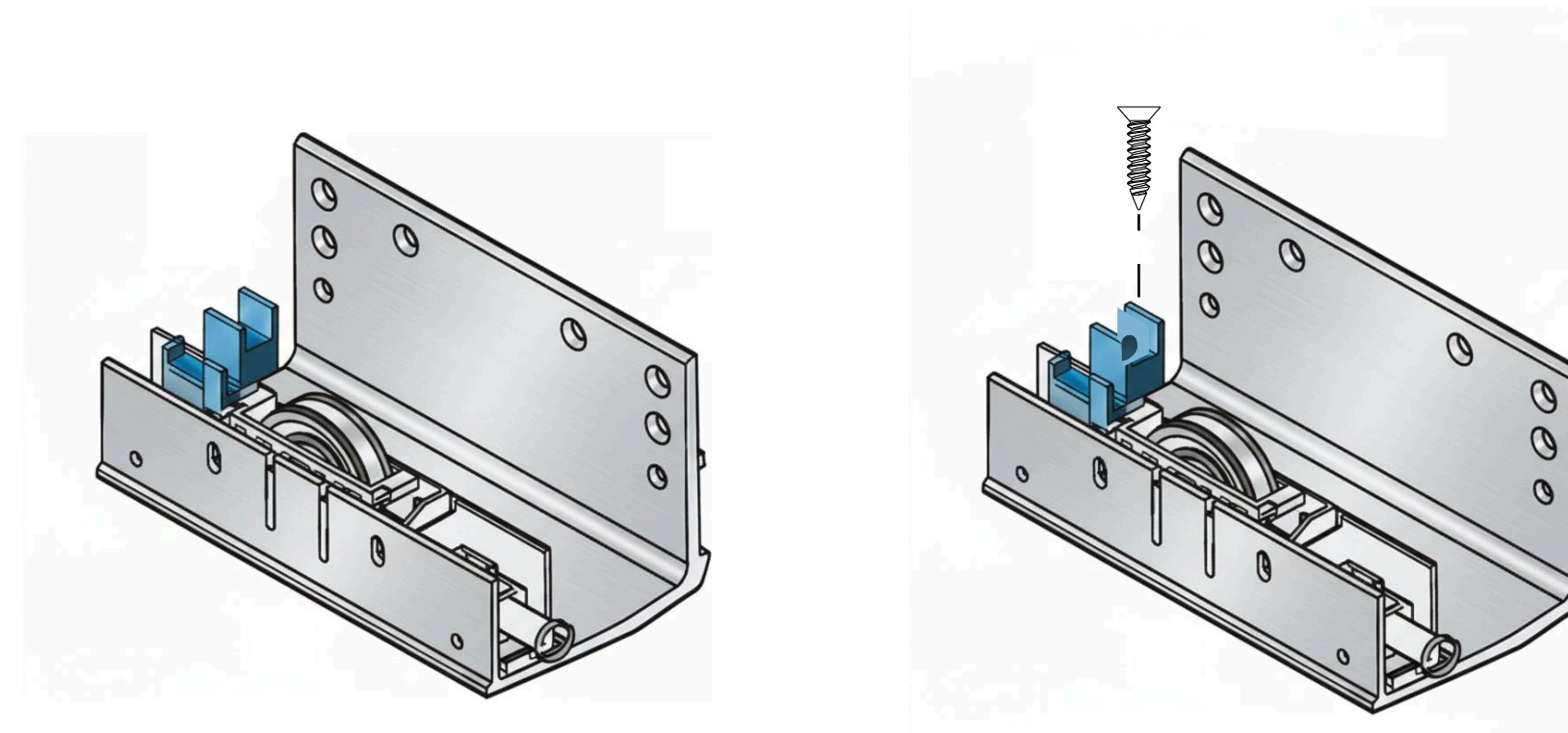

Put the **activator** in the **seat on the wheel roller** for the external door, and screw it.

SYSTEM INSTALLATION

Shutters installation

- Installation of the sliding shutters.

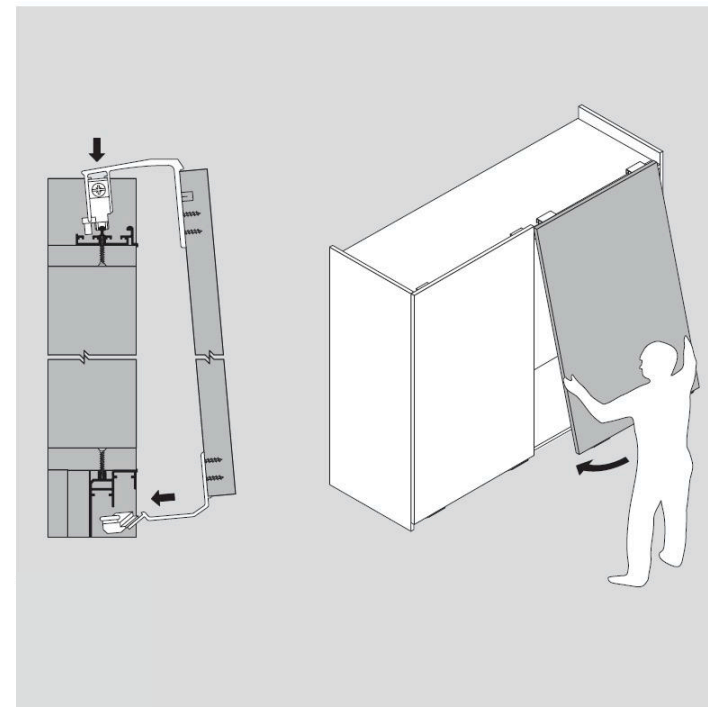
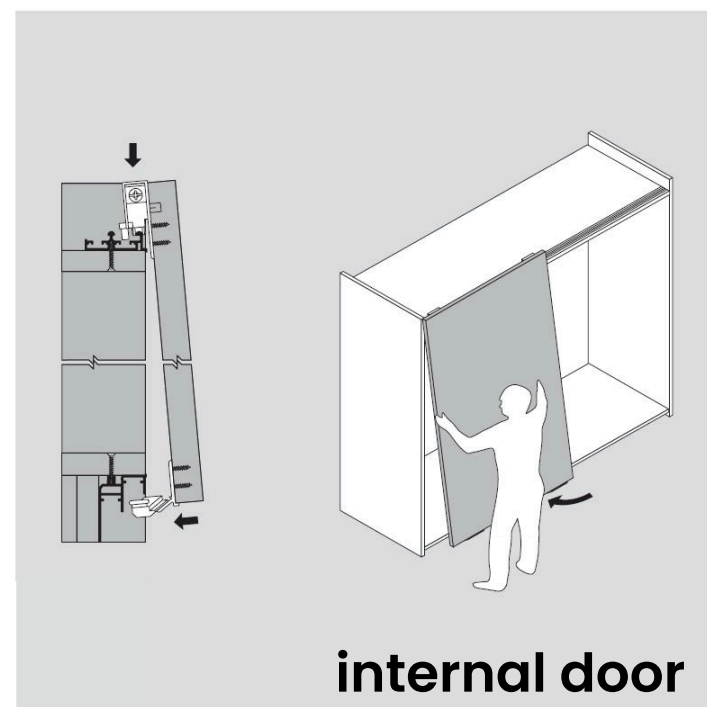

Mount the **internal** and **external** door on the **upper rail**, until the roller run correctly on the rail.

Press lightly the **lower part** on the rail until you hear the hook.

- Alignment and adjustment.

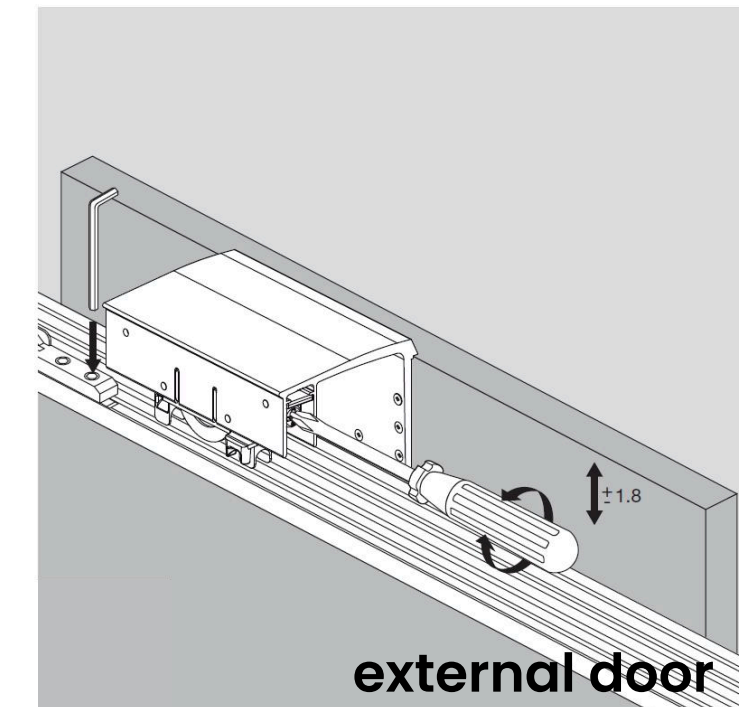
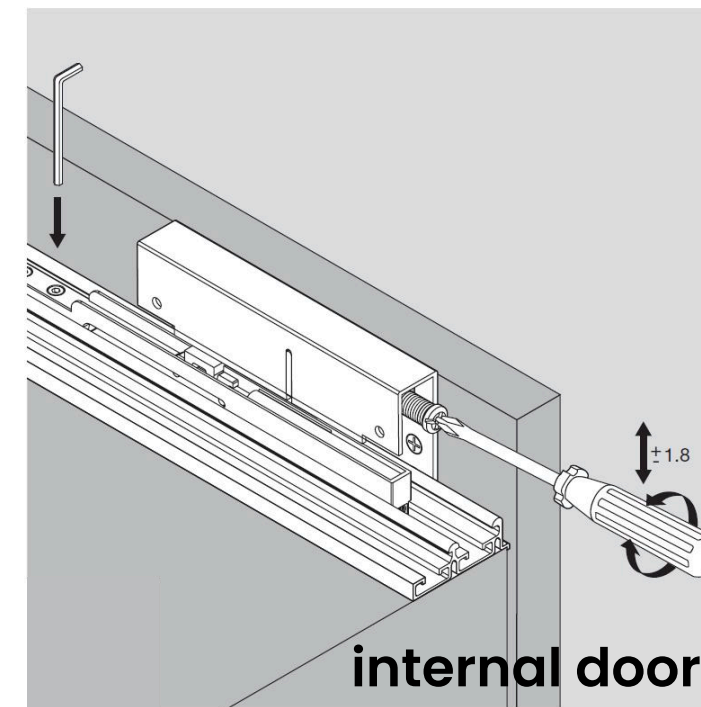

Move the **soft stopper** through the **right position** and **fix it**.

Adjust the **internal** and **external door** vertically with screwdriver.

SLIDING DOOR OPTIONS

2 Door Configuration

The drawings define the required **shutter dimensions**, the **overlap between doors**, and the **activator position** for a **two-door closet** with **soft-opening** and **soft-closing** systems.

Note: W=Outside Width

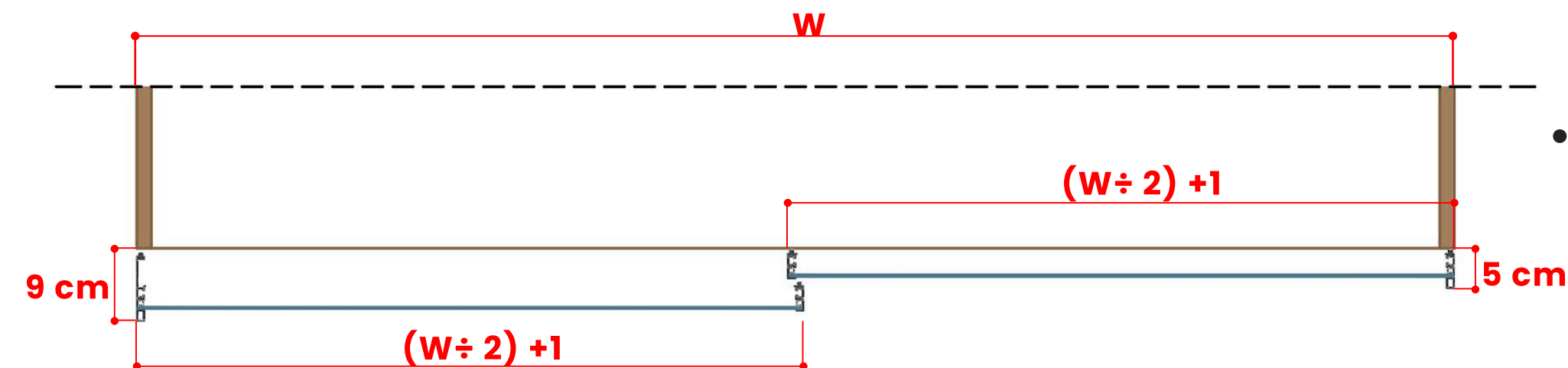

• **Plan View:** Shutters With Dimensions

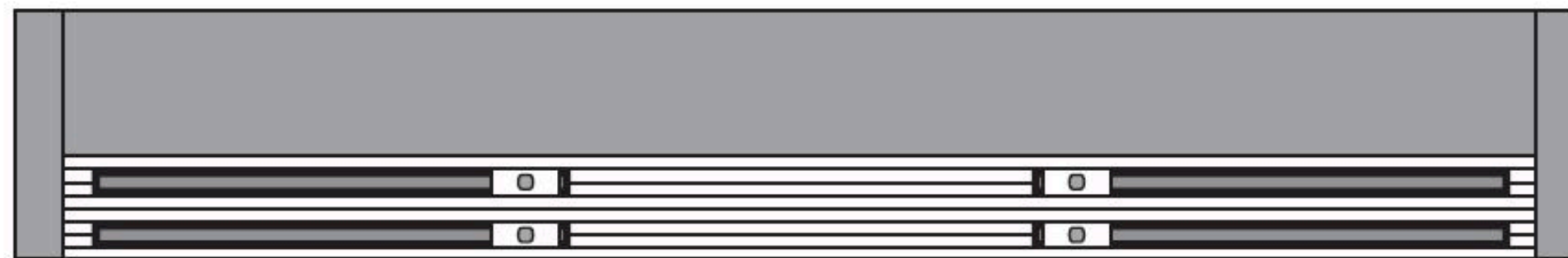

• **Plan View:** Upper Rail With Adapters

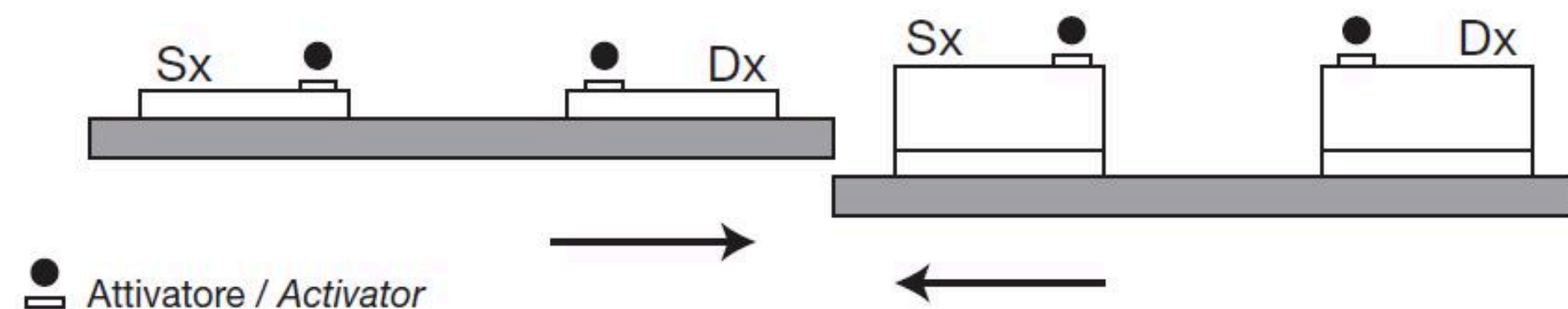

● Attivatore / Activator

SLIDING DOOR OPTIONS

3 Door Configuration

The drawings define the required **shutter dimensions**, the **overlap between doors**, and the **activator position** for a **three-door closet** with **soft-opening** and **soft-closing** systems.

Note: W = Outside Width

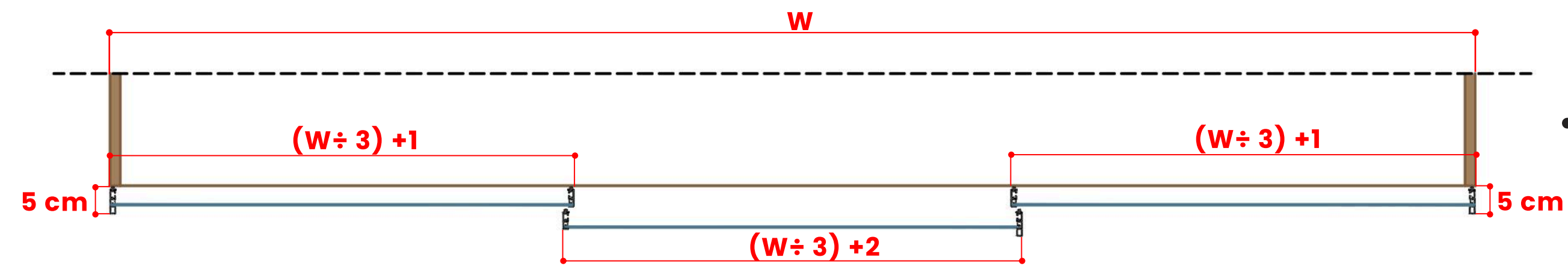

• **Plan View:** Shutters With Dimensions

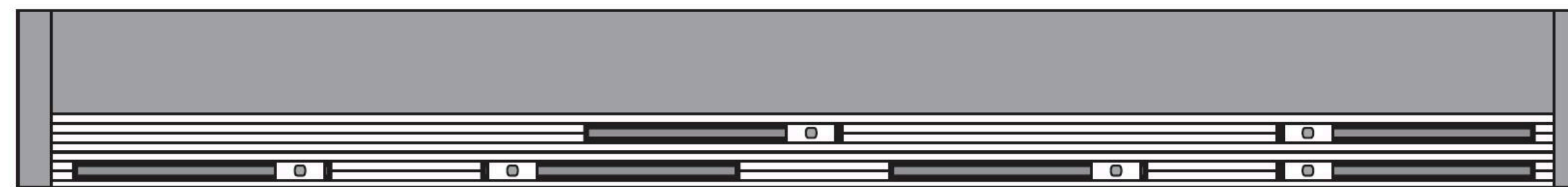

• **Plan View:** Upper Rail With Adapters

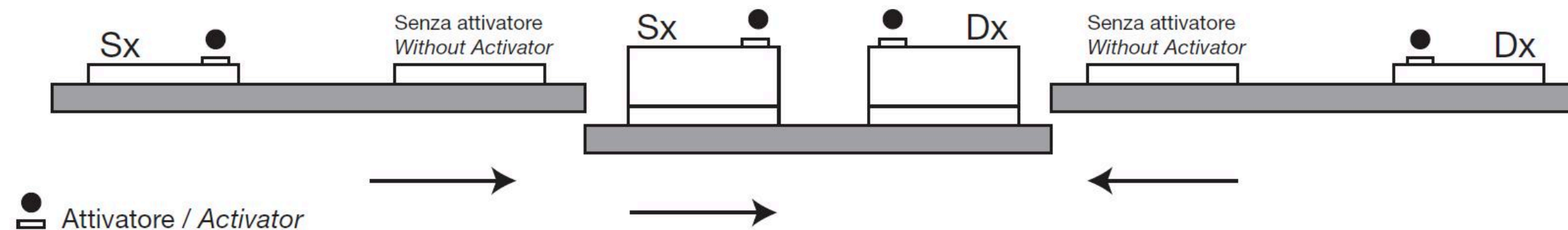

SLIDING DOOR OPTIONS

4 Door Configuration

The drawings define the required **shutter dimensions**, the **overlap between doors**, and the **activator position** for a **four-door closet** with **soft-opening** and **soft-closing** systems.

Note: W=Outside Width

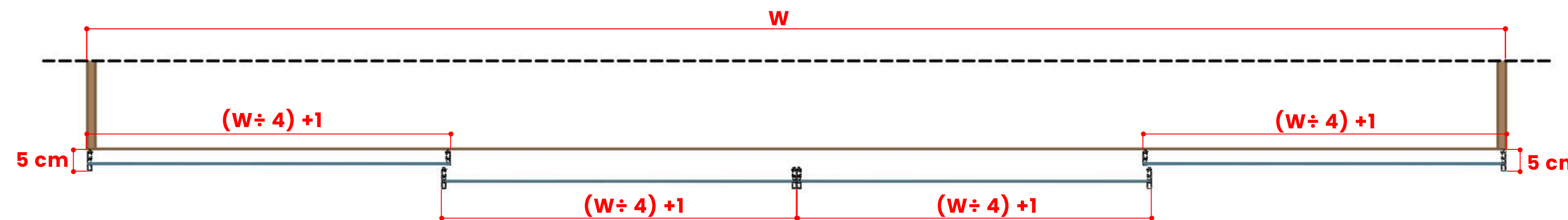

- **Plan View:** Upper Rail With Adapters



- **Plan View:** Upper Rail With Adapters

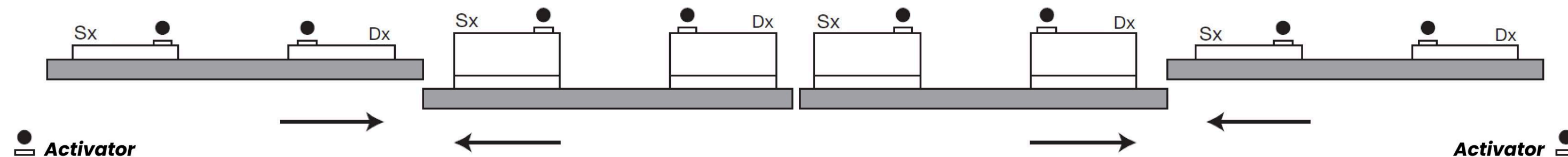

SLIDING DOOR OPTIONS

Dimensions

Elevation and **section** views show the required clearances, rail positions, and total height for accurate installation and smooth door operation.

NOTE: The base leg should be at least 6 cm high and can be made higher if needed.

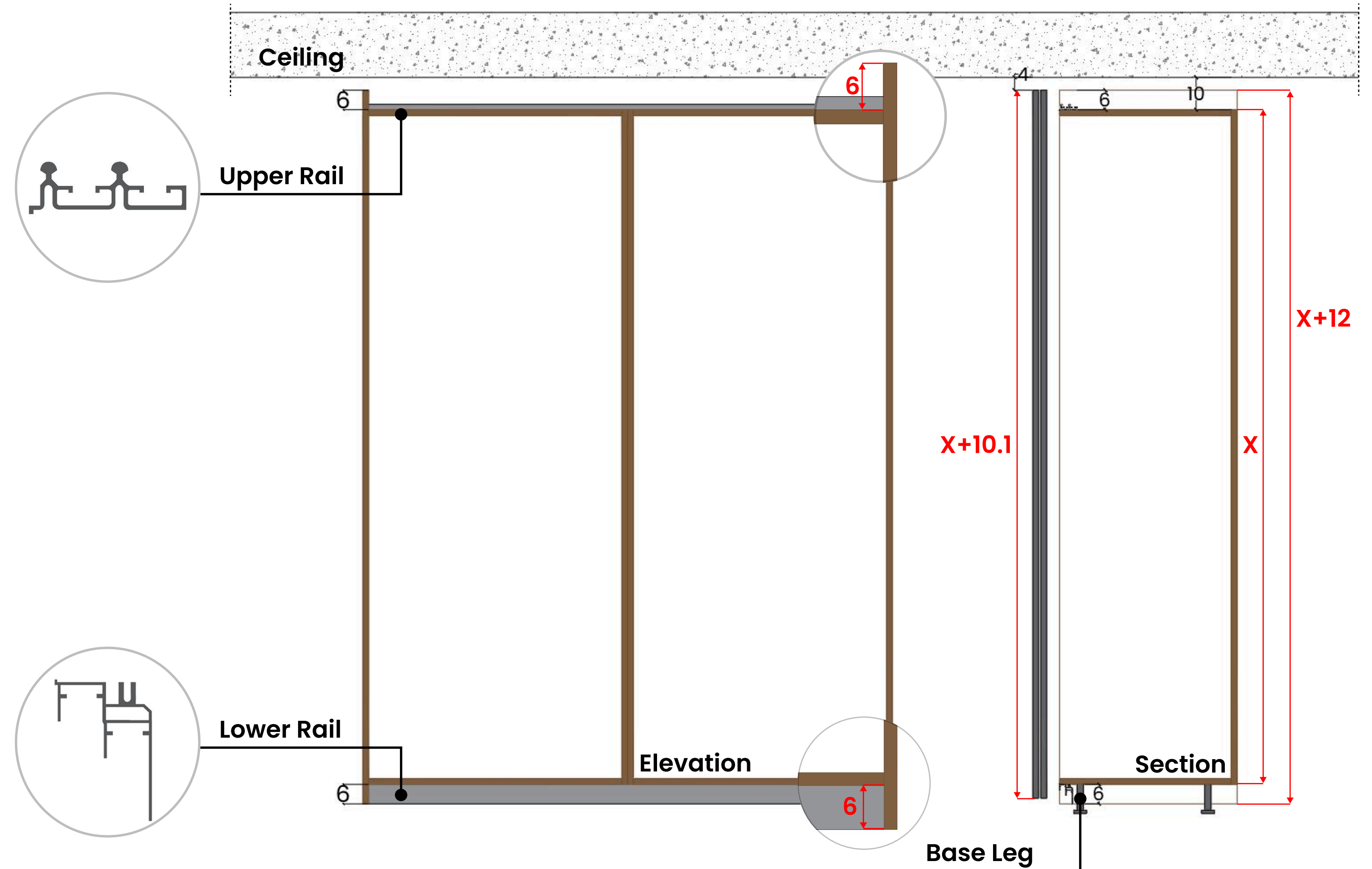

SHUTTER OPTIONS

Shutter Types

Two shutter options are available:

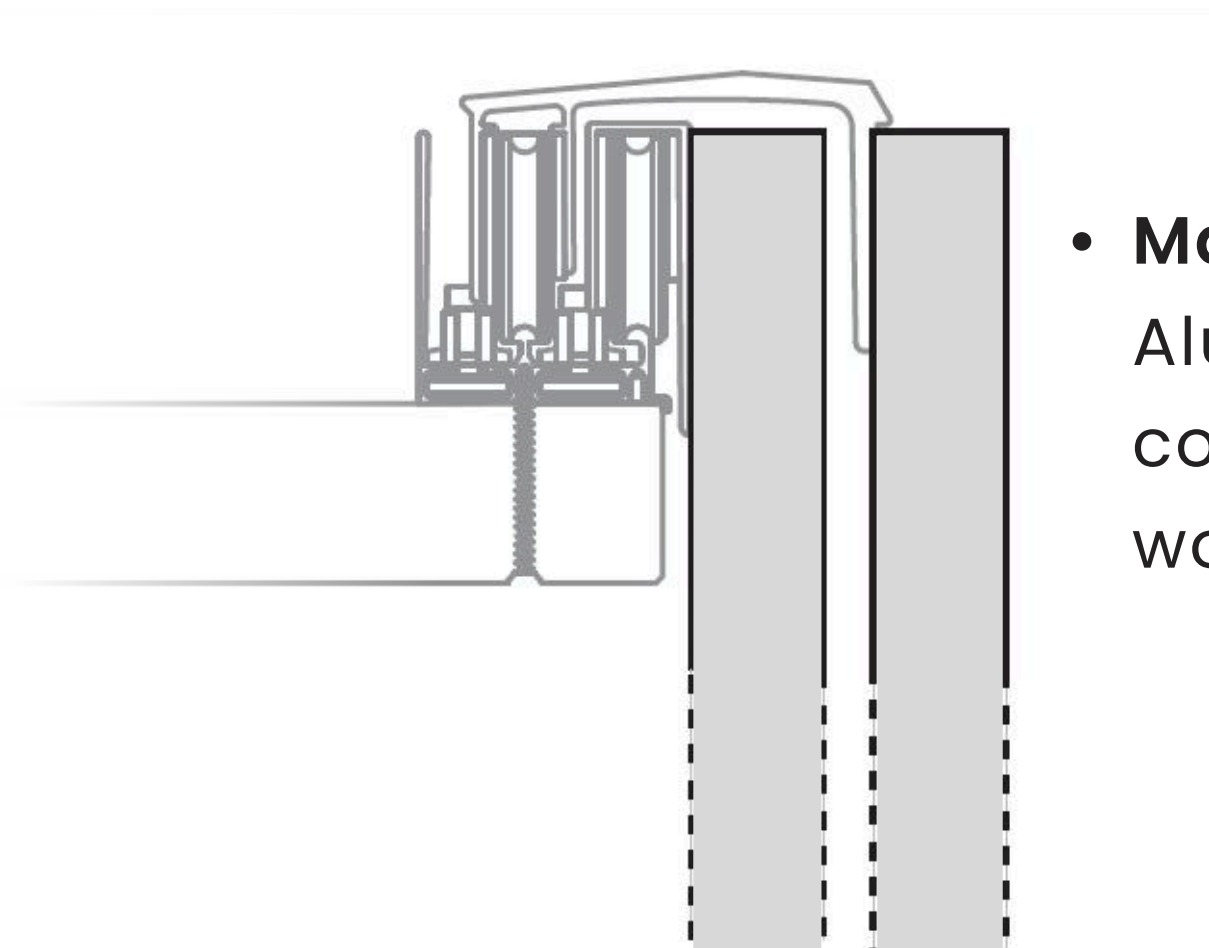

- **Manhattan Shutters:** Aluminum profiles compatible with either wood or glass panels.

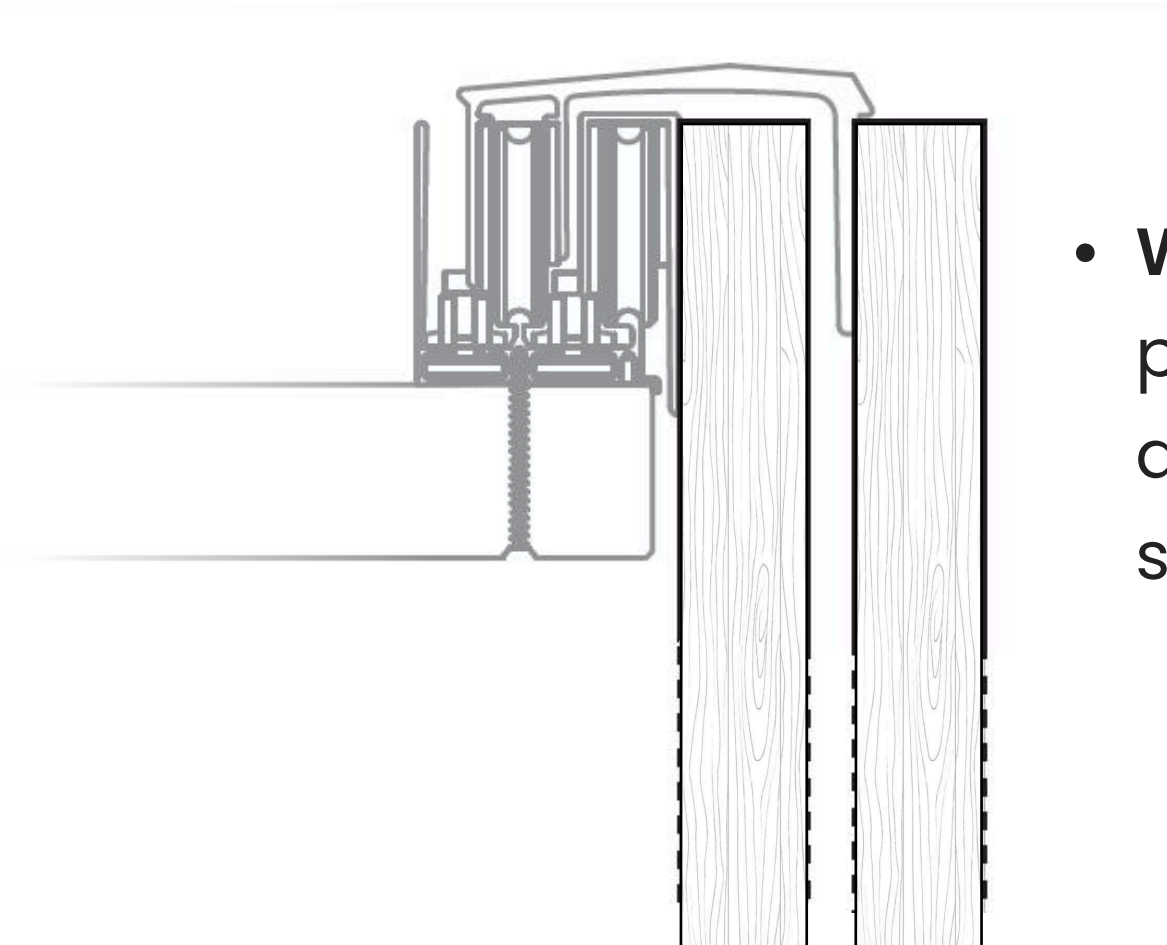

- **Wood Shutters:** Solid wood panels designed to fit directly into the roller system.

MANHATTAN SHUTTERS

Shutter Types

Manhattan Shutters – Aluminum profiles compatible with either wood panels or 4 mm glass, fitted with rubber gaskets for secure installation.

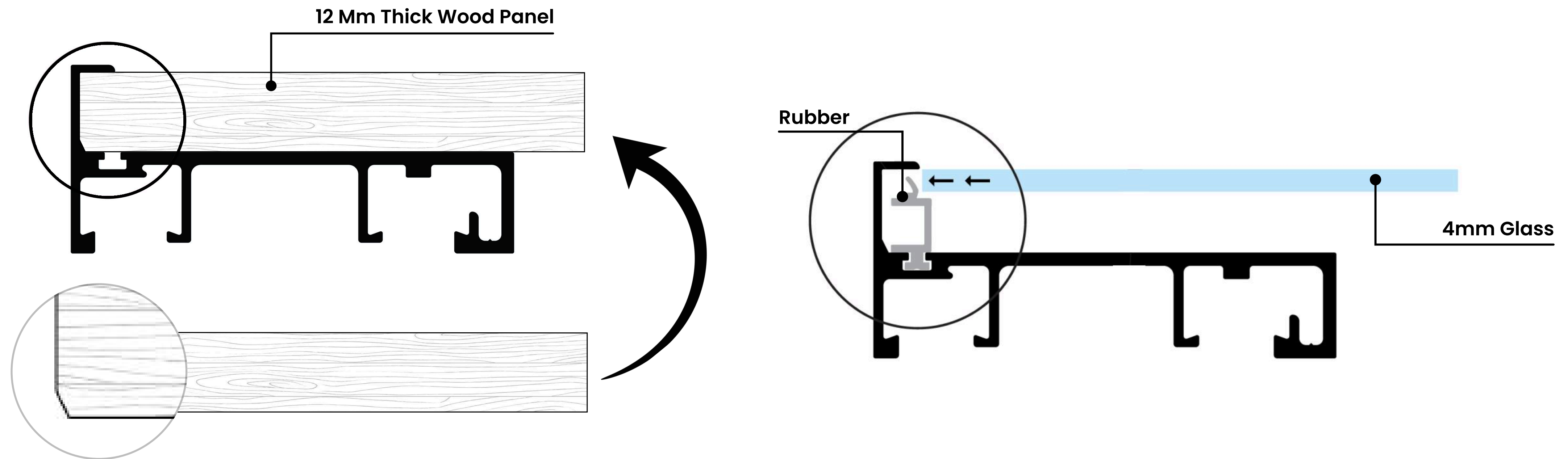

MANHATTAN SHUTTERS

Options

Handles Options:

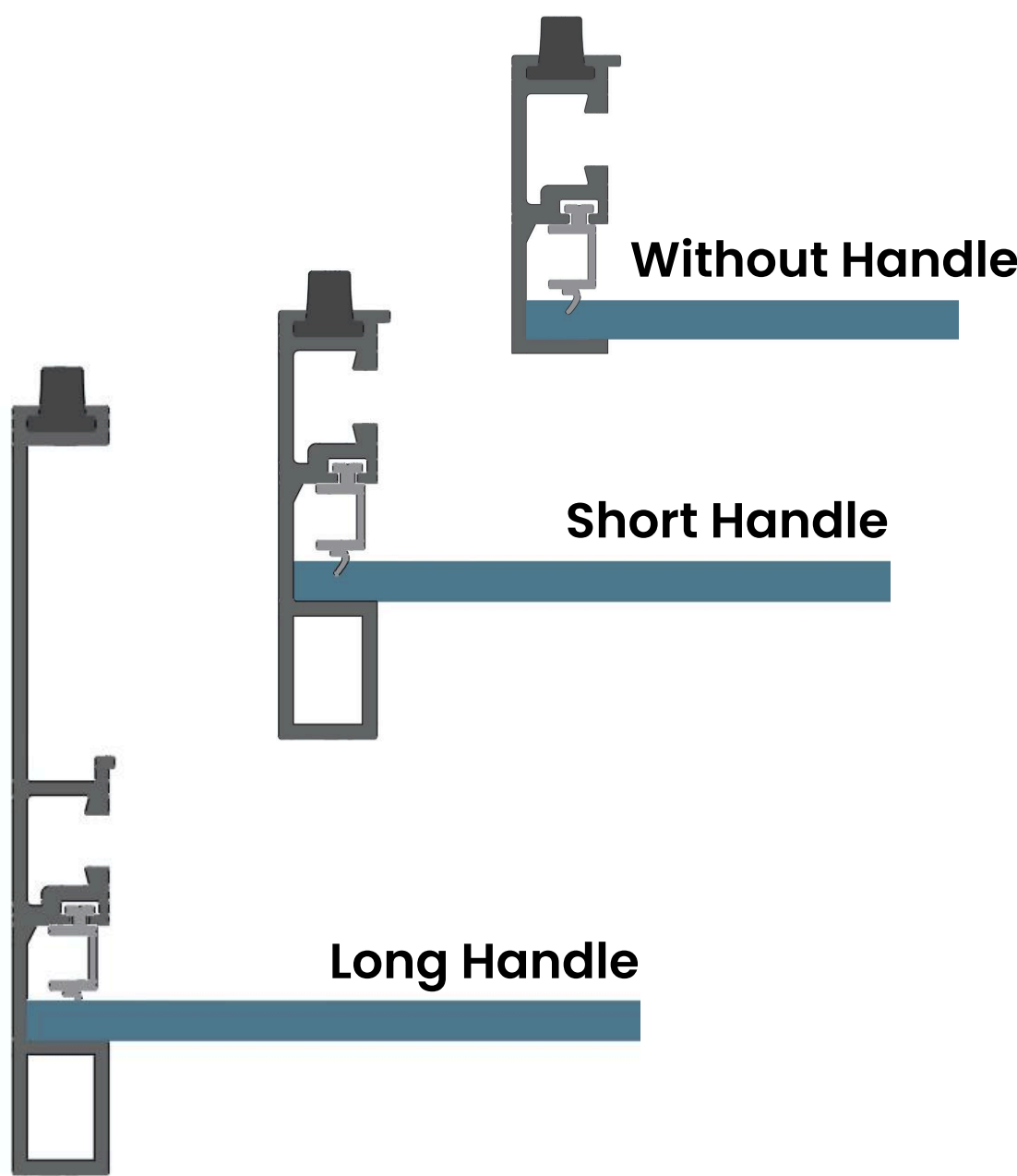

Colors Options:



Glass Options:

Fumé	Bronze	Clear
White Mirror	Bronze Mirror	Black Mirror
Ribbed	Back Painted Black	Back Painted White
Reflective Bronze	Reflective Black	
Frosted	Frosted Ribbed	

MANHATTAN SHUTTERS

Plate Details

- Place the **plates** in the **upper profiles (upper plate)** and **lower profiles (lower plate)** and fix with screws.
- Upper and lower plates **are supplied loose** and can be **fixed** by the client **along the shutter track**, according to project requirements.
- Fix the plates to the profile by screwing **through the indicated holes**.

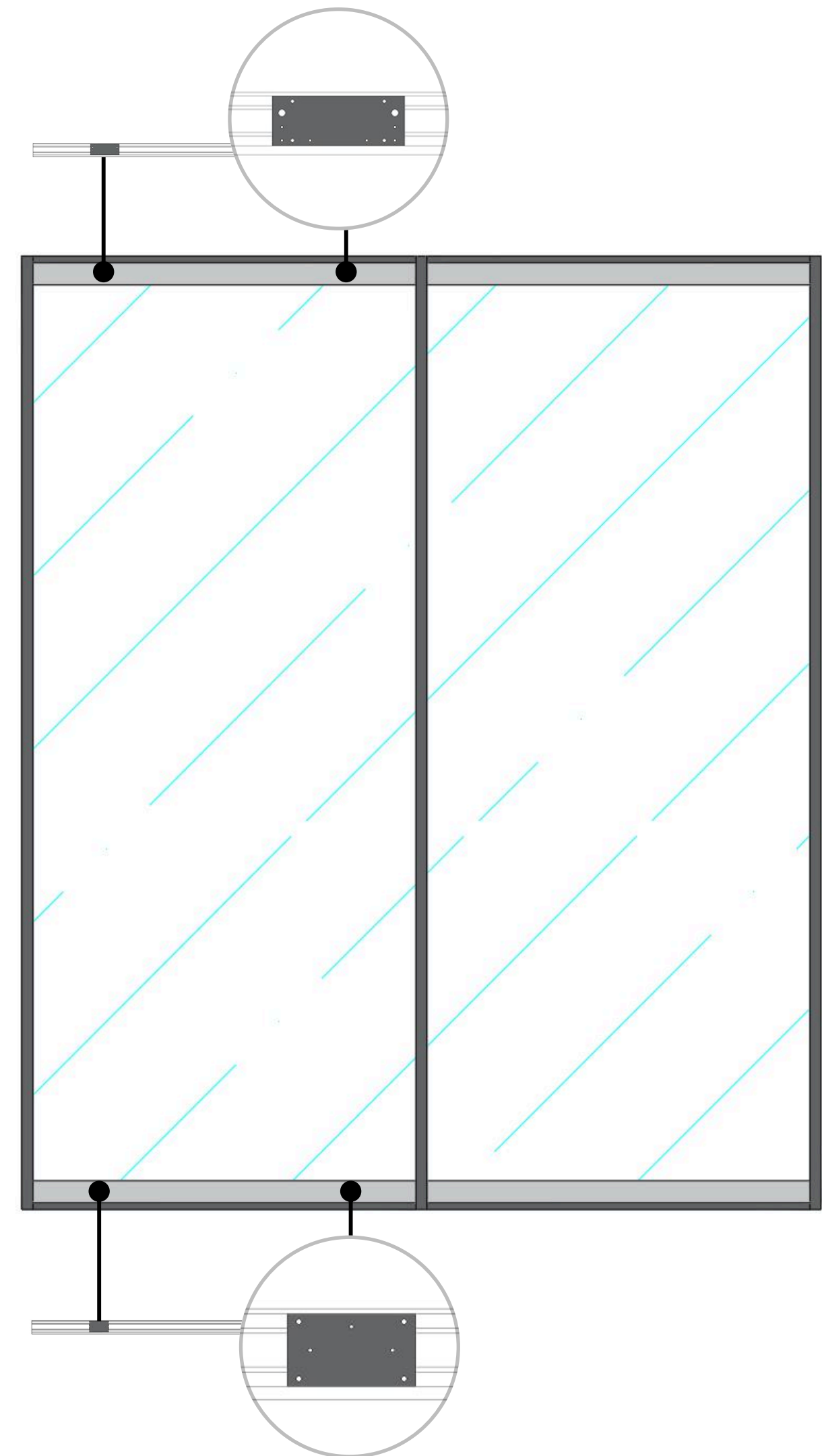
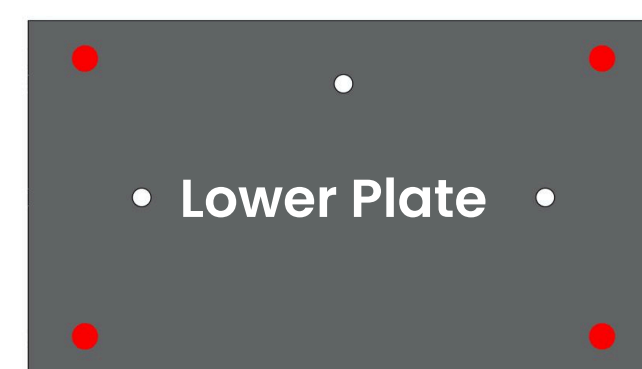
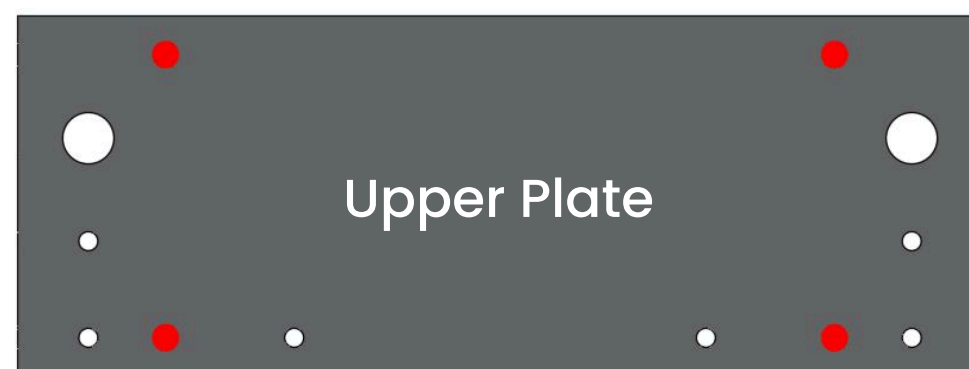

MANHATTAN SHUTTERS

Partition Details

Shutter Partitions

Different partition options are available to customize the shutter design:

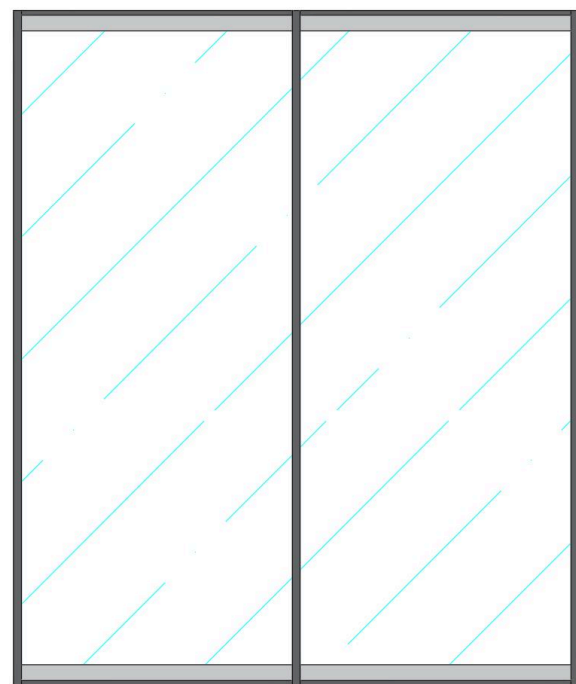

- **Invisible Mid-Profile:**
Gives a smooth and seamless shutter surface.

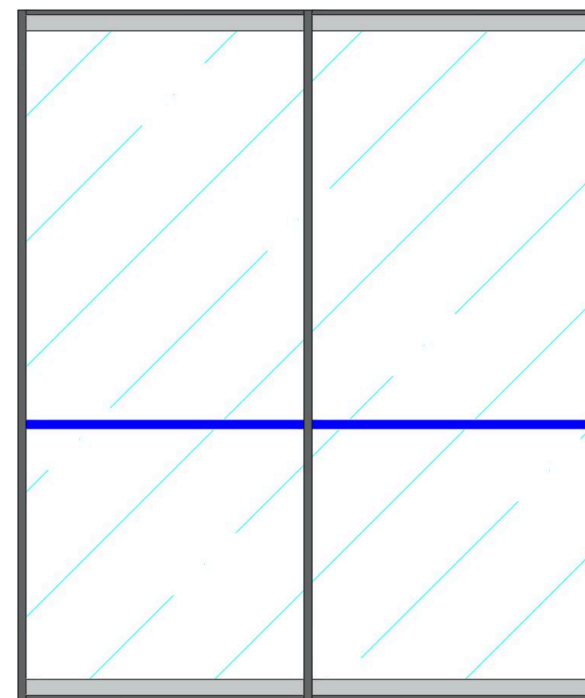

- **Visible Mid-Profile:**
Adds a horizontal division line for aesthetic purpose.

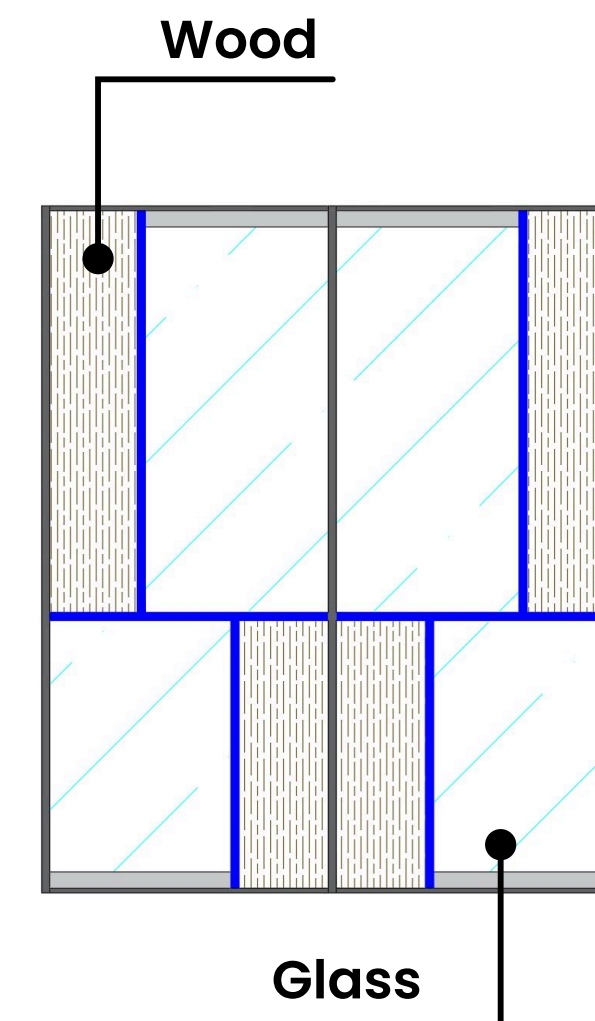

- **Partitions Mid-Profile:**
Enables divisions (glass and wood), for multi-panel shutters.



NATHALIUM
Elevating Spaces with Italian Precision



Closets

Nathalium .Co

Jamal Abdul Nasser Str. – Al Bahsas – Tripoli, Lebanon

Tel: 06/411790 , 06/411 791 – cell: 71/847529

www.nathalium.com – info@nathalium.com

