



ATHALIU

Elevating Spaces with Italian Precision

BED SYSTEM

ABAIN
MADE IN SPAIN

HORIZONTAL WALLBED

TABLE OF CONTENT

| | | |
|-----------|-------------------------|----|
| 01 | Introduction | 03 |
| 02 | Materials & Tools | |
| | Main Components | 05 |
| 03 | System Structure | |
| | Components | 06 |
| | Measurements | 07 |
| | Gaz Lift Strength | 08 |
| | Assembly Overview | 09 |

| | | |
|-----------|-----------------------------------|-------|
| 04 | System Installation | |
| | Lateral Plates | 10-11 |
| | Interface Plate | 12-13 |
| | Gaz Lifts | 14-15 |
| | Hook Installation | 16 |
| | Legs Support | 17 |
| 05 | Operating sequence | |
| | Smooth Lowering With Support | 18 |

INTRODUCTION

The Abain Horizontal Wallbed System is a functional space-saving solution designed for efficient and safe use. This catalogue outlines the system operation, key components, accurate dimensions, and step-by-step installation guidelines to ensure proper performance and durability.

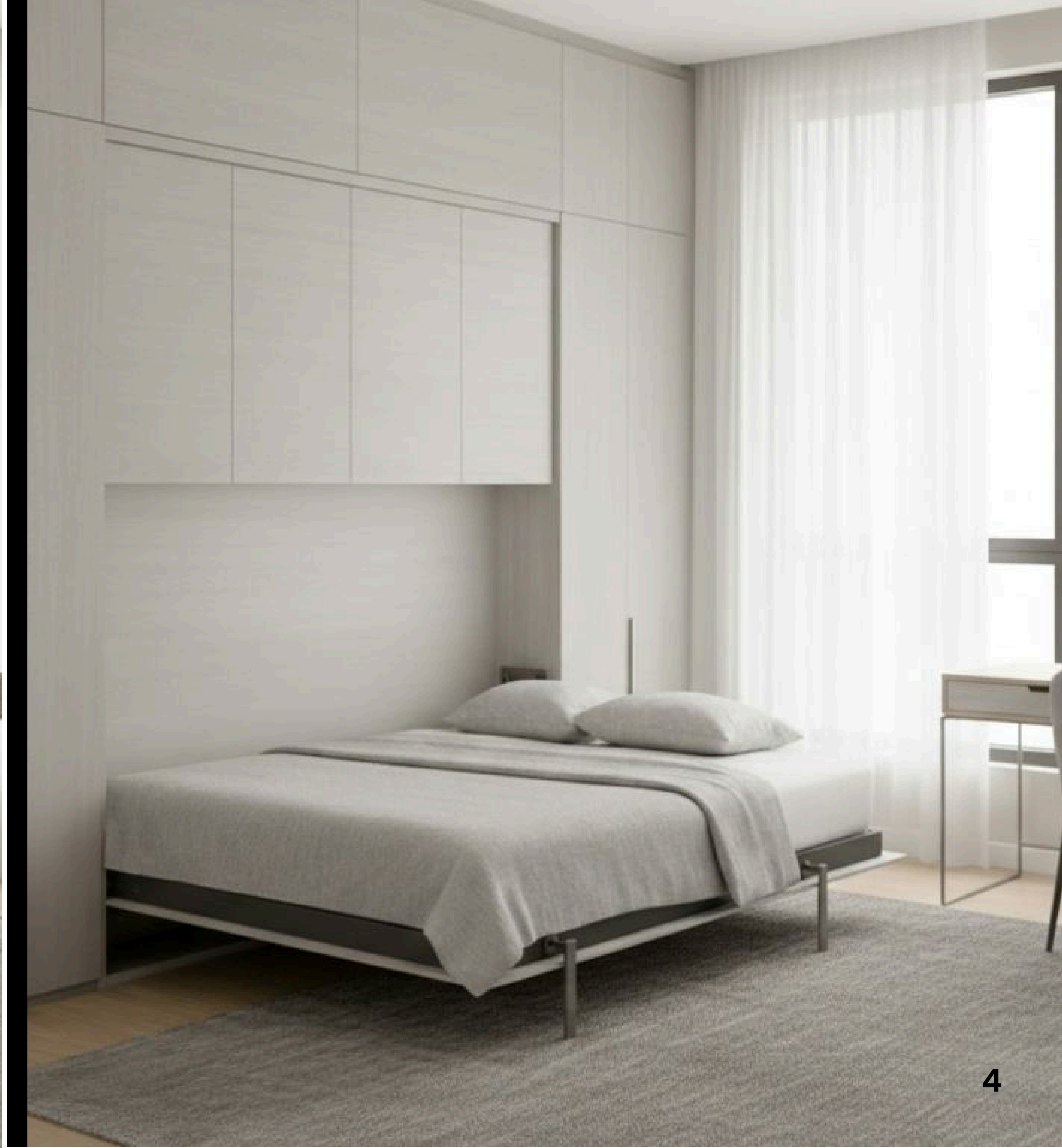

MATERIALS & TOOLS

Main Components

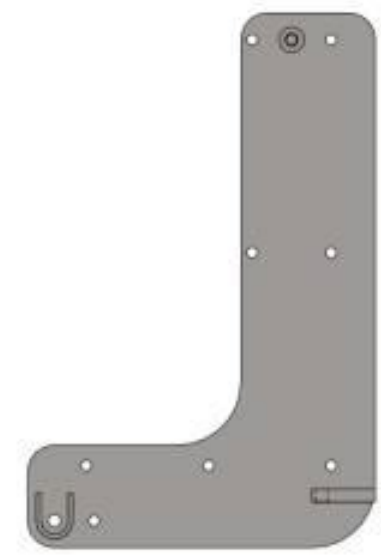

• Left Plate

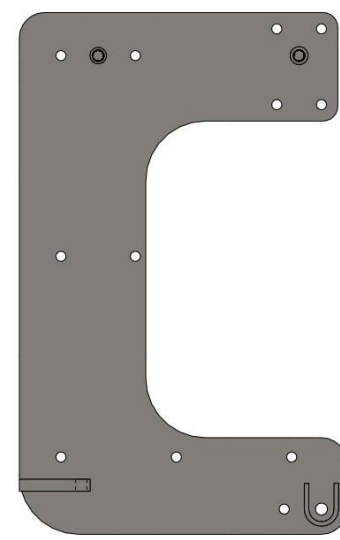

• Right Plate



• Hook



• Gaz Lifts

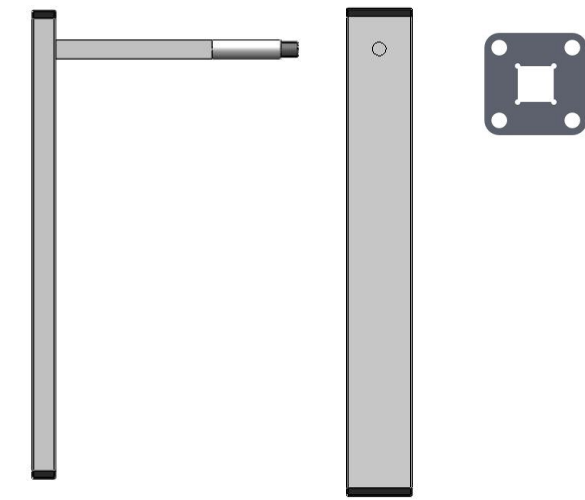

• Legs Support

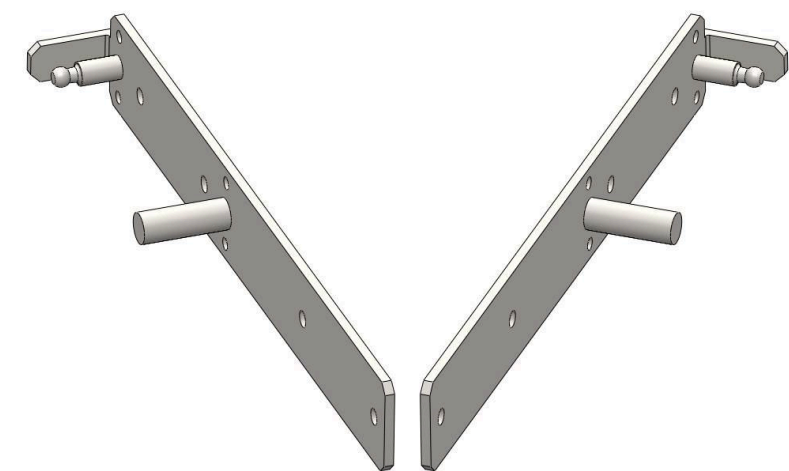

• Interface Plate

SYSTEM STRUCTURE

Components

The illustration presents the complete **horizontal wall bed system**. The annotated drawing identifies all **key components** and provides a clear understanding of the system structure and operation.

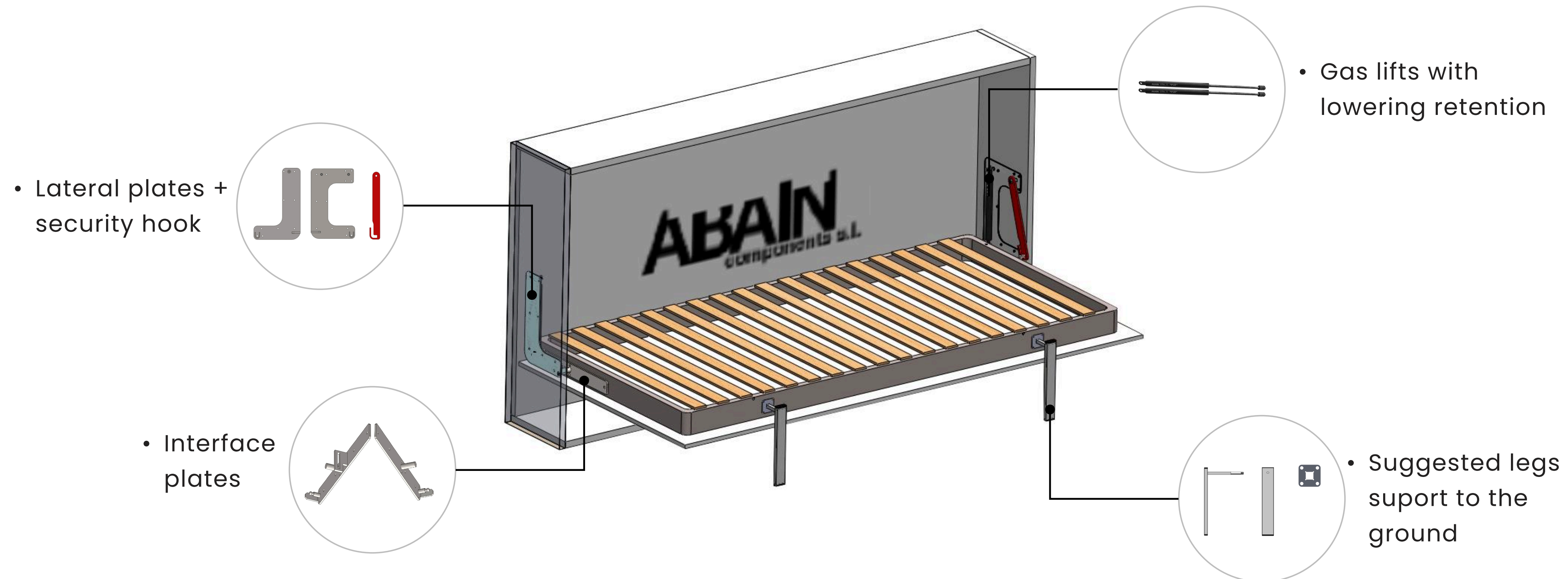

SYSTEM STRUCTURE

Measurements

Inner measurements resulting from **the final cabinet**, regardless of thickness of the boards.

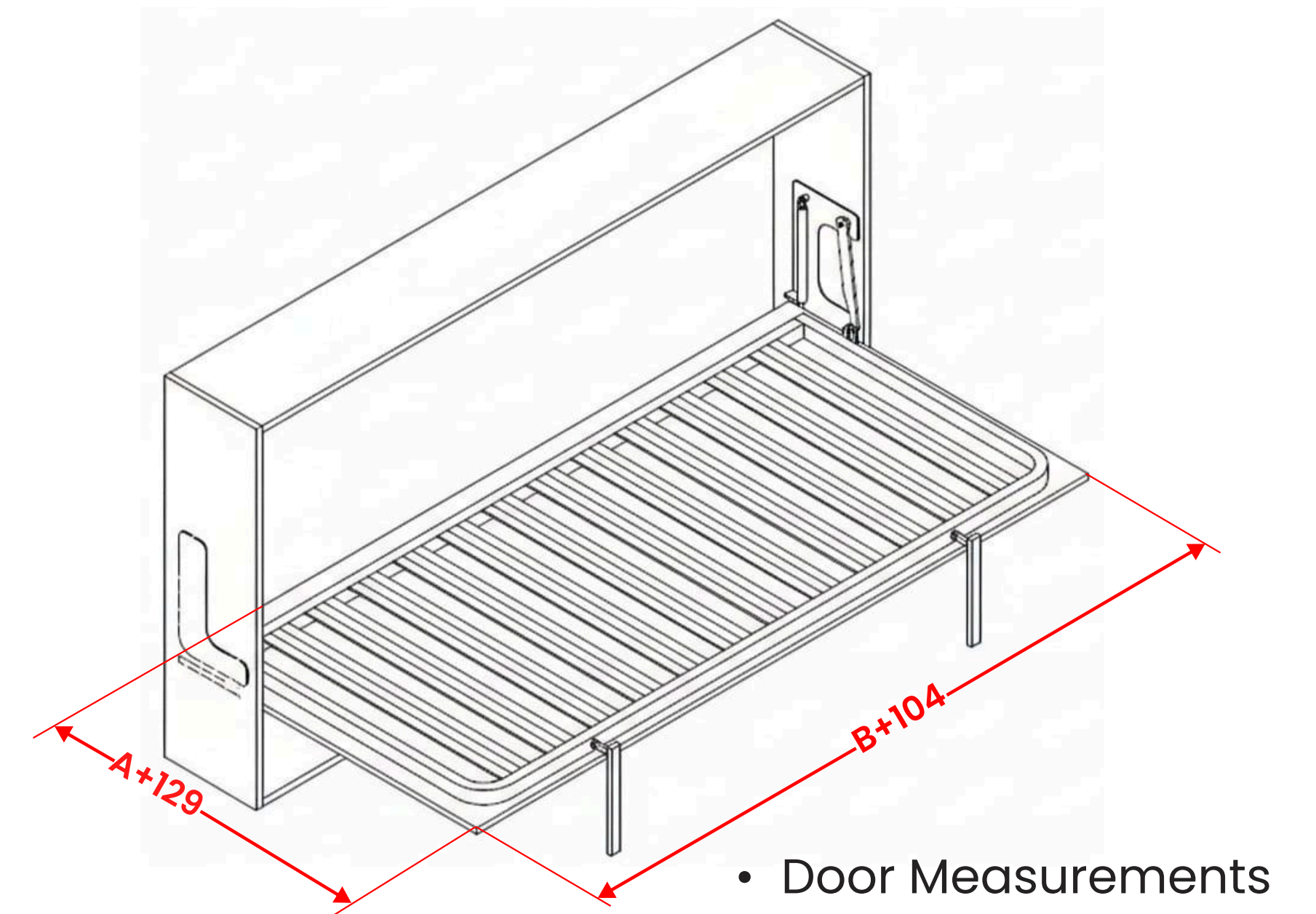
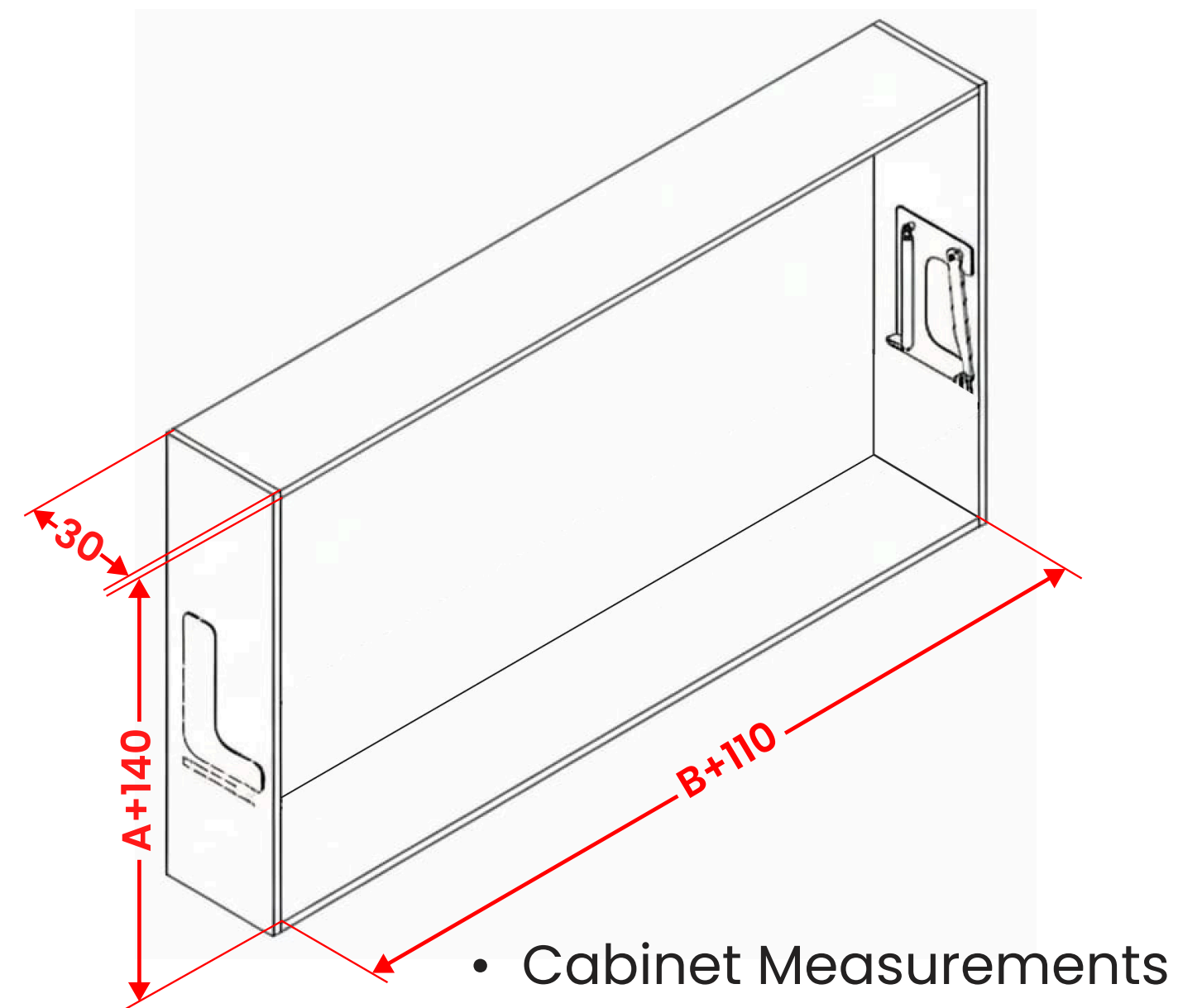
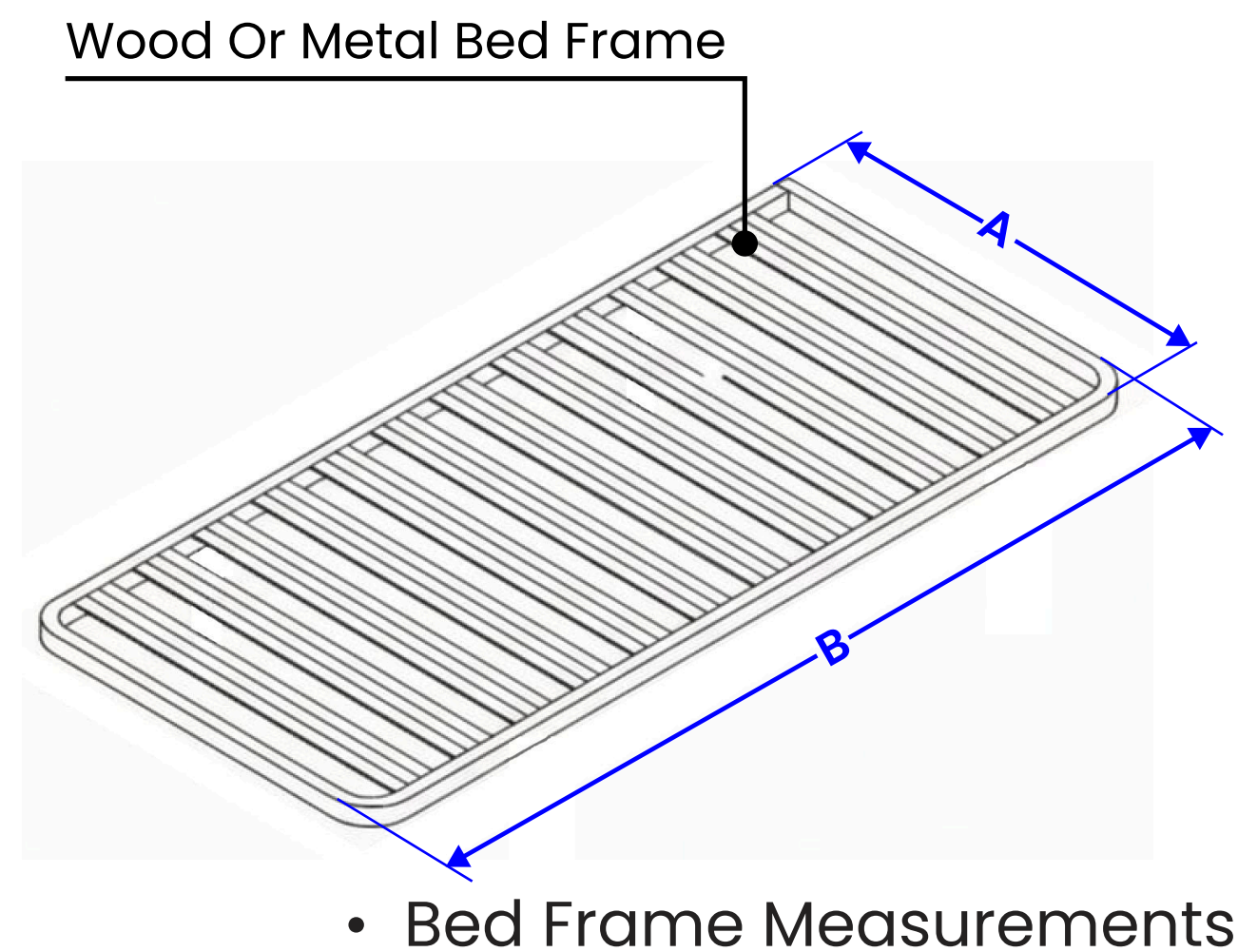

SYSTEM STRUCTURE

Gaz Lift Strength

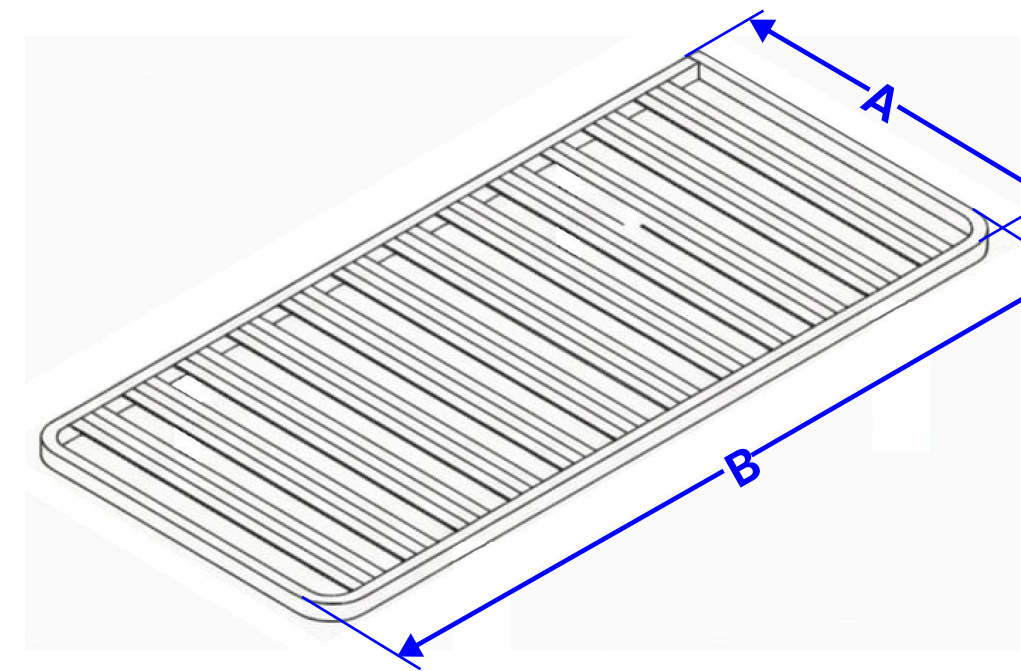

| A | B | Gaz lift strength |
|------|------|-------------------|
| 800 | 1800 | 200 N |
| 800 | 1900 | 200 N |
| 800 | 2000 | 200 N |
| 900 | 1800 | 200 N |
| 900 | 1900 | 200 N |
| 900 | 2000 | 200 N |
| 1000 | 1800 | 300 N |
| 1000 | 1900 | 300 N |
| 1000 | 2000 | 300 N |

| A | B | Gaz lift strength |
|------|------|-------------------|
| 1050 | 1800 | 300 N |
| 1050 | 1900 | 300 N |
| 1050 | 2000 | 300 N |
| 1200 | 1800 | 500 N |
| 1200 | 1900 | 500 N |
| 1200 | 2000 | 500 N |
| 1350 | 1800 | 700 N |
| 1350 | 1900 | 700 N |
| 1350 | 2000 | 700 N |

| A | B | Gaz lift strength |
|------|------|-------------------|
| 1400 | 1800 | 700 N |
| 1400 | 1900 | 700 N |
| 1400 | 2000 | 700 N |
| 1500 | 1800 | 800 N |
| 1500 | 1900 | 800 N |
| 1500 | 2000 | 800 N |
| 1600 | 1800 | 900 N |
| 1600 | 1900 | 900 N |
| 1600 | 2000 | 900 N |

SYSTEM STRUCTURE

Assembly overview

- The **exploded 3D illustration** shows the **general assembly** of the wall bed system.
- It presents the **main components separated** to clarify their position and connection.
- Detailed explanations of each component are provided in the following pages.

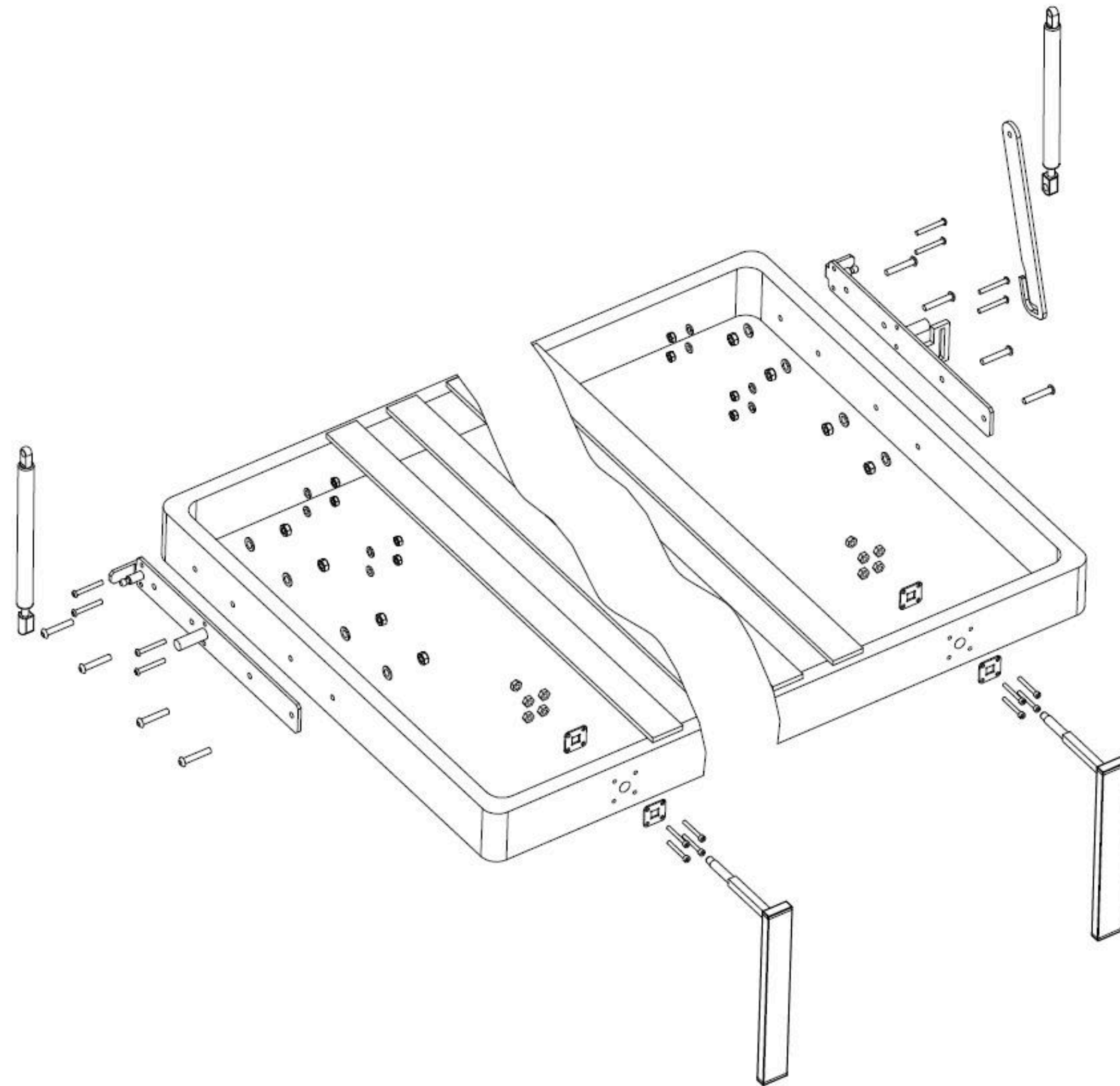

SYSTEM INSTALLATION

Lateral Plates

1. With the non-assembled cabinet, the metal plates are mounted inside of the side panels.

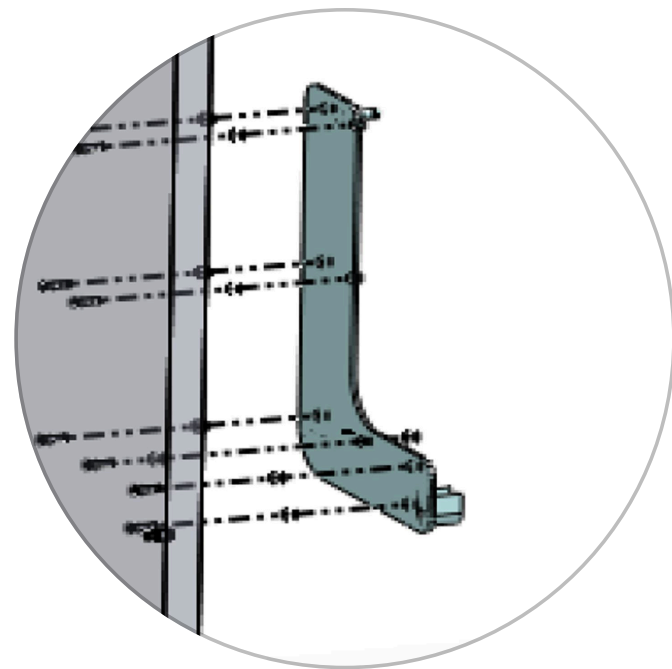

Left Plate

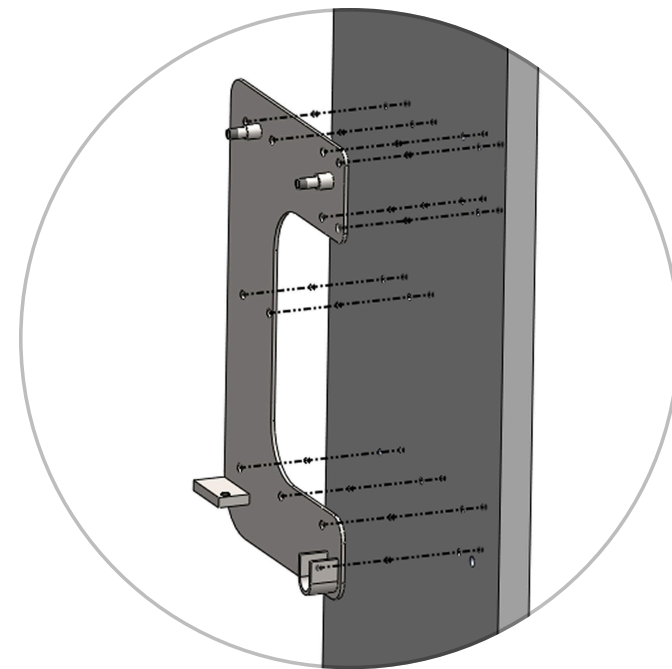

Right Plate

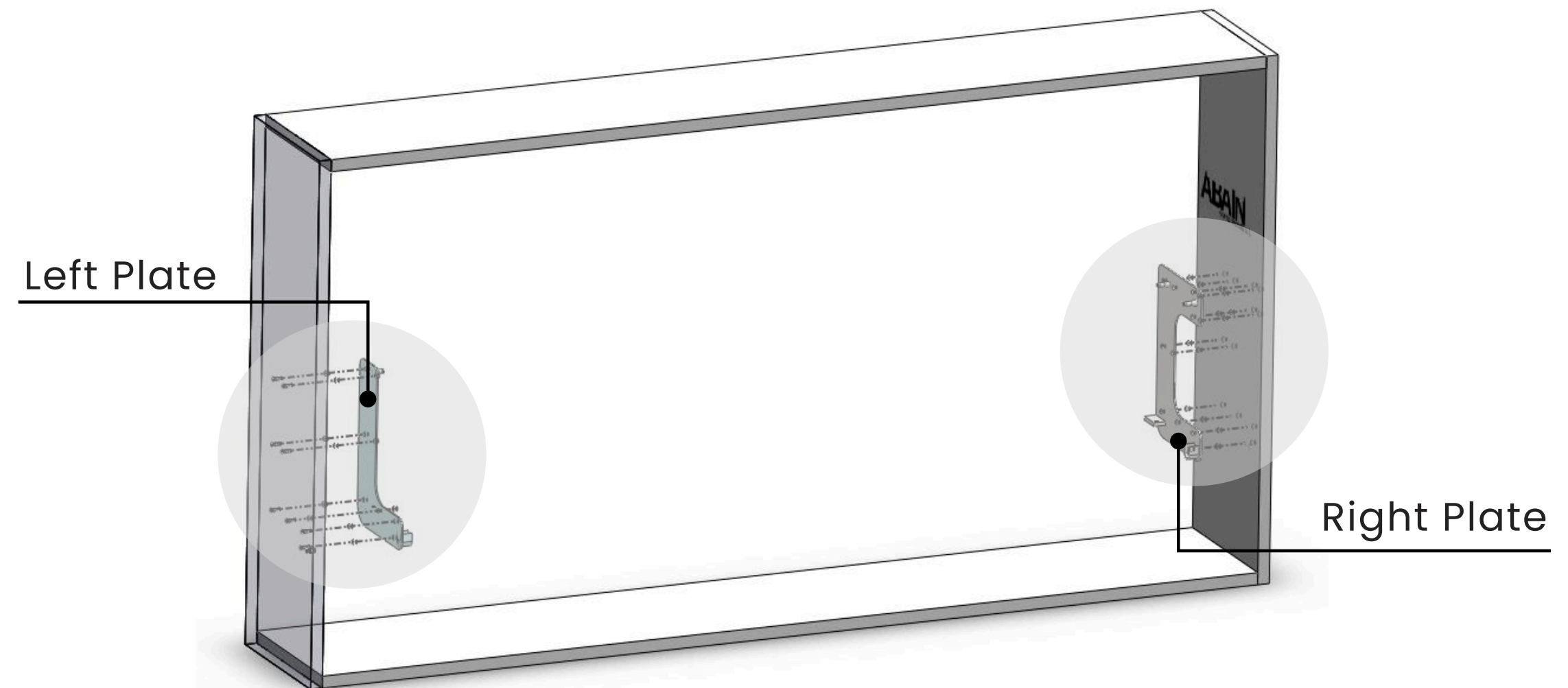

SYSTEM INSTALLATION

Lateral Plates

The point of origin is the pivot point, **270mm from the floor** and **20mm from the inside of the door**.

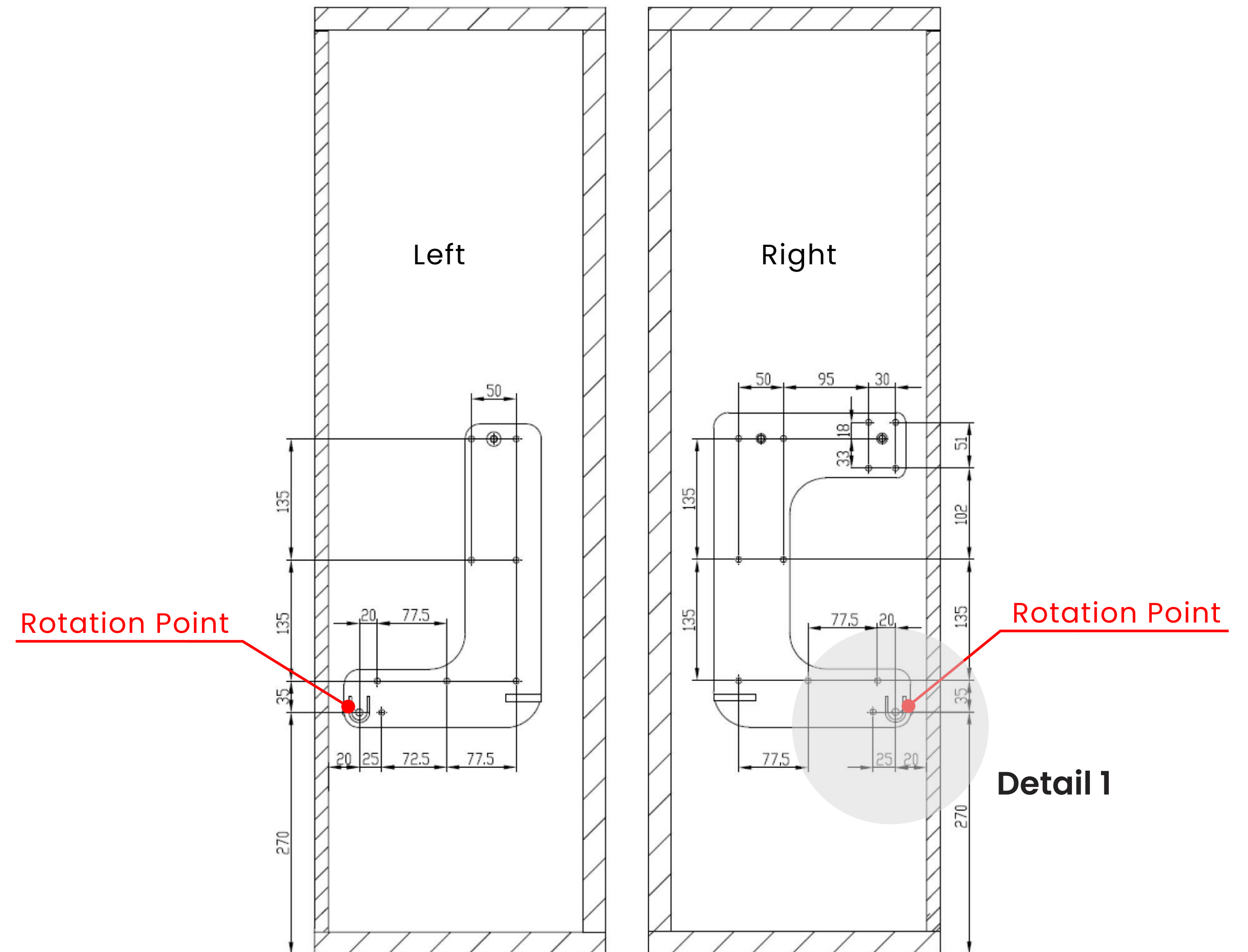
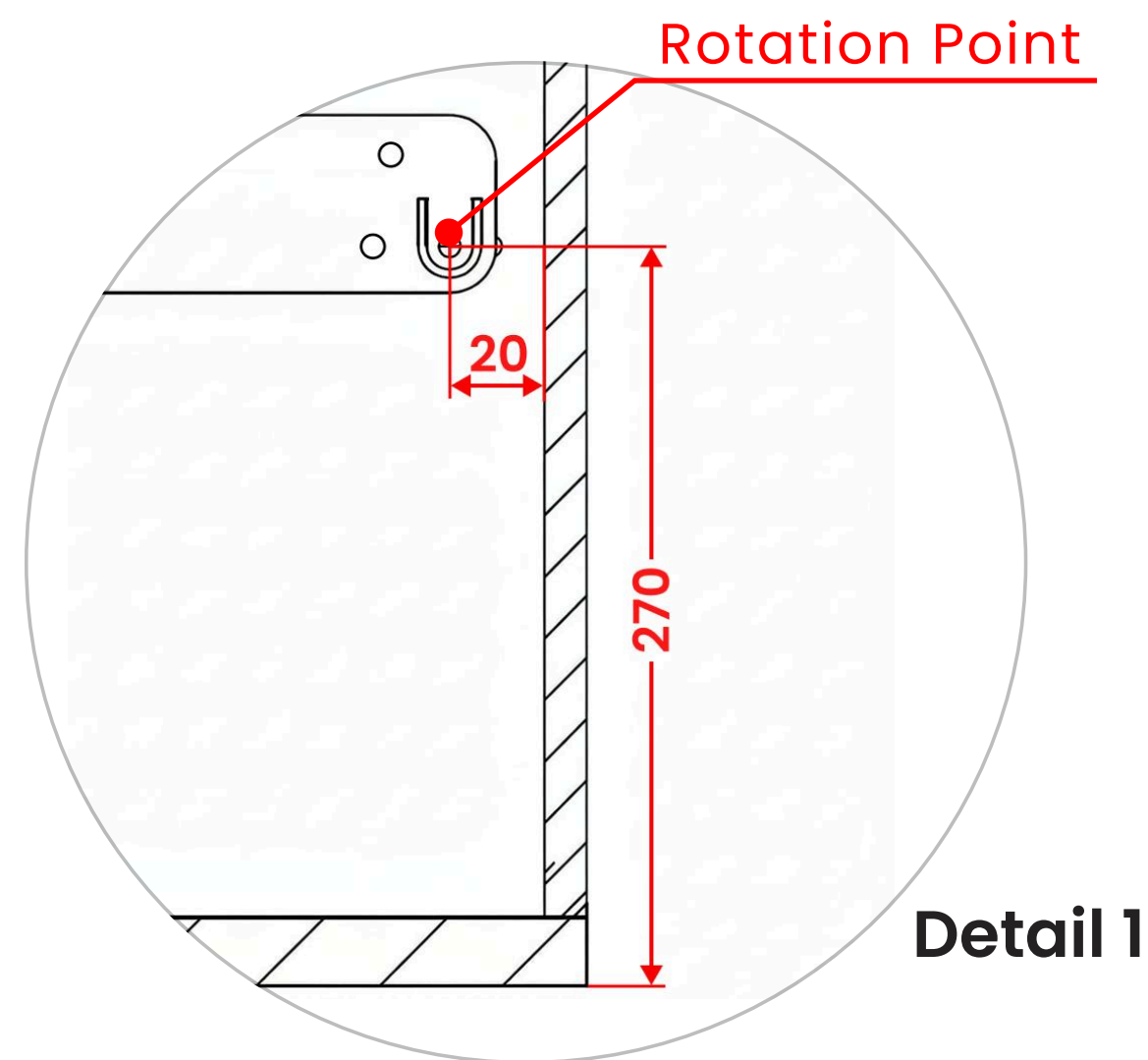

SYSTEM INSTALLATION

Interface Plate

2. Mount the **interface plate** onto the **bed frame** at the designated position, ensuring **correct alignment** as specified in the system layout.

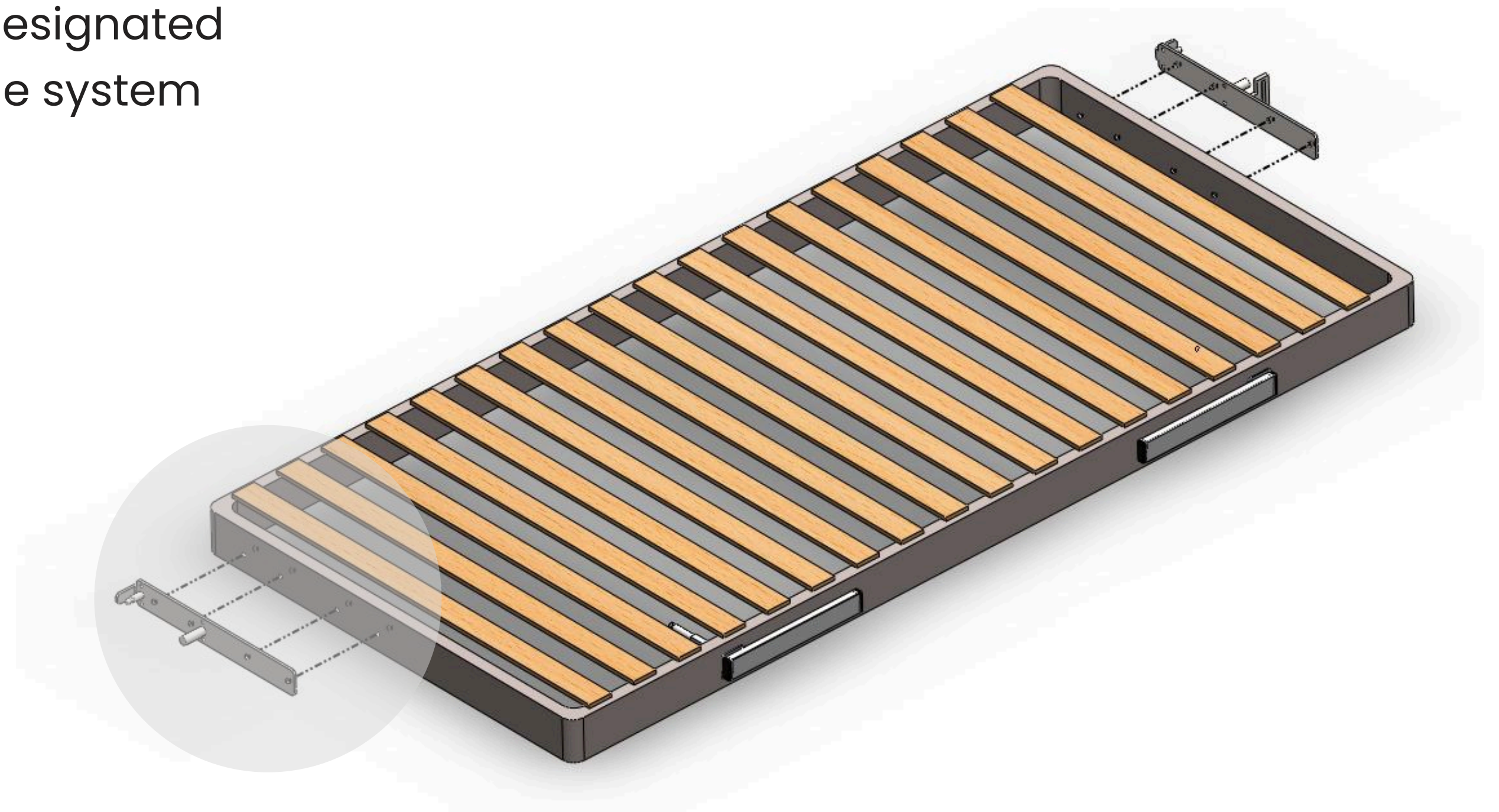
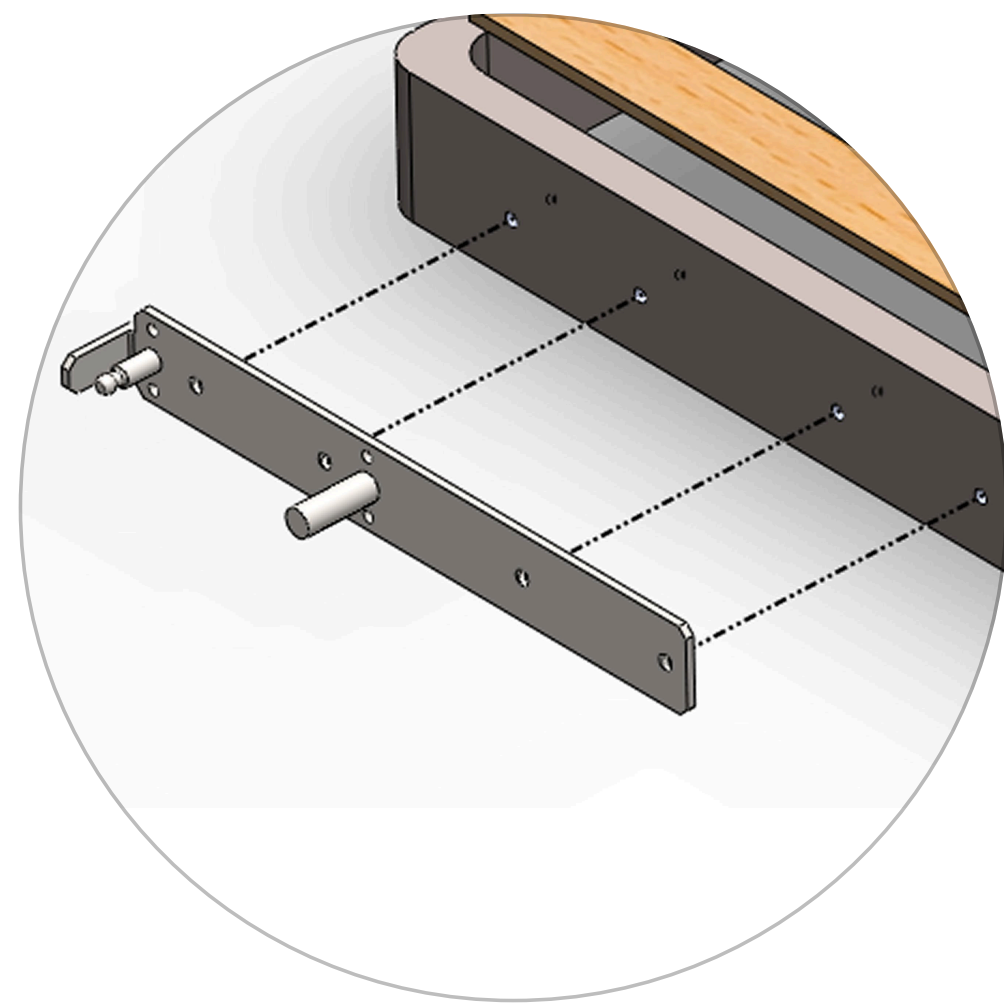

SYSTEM INSTALLATION

Interface Plate

Drilling measurements for interface plate mounting.

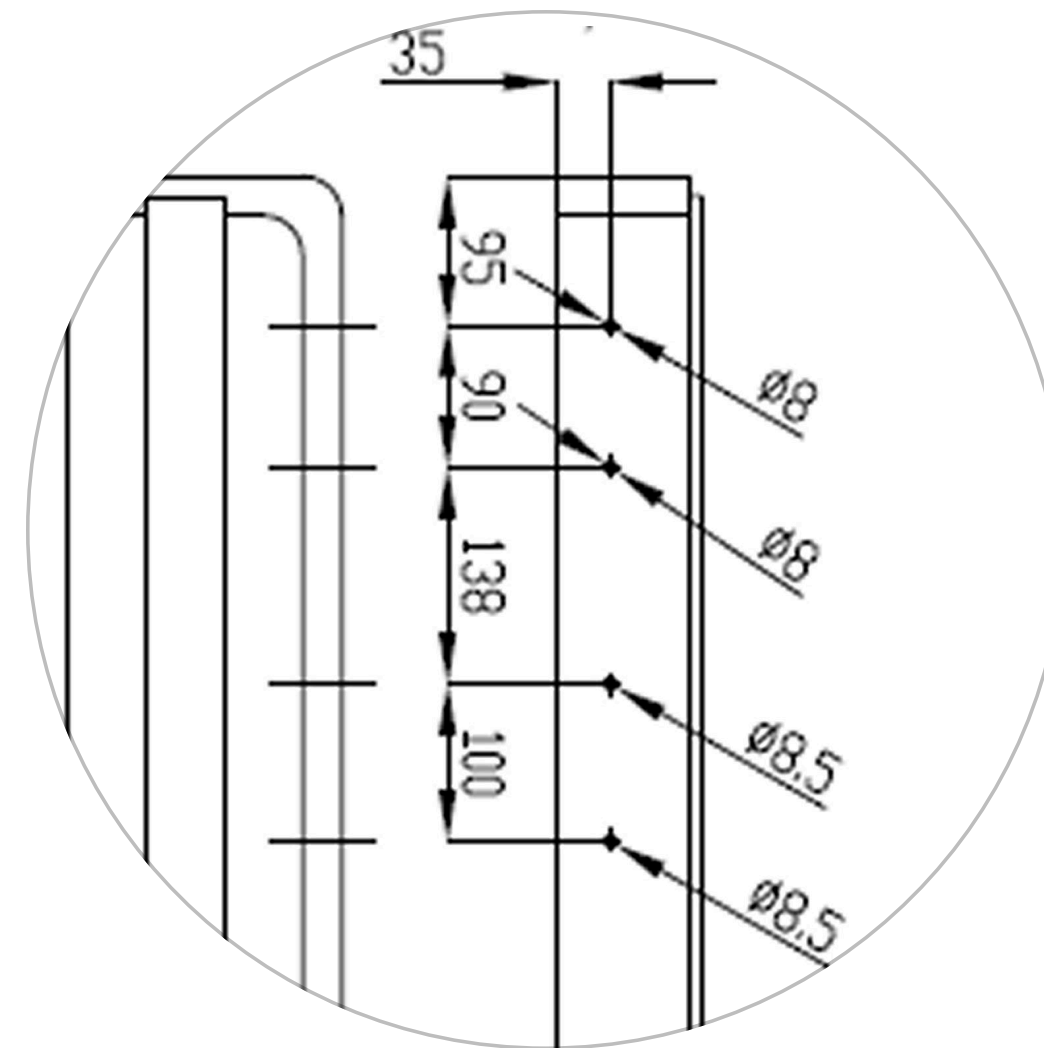
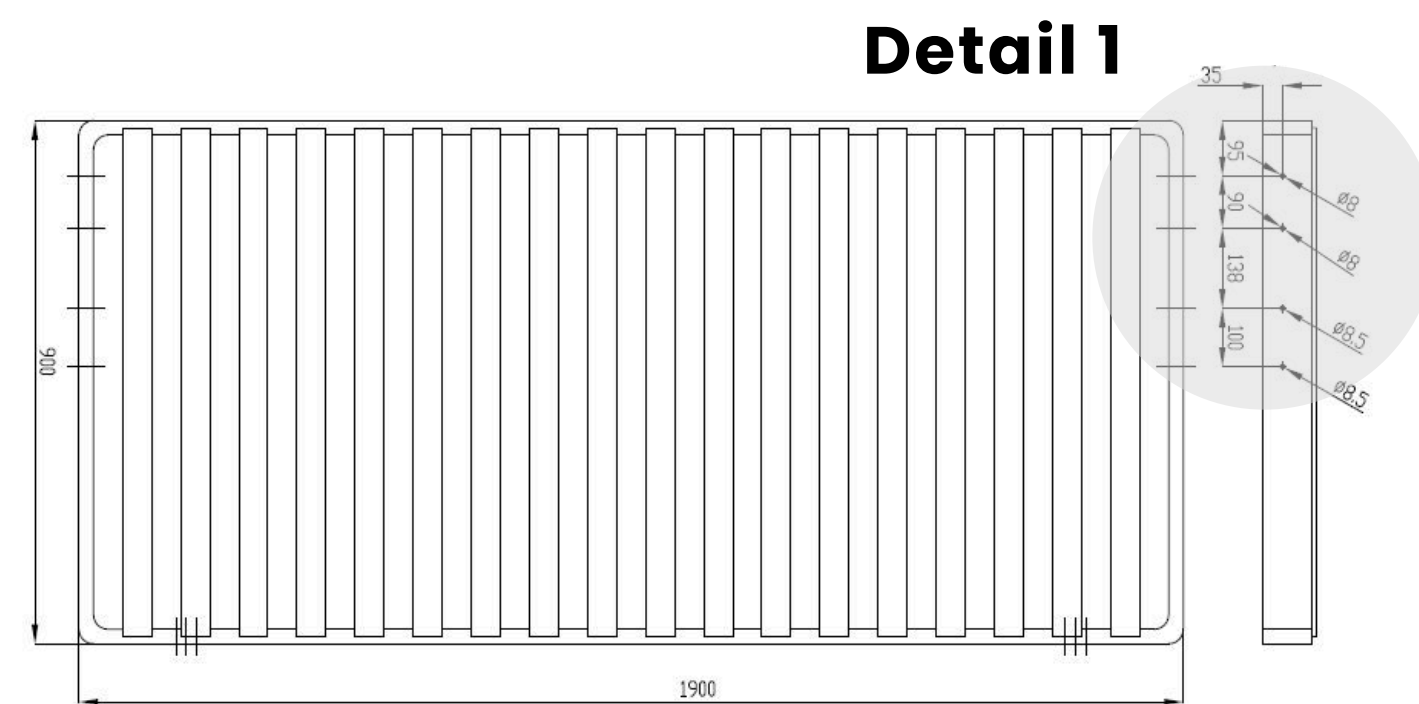

Detail 1

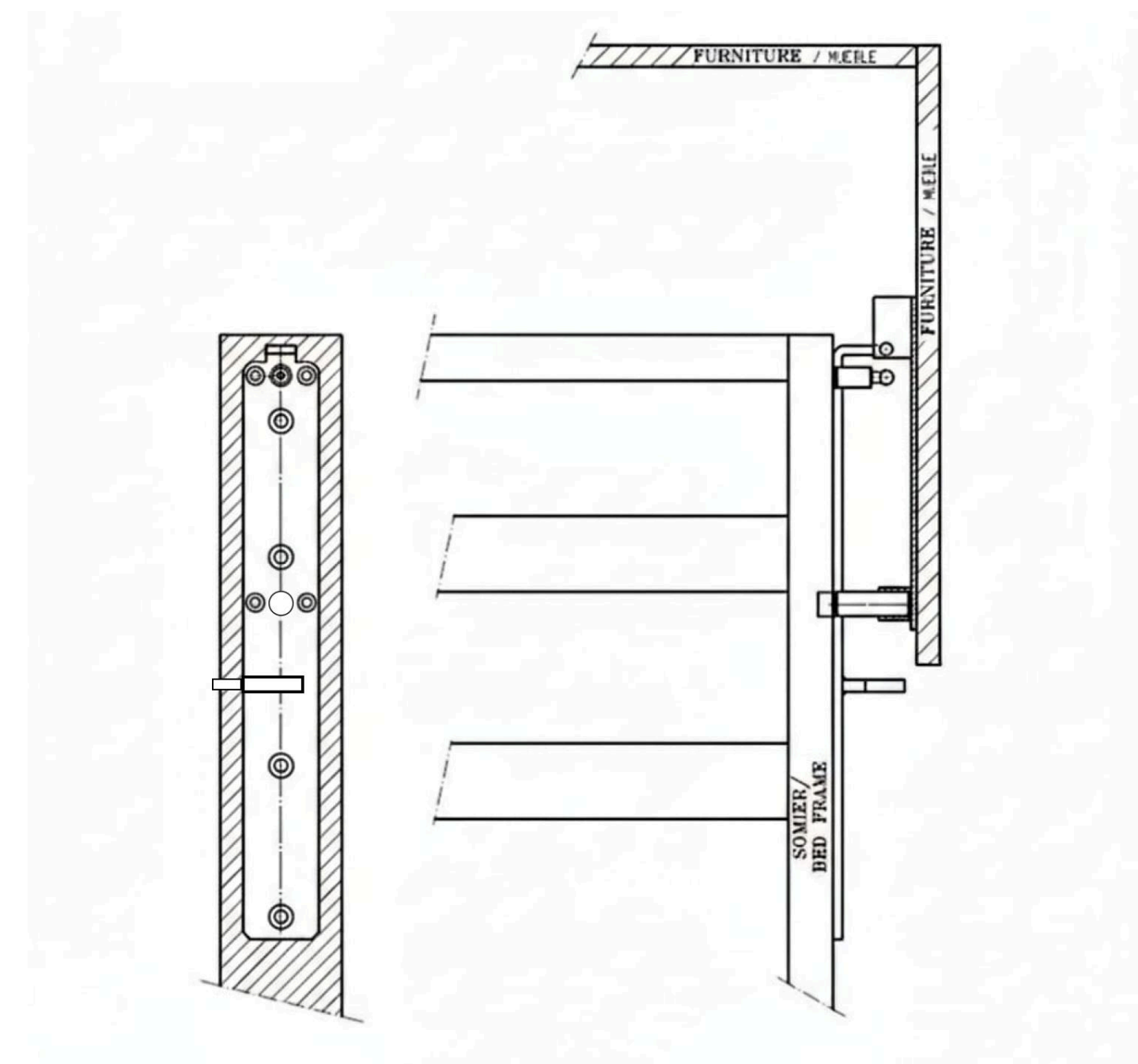

Side View

Plan View

SYSTEM INSTALLATION

Gaz Lifts

3. Assemble the gas lifts to the bed frame by **inserting the black plastic ball fittings into the ball studs** located on both sides of the frame.

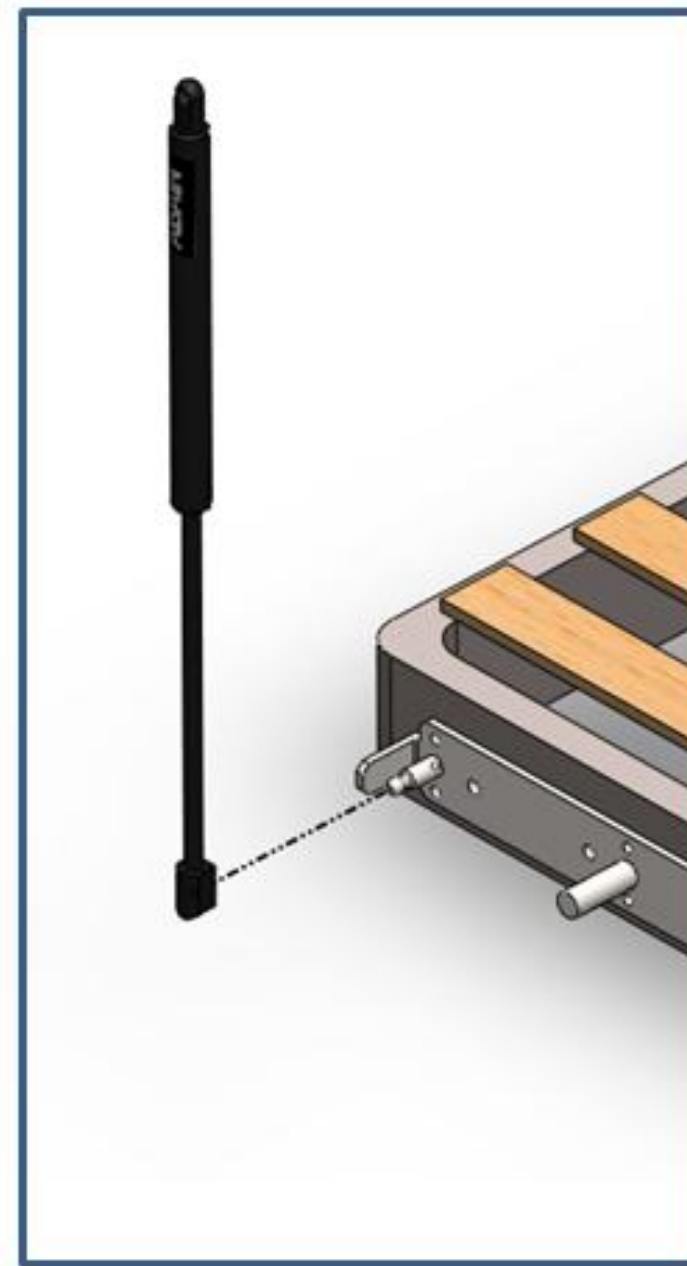

4. Install the bed base into the cabinet by resting the **bed bolts on the U-shaped plate supports**.

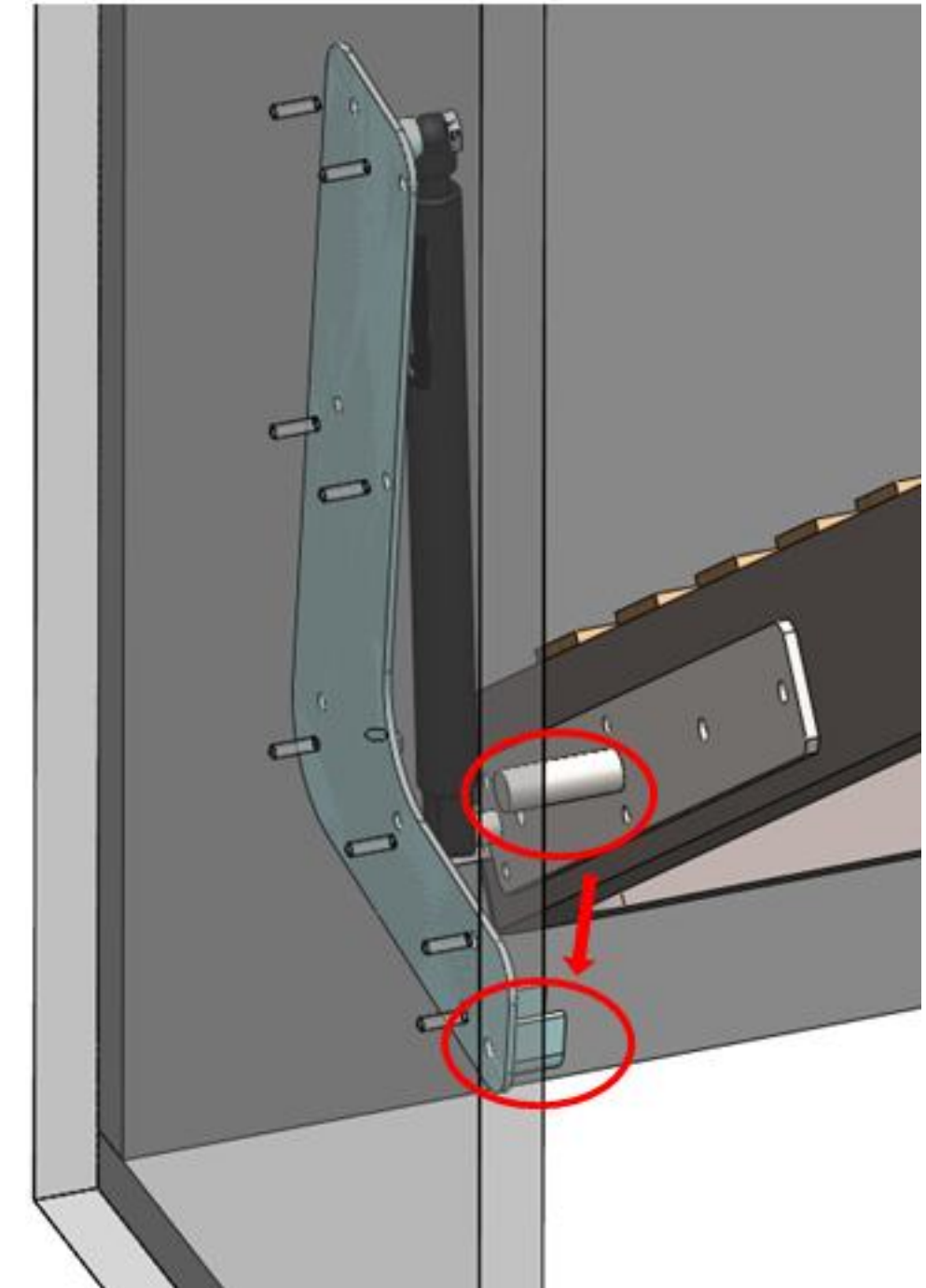

SYSTEM INSTALLATION

Gaz Lifts

5. Without installing the door, **close the bed frame beyond the cabinet front** and **secure the gas lift eyelet** to the plate's threaded bolt.

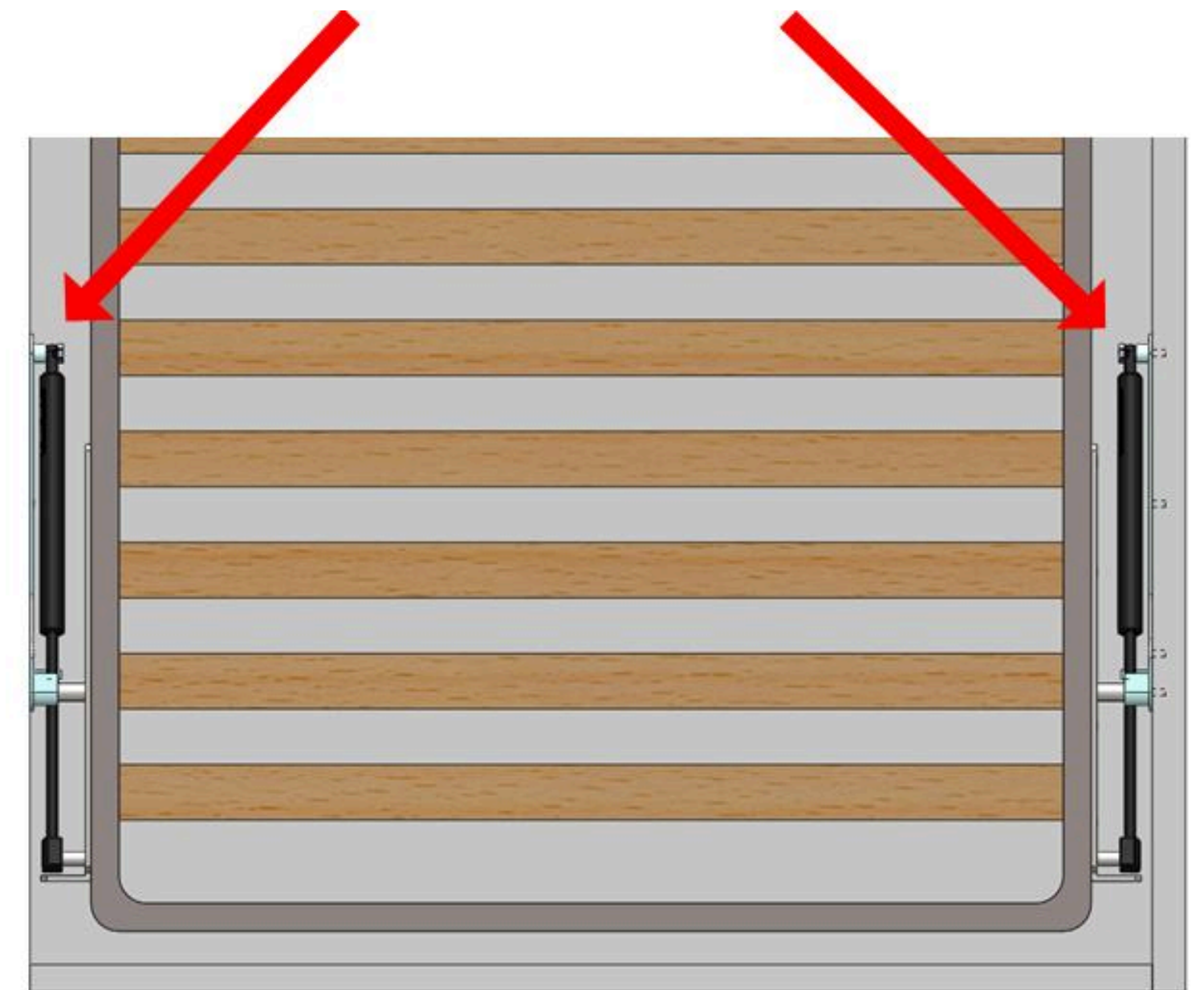
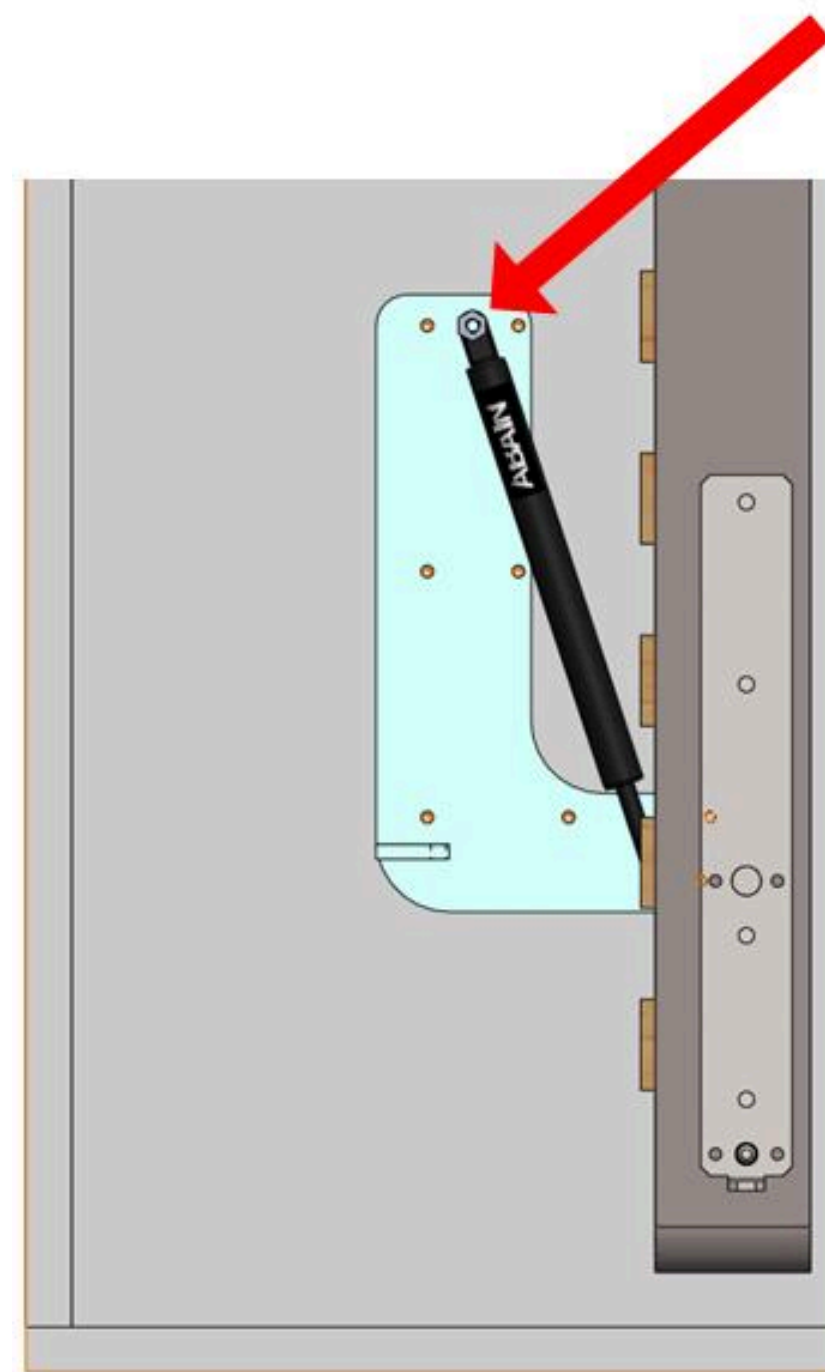

SYSTEM INSTALLATION

Hook Installation

6. Install the **hook** into the right-hand bed **frame link**, with the **open side facing the inside of the cabinet**, then **secure the opposite end** to the plate's threaded bolt with the nut.

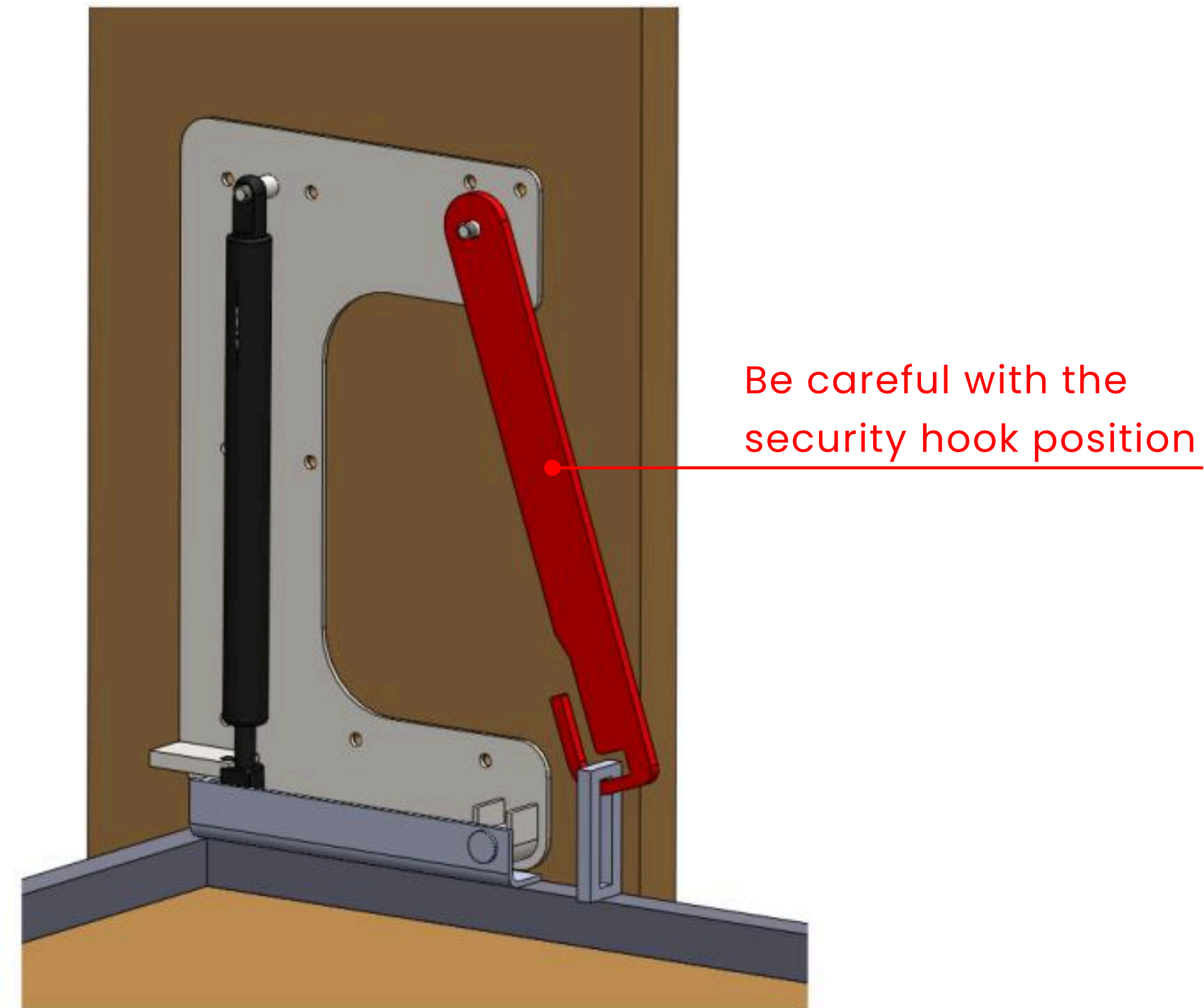

SYSTEM INSTALLATION

Legs Support

7. The **leg support** is **fixed to the bed frame** and **rests on the floor** to support the bed when opened.

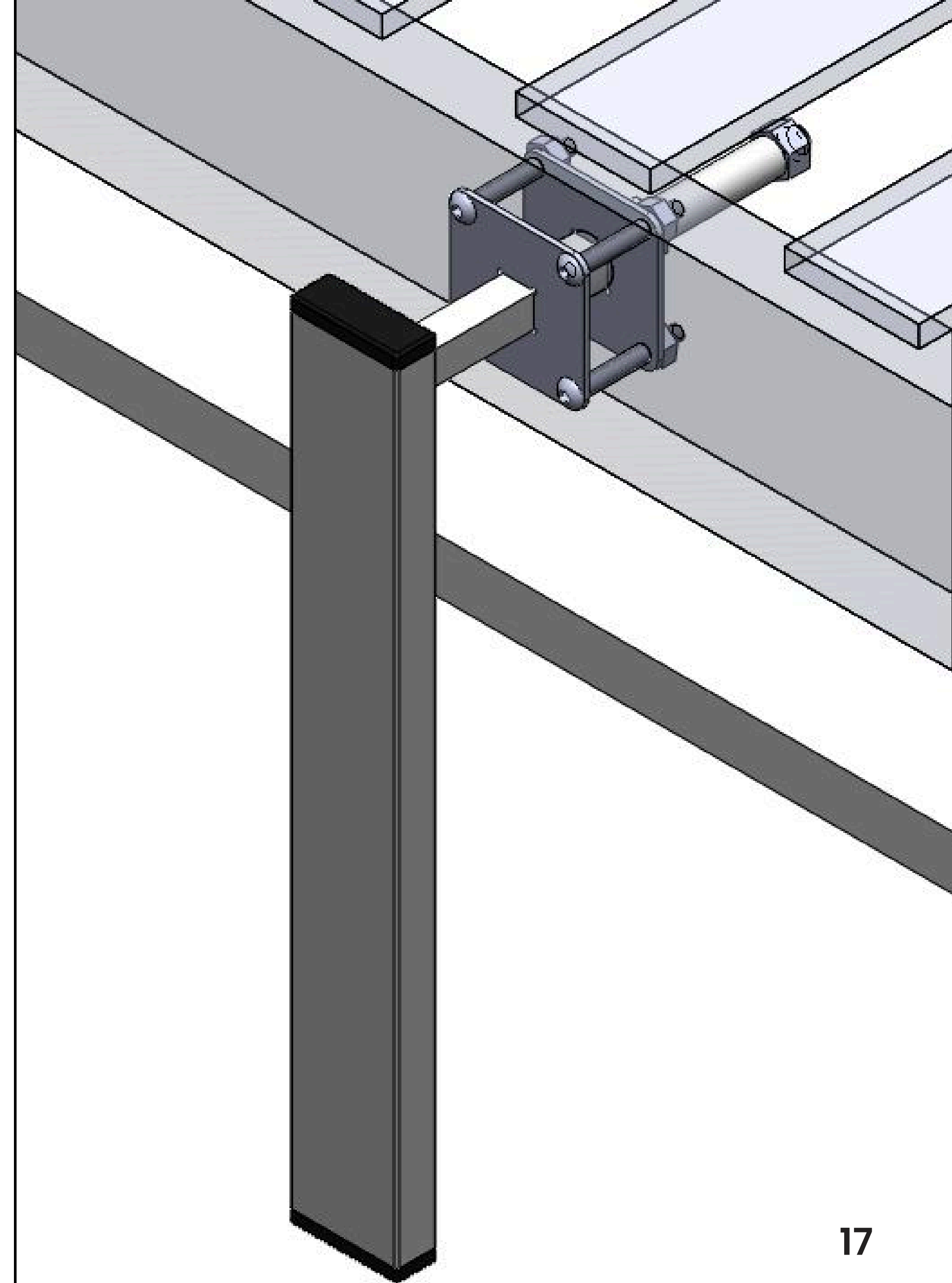

OPERATING SEQUENCE

Smooth Lowering With Support

Bed lowering sequence with automatic leg support engagement in the open position.

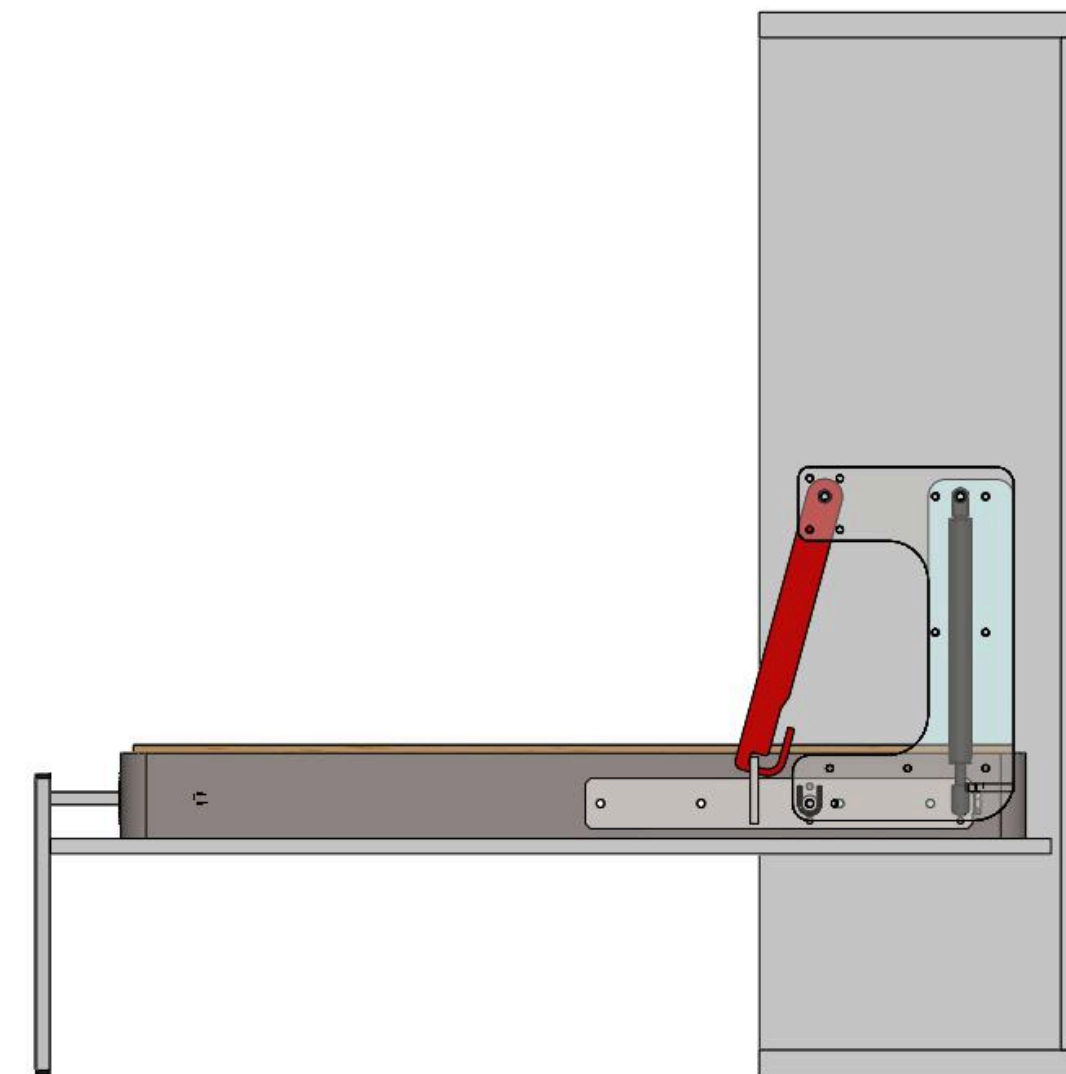
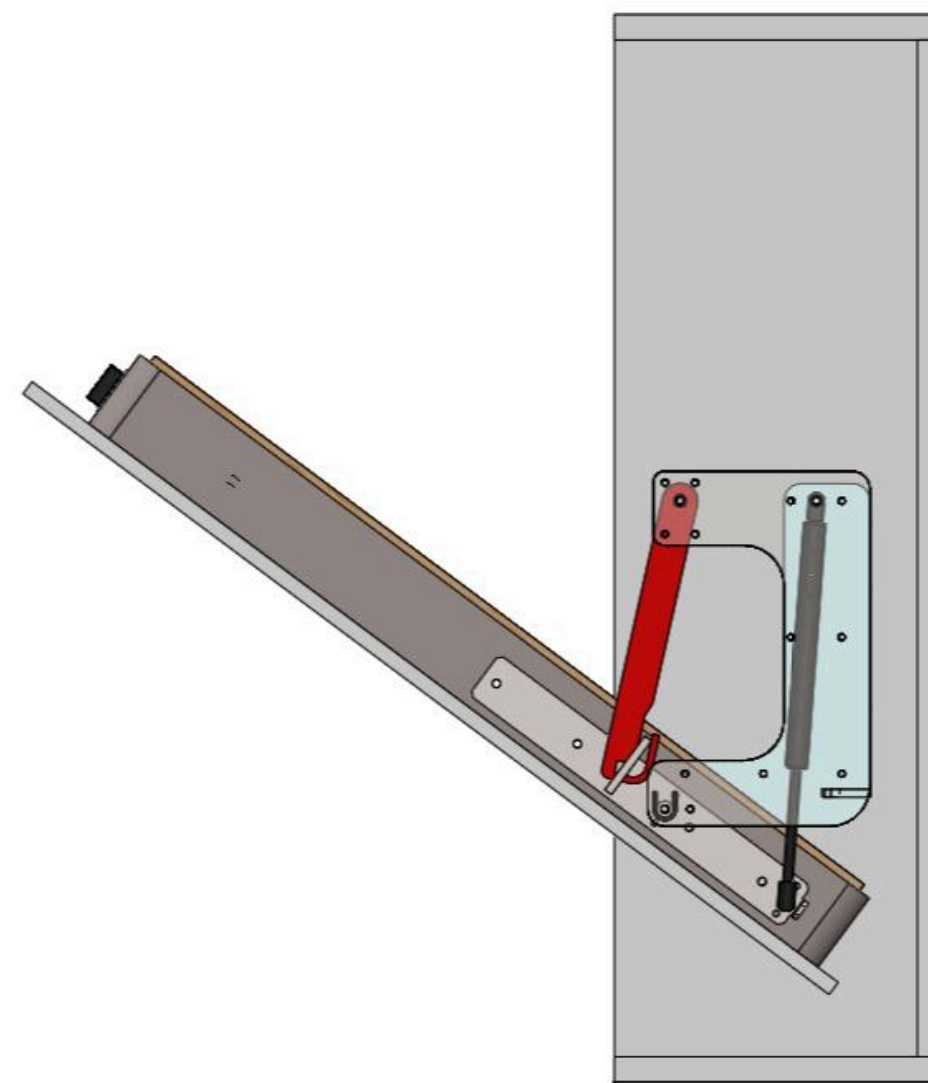
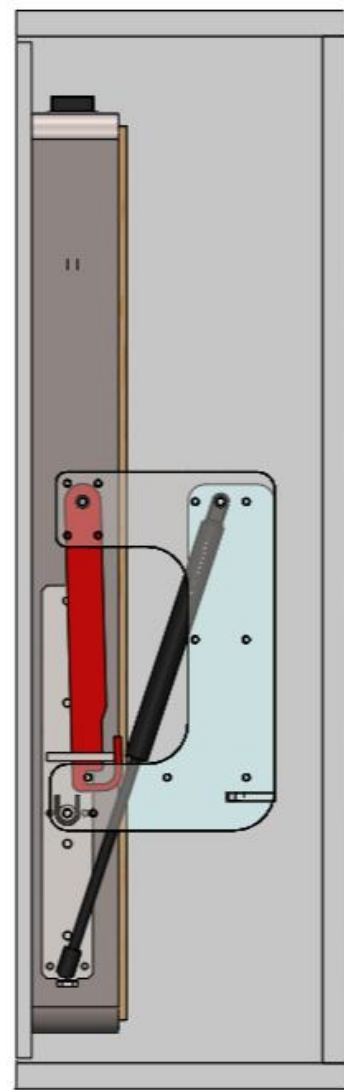



| Bed Systems

Nathalium .Co

Jamal Abdul Nasser Str. – Al Bahsas – Tripoli, Lebanon

Tel: 06/411790 , 06/411 791 – cell: 71/847529

www.nathalium.com – info@nathalium.com



© NATHALIUM 2026. All right reserved