



ATHALIU

Elevating Spaces with Italian Precision

BED SYSTEM

ABAIN
MADE IN SPAIN

VERTICAL WALLBED

TABLE OF CONTENT

01	Introduction	03
02	Materials & Tools	
	Main Components	05
03	System Structure	
	Components	06
	Measurements	07
	Gaz Lift Strength	08
	Assembly Overview	09

04	System Installation	
	Lateral Plates	10-11
	Interface Plate	12-13
	Gaz Lifts	14-15
	Legs Support	16
05	Operating sequence	
	Smooth Lowering With Support	17

INTRODUCTION

The Abain Vertical Wallbed System is a functional space-saving solution designed for efficient and safe use. This catalogue outlines the system operation, key components, accurate dimensions, and step-by-step installation guidelines to ensure proper performance and durability.



MATERIALS & TOOLS

Main Components

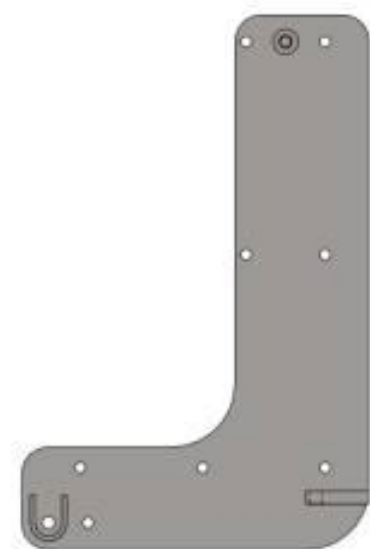

• Left Plate

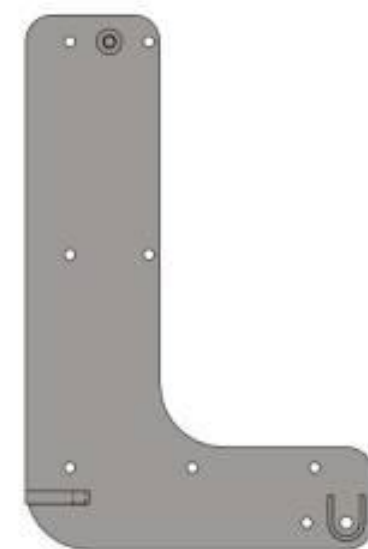

• Right Plate

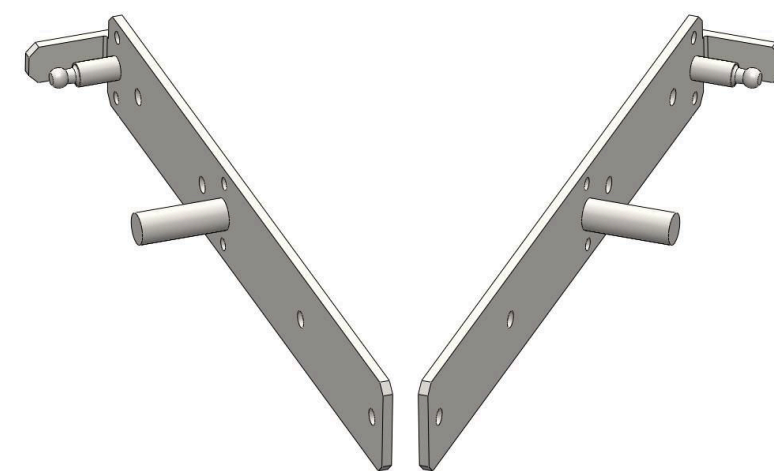

• Interface Plate



• Gaz Lifts

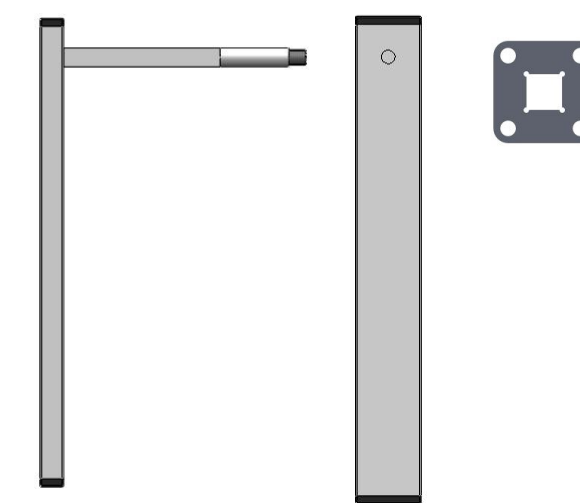

• Legs Support

SYSTEM STRUCTURE

Components

The illustration presents the complete **vertical wall bed system**. The annotated drawing identifies all **key components** and provides a clear understanding of the system structure and operation.

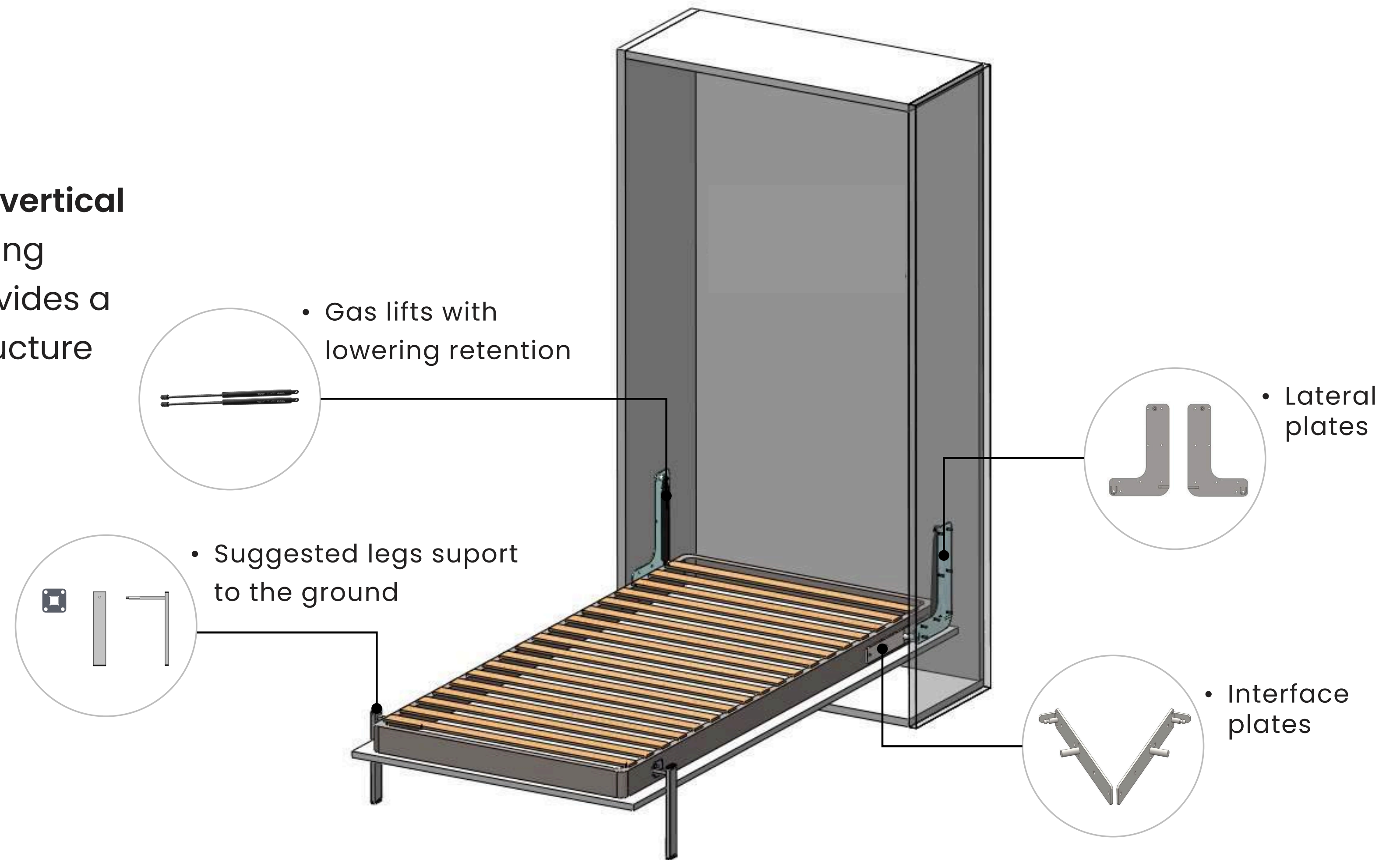

SYSTEM STRUCTURE

Measurements

Inner measurements resulting from the final cabinet, regardless of thickness of the boards.

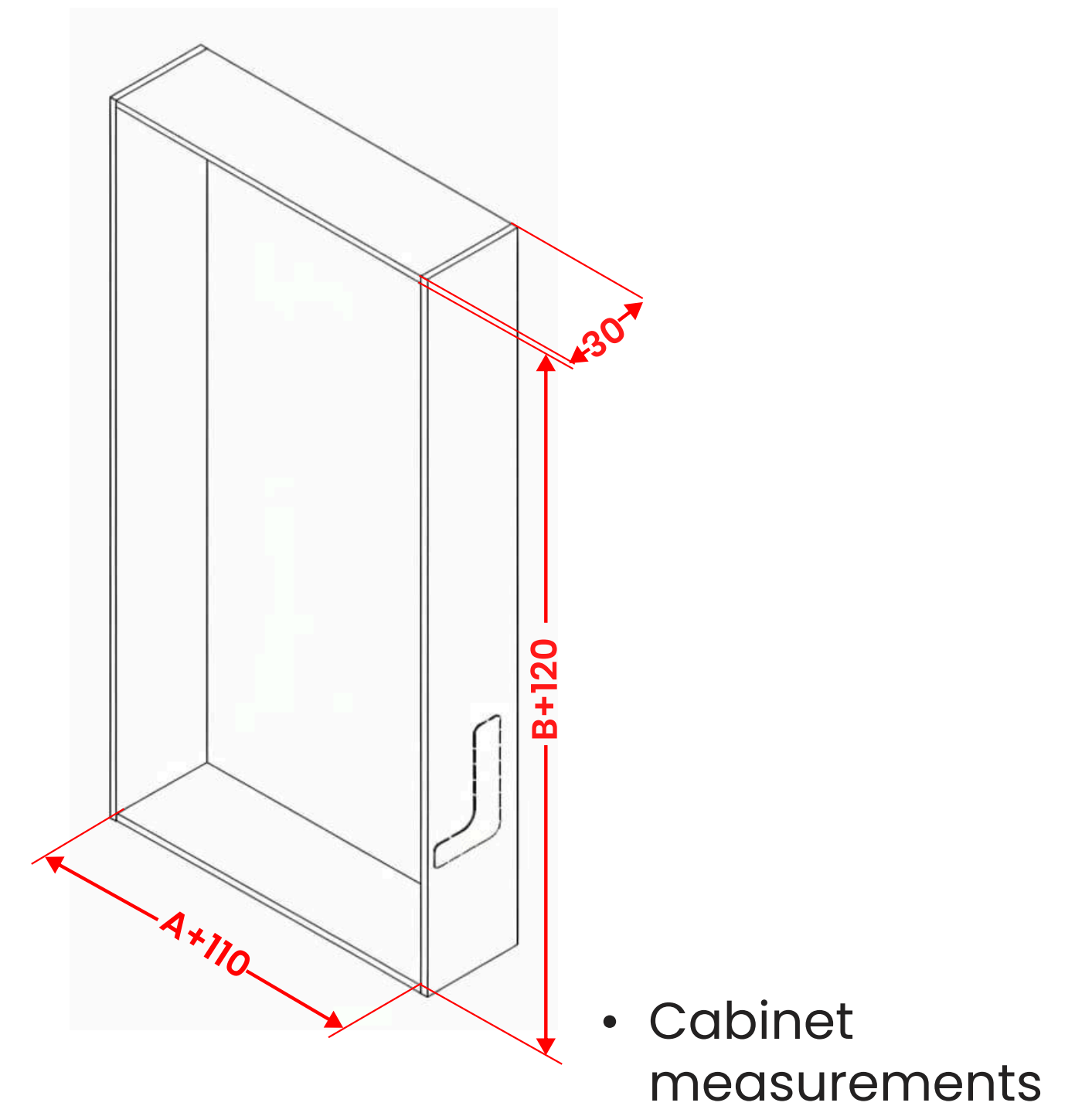
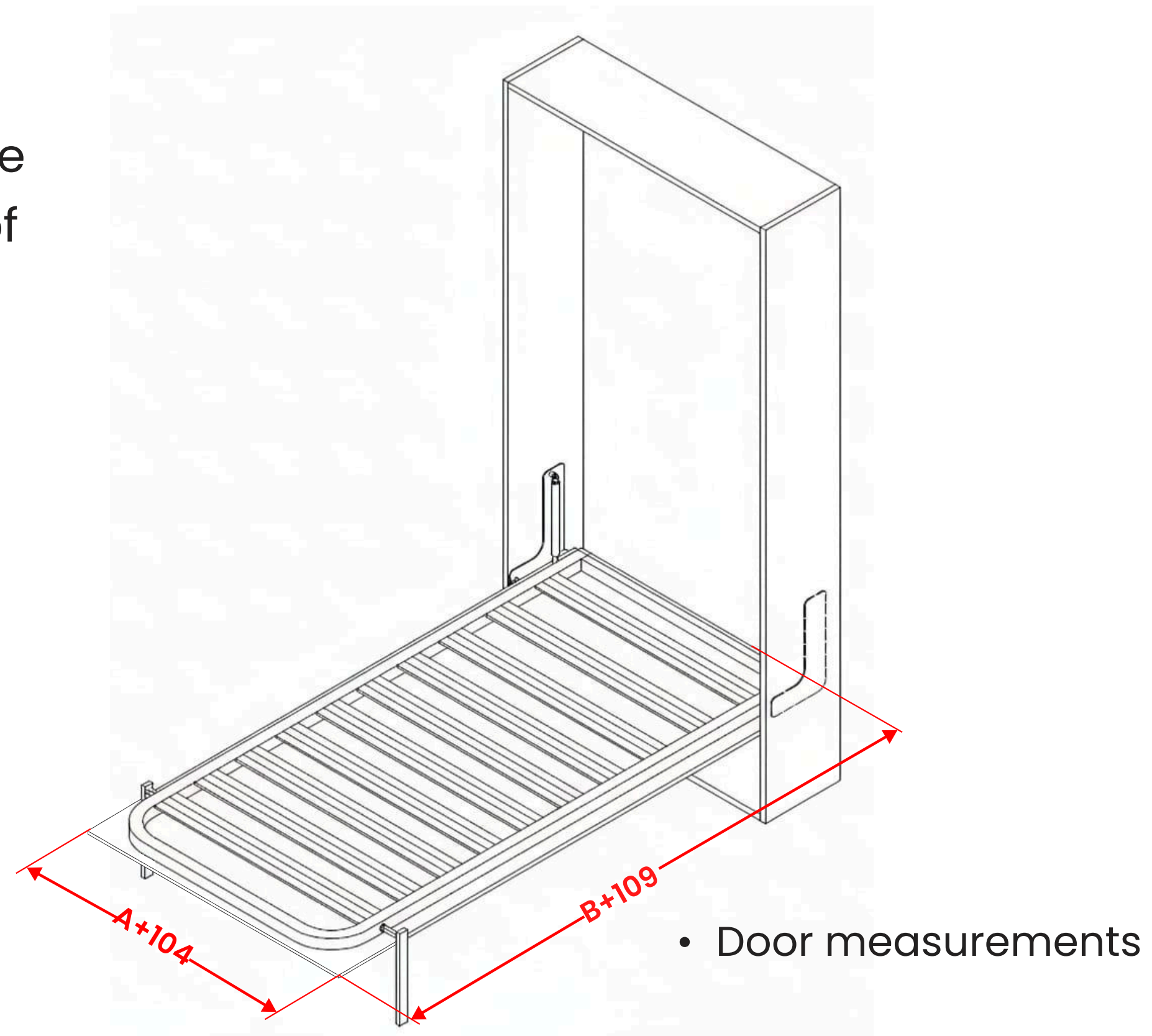
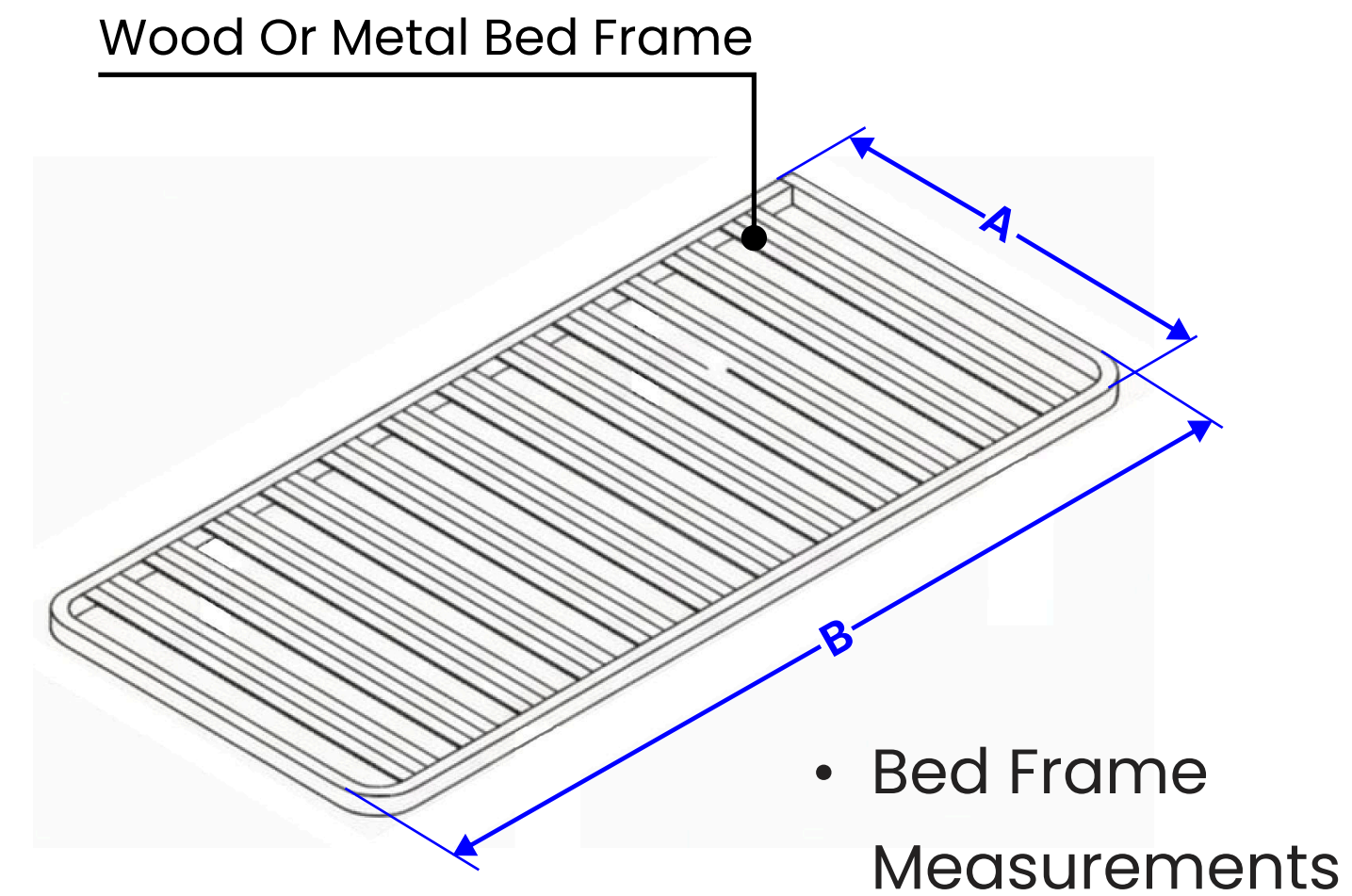

SYSTEM STRUCTURE

Gaz Lift Strength

A	B	Gaz lift strength
800	1800	700 N
800	1900	700 N
800	2000	800 N
900	1800	800 N
900	1900	800 N
900	2000	900 N

A	B	Gaz lift strength
1000	1800	900 N
1000	1900	900 N
1000	2000	900 N
1100	1800	1300 N
1100	1900	1300 N
1100	2000	1300 N
1200	1800	1300 N
1200	1900	1300 N
1200	2000	1300 N

A	B	Gaz lift strength
1300	1800	1300 N
1300	1900	1500 N
1300	2000	1500 N
1400	1800	1500 N
1400	1900	1500 N
1400	2000	1500 N
1500	1800	1500 N
1500	1900	1500 N
1500	2000	1500 N

A	B	Gaz lift strength
1600	1800	1500 N
1600	1900	1500 N
1600	2000	1700 N
1800	1800	1700 N
1800	1900	1700 N
1800	2000	1900 N
2000	1800	1900 N
2000	1900	1900 N
2000	2000	1900 N

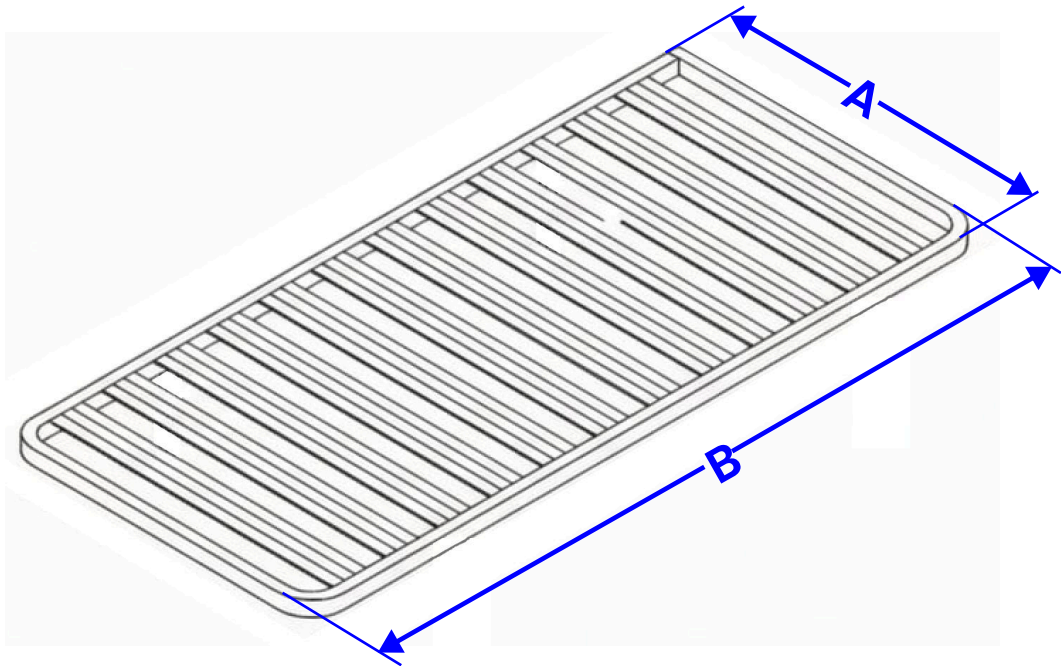

SYSTEM STRUCTURE

Assembly overview

- The **exploded 3D illustration** shows the **general assembly** of the wall bed system.
- It presents the **main components separated** to clarify their position and connection.
- Detailed explanations of each component are provided in the following pages.

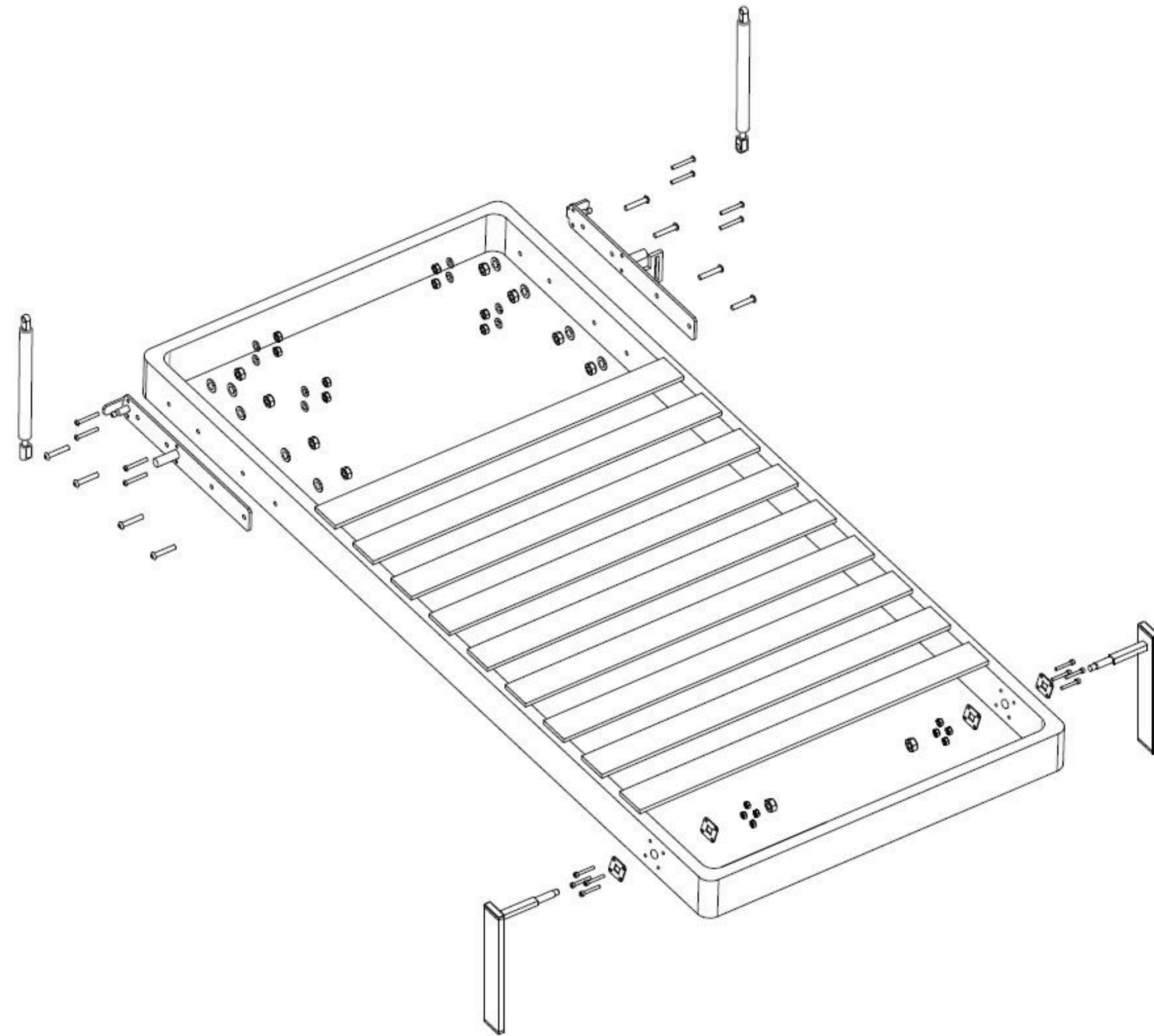

SYSTEM INSTALLATION

Lateral Plates

1. With the non-assembled cabinet, the metal plates are mounted inside of the side panels.

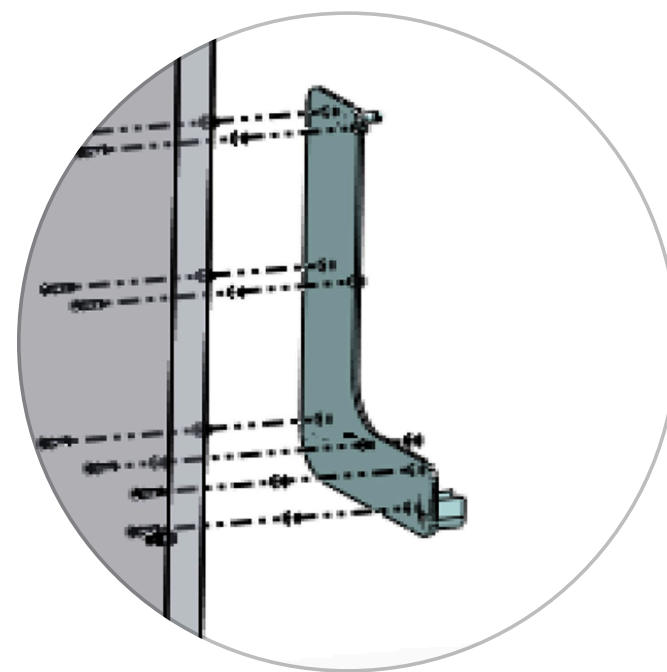

Left Plate

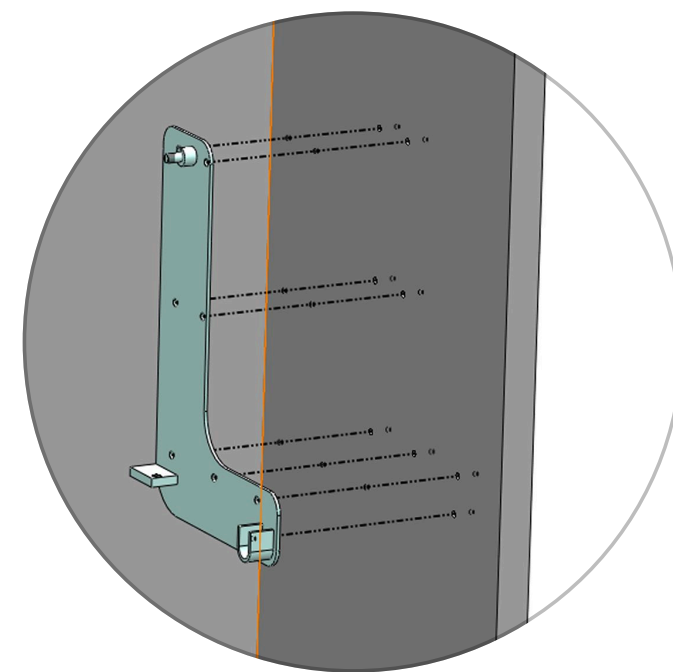

Right Plate

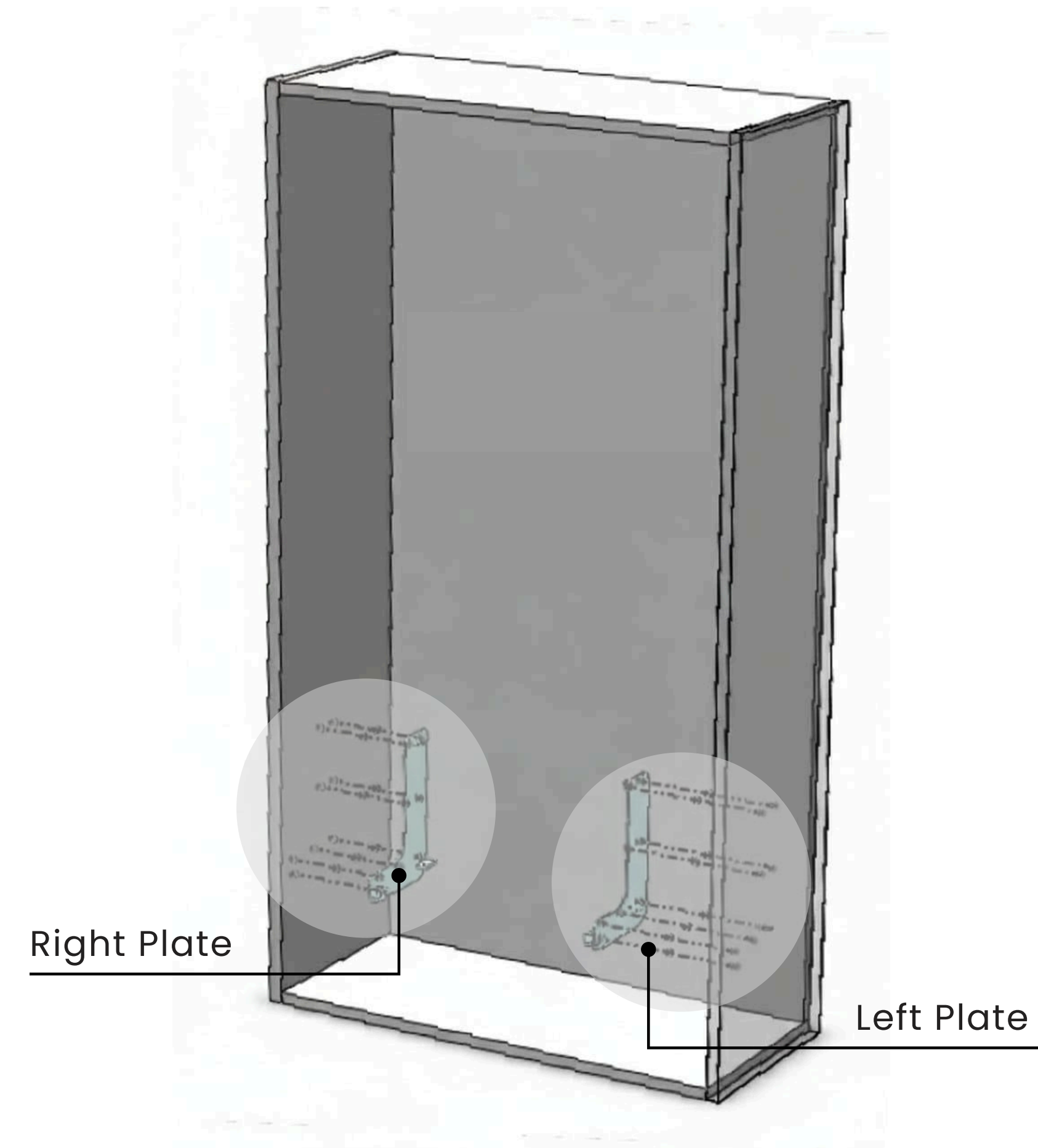

SYSTEM INSTALLATION

Lateral Plates

The point of origin is the pivot point, **270mm from the floor** and **20mm from the inside of the door**.

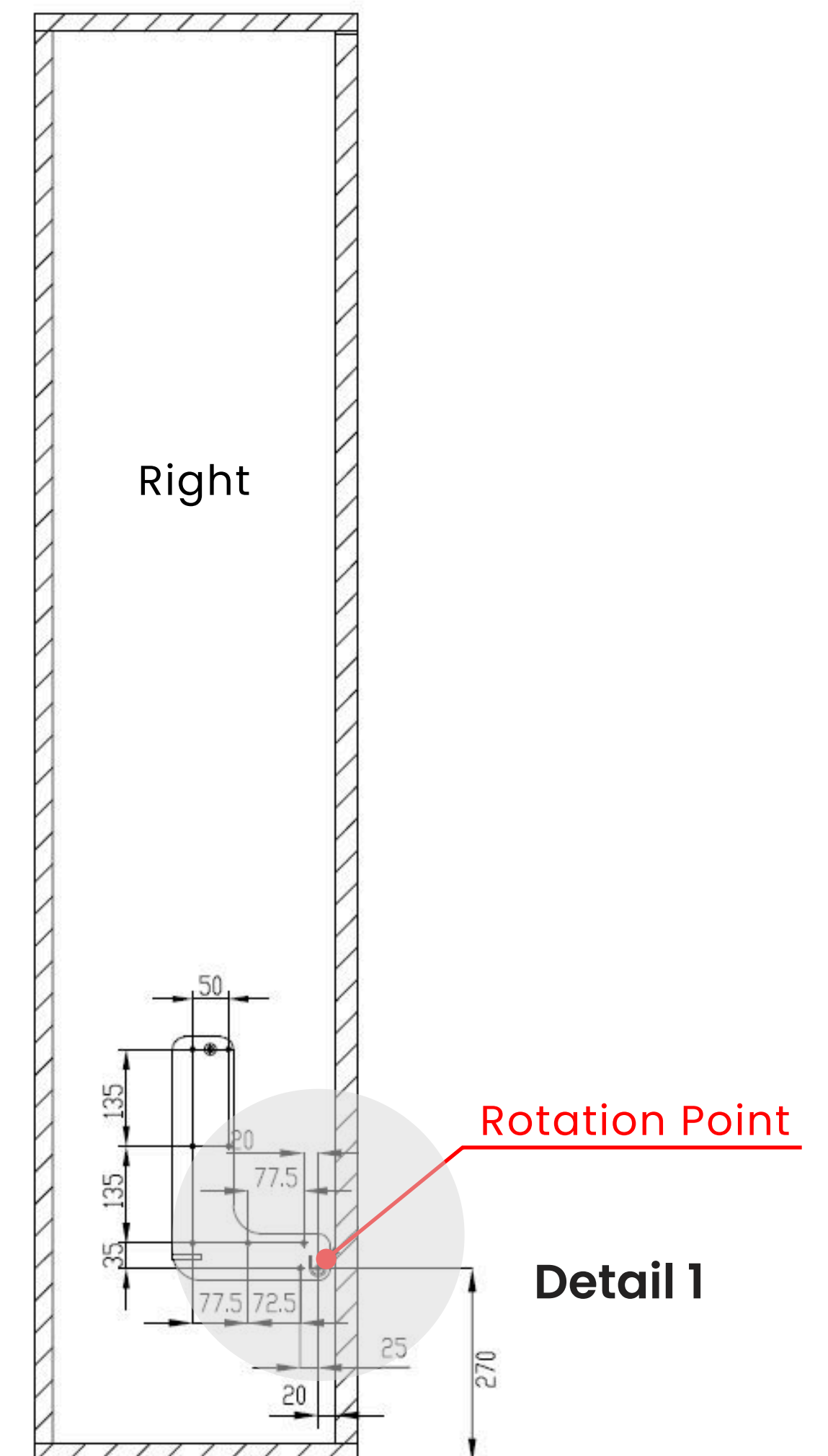
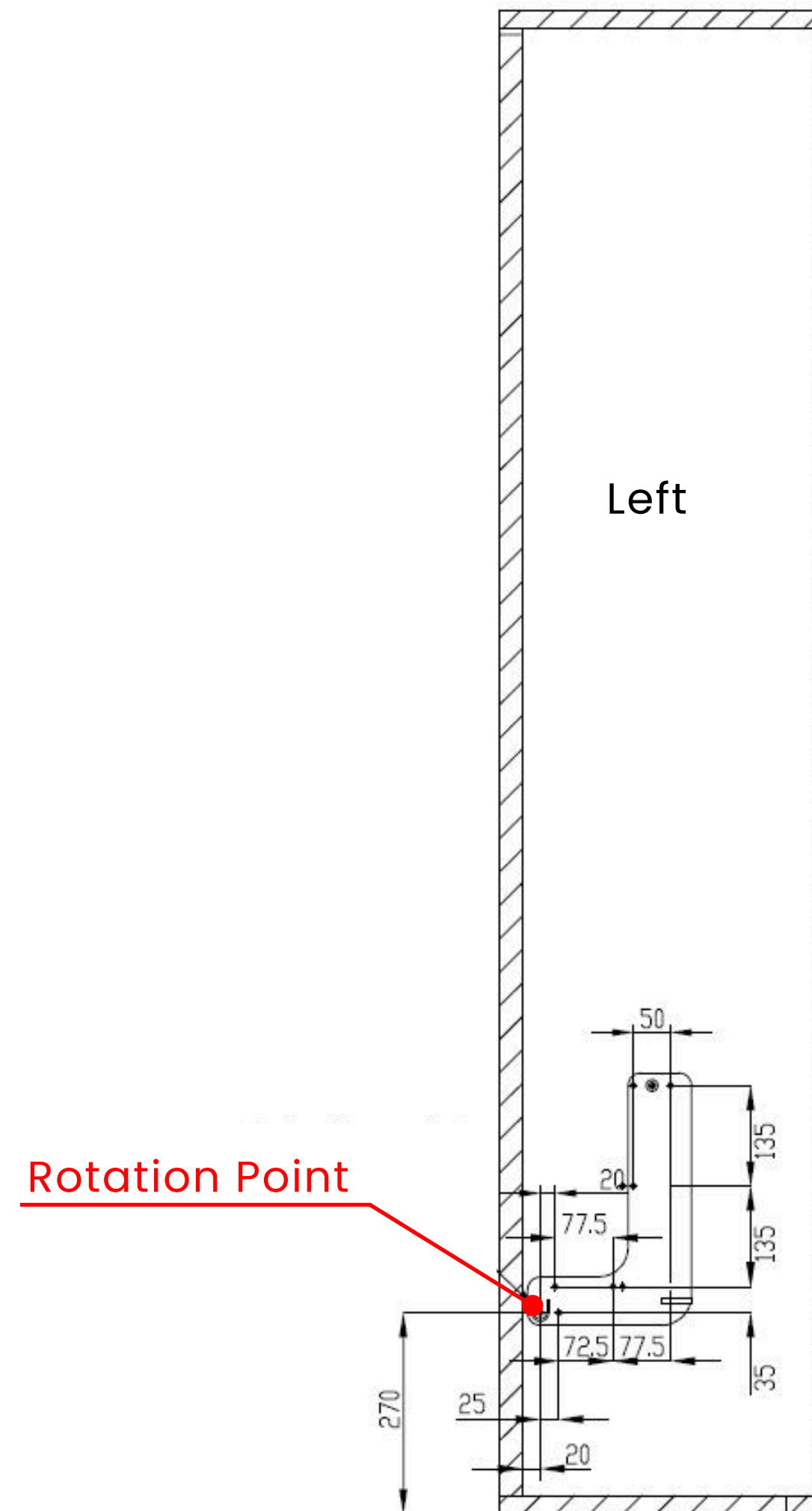
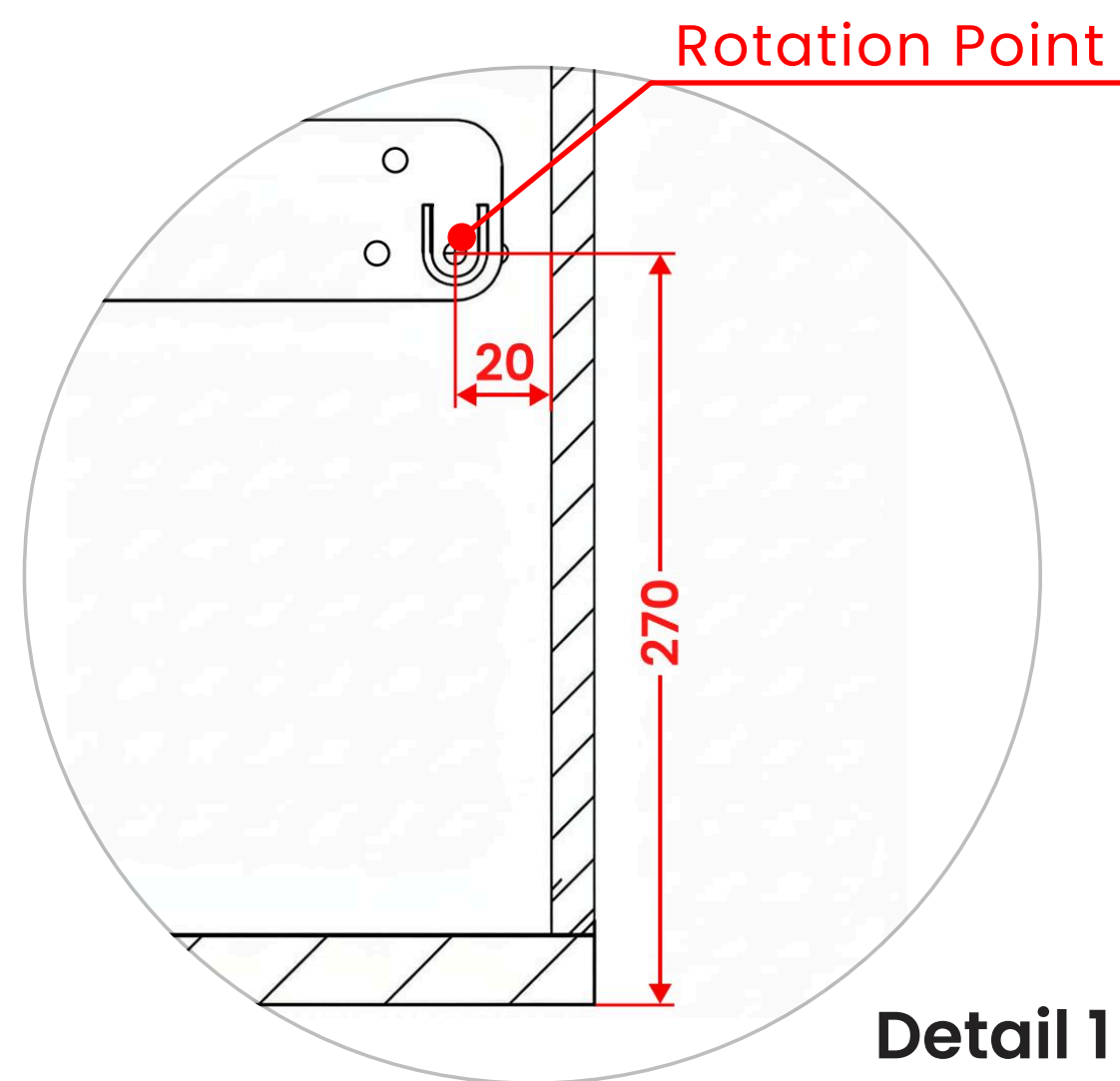

SYSTEM INSTALLATION

Interface Plate

2. Mount the **interface plate** onto the **bed frame** at the designated position, ensuring **correct alignment** as specified in the system layout.

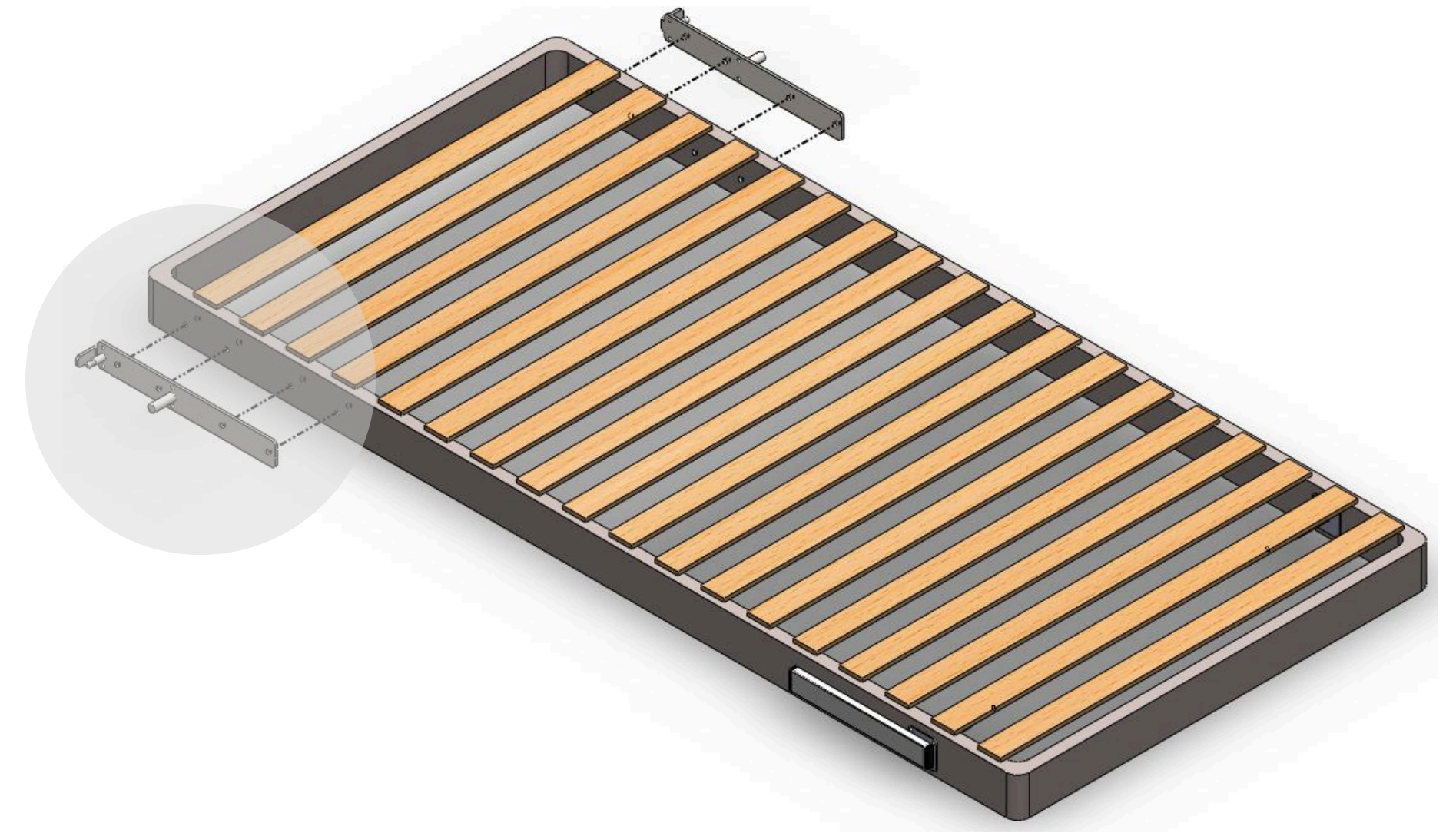
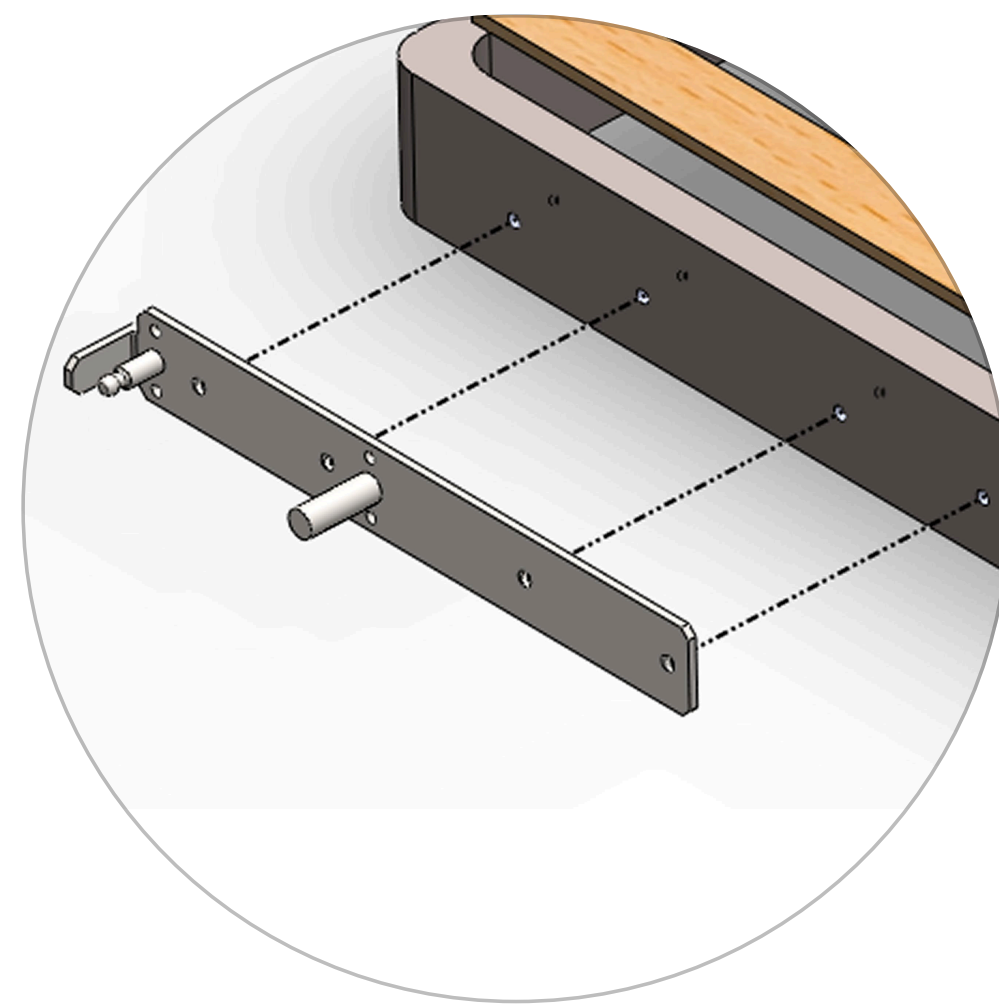

SYSTEM INSTALLATION

Interface Plate

Drilling measurements for interface plate mounting.

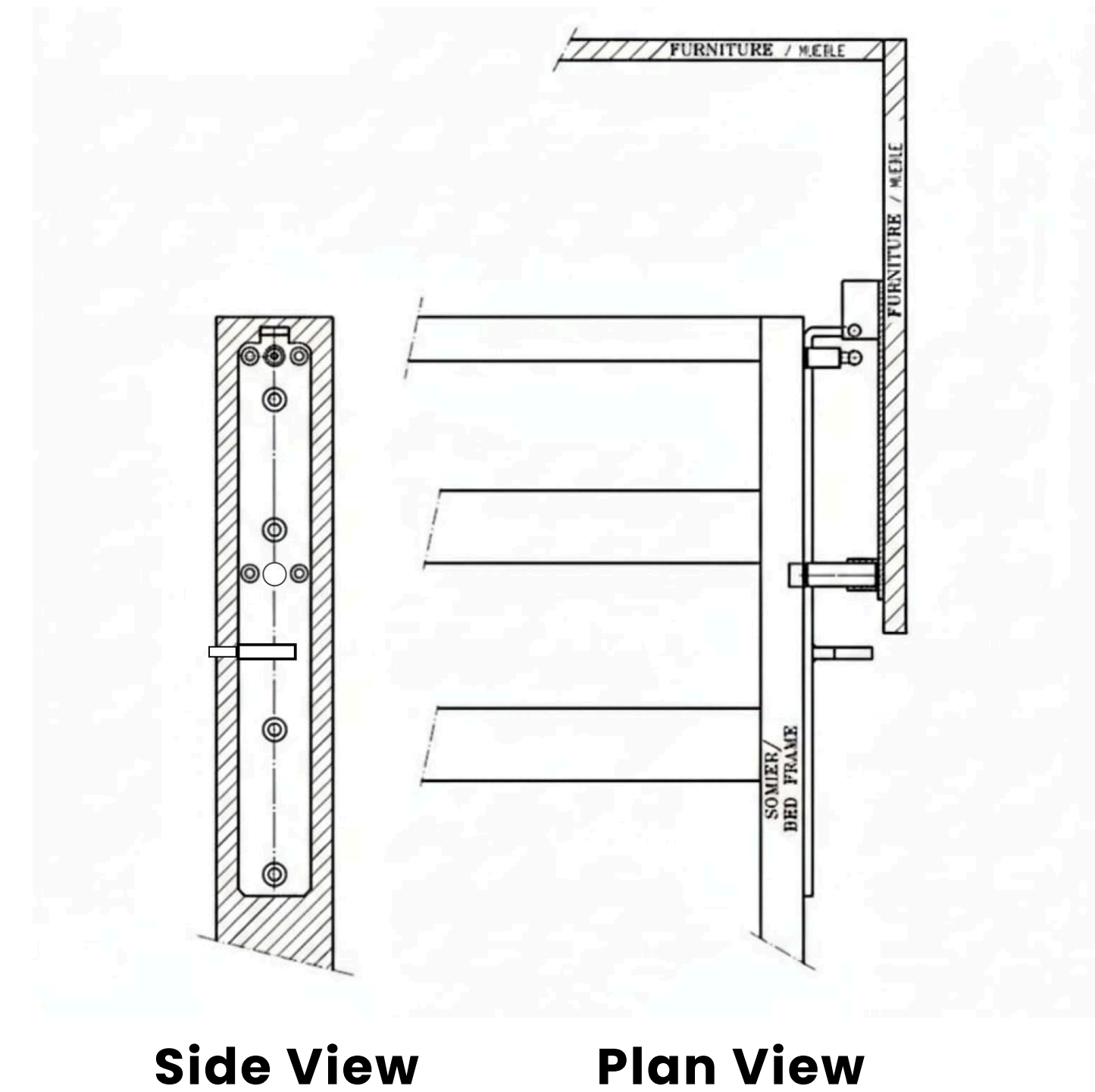
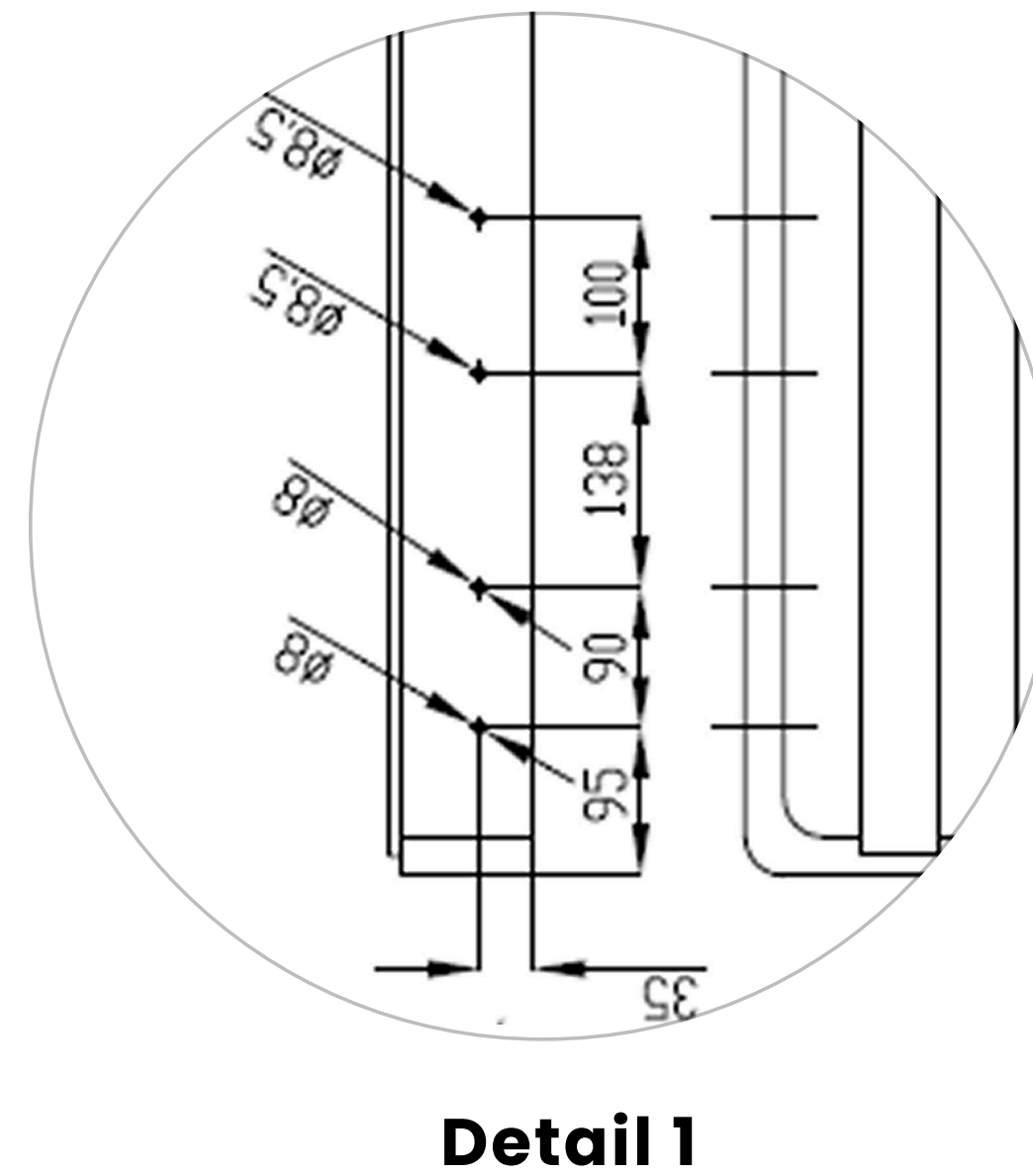
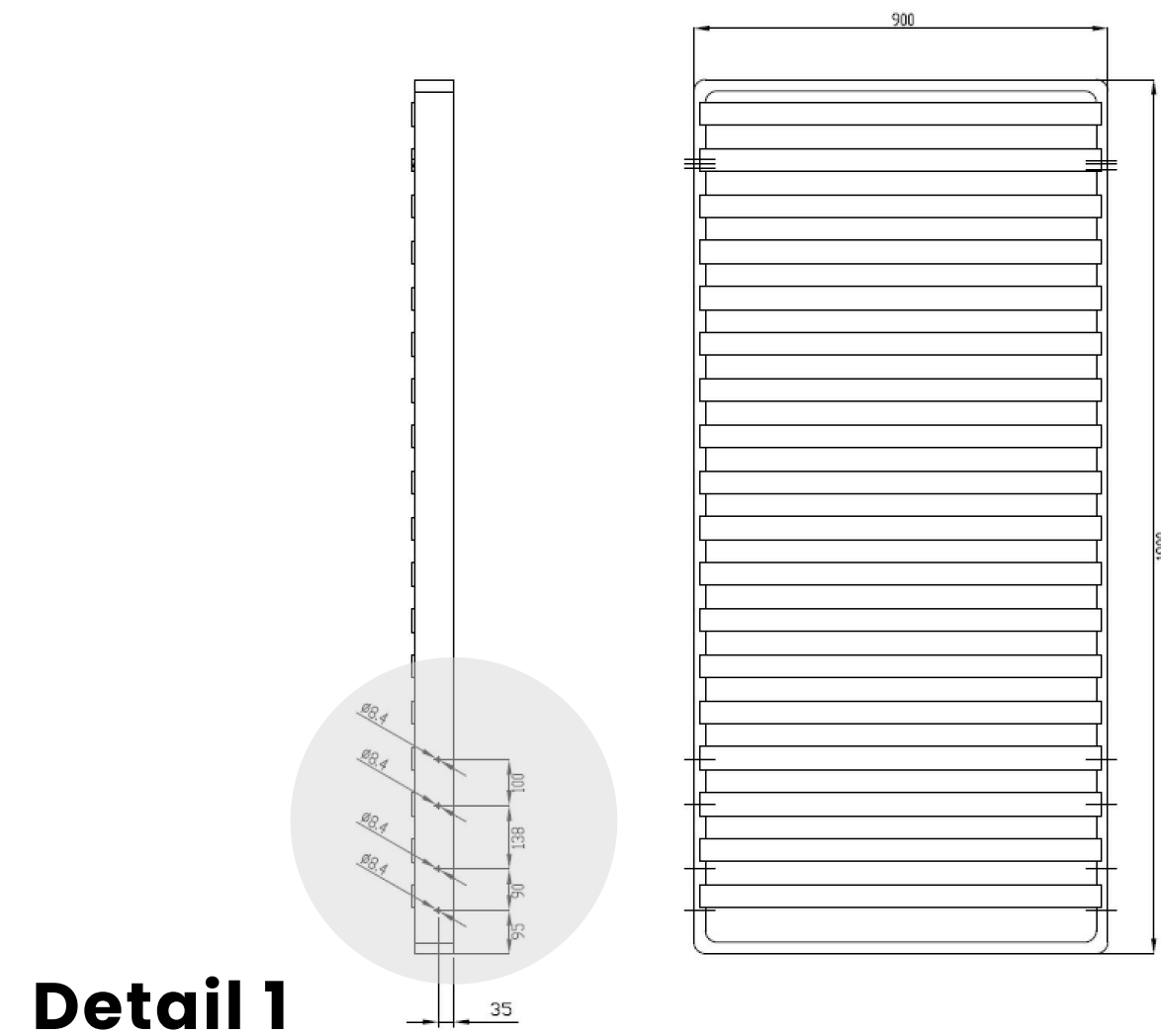

SYSTEM INSTALLATION

Gaz Lifts

3. Assemble the gas lifts to the bed frame by **inserting the black plastic ball fittings into the ball studs** located on both sides of the frame.

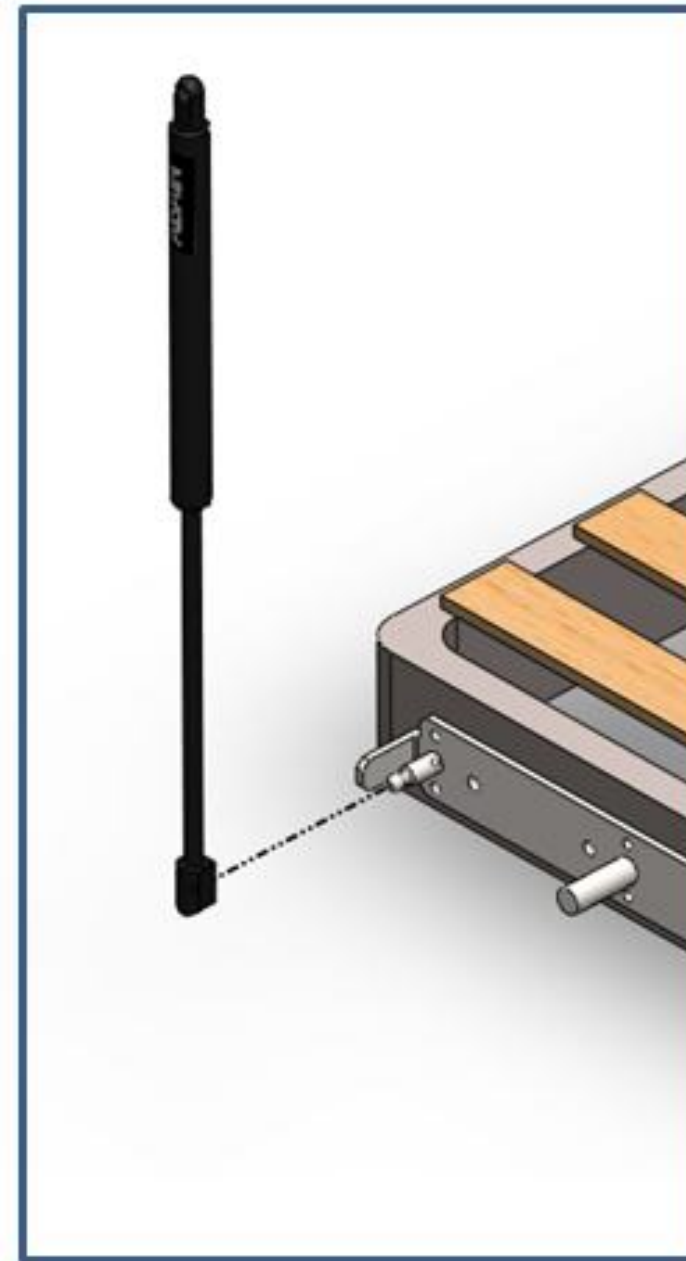
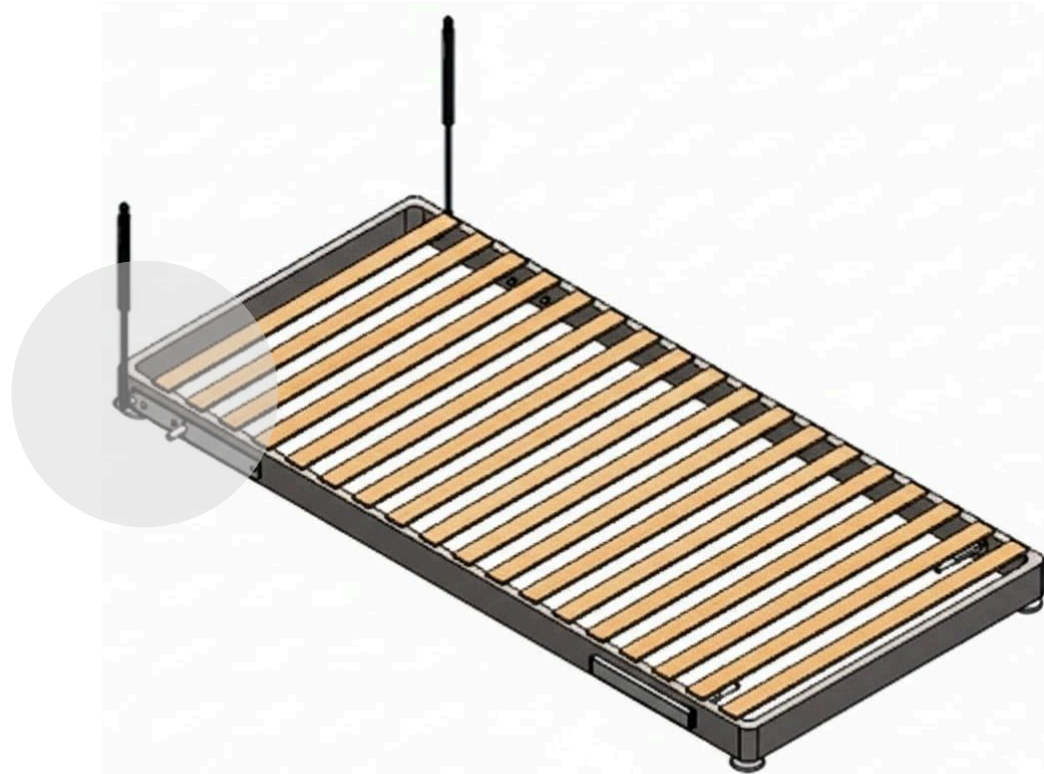

4. Install the bed base into the cabinet by resting the **bed bolts on the U-shaped plate supports**.

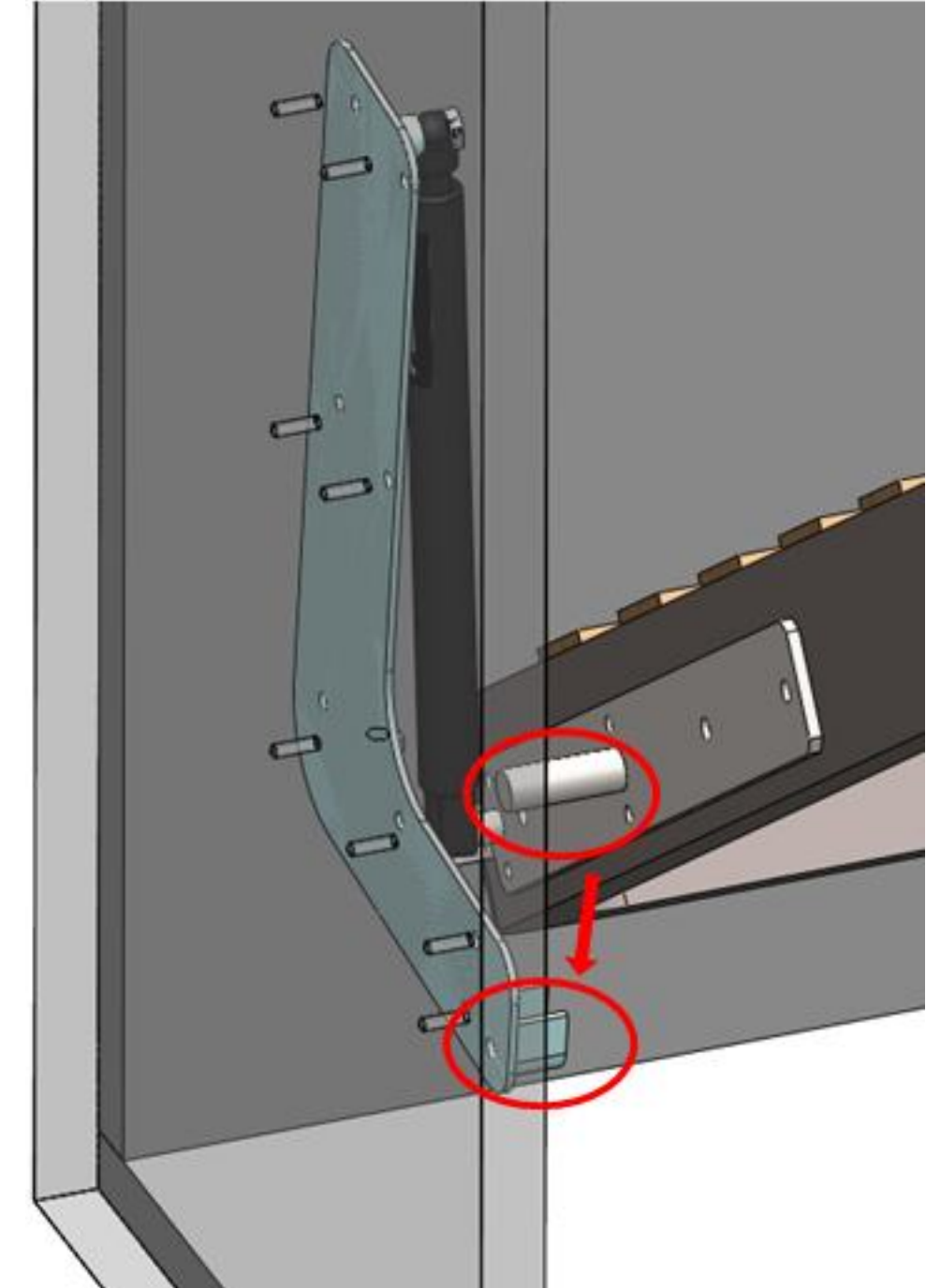

SYSTEM INSTALLATION

Gaz Lifts

5. Without installing the door, **close the bed frame beyond the cabinet front** and **secure the gas lift eyelet** to the plate's threaded bolt.

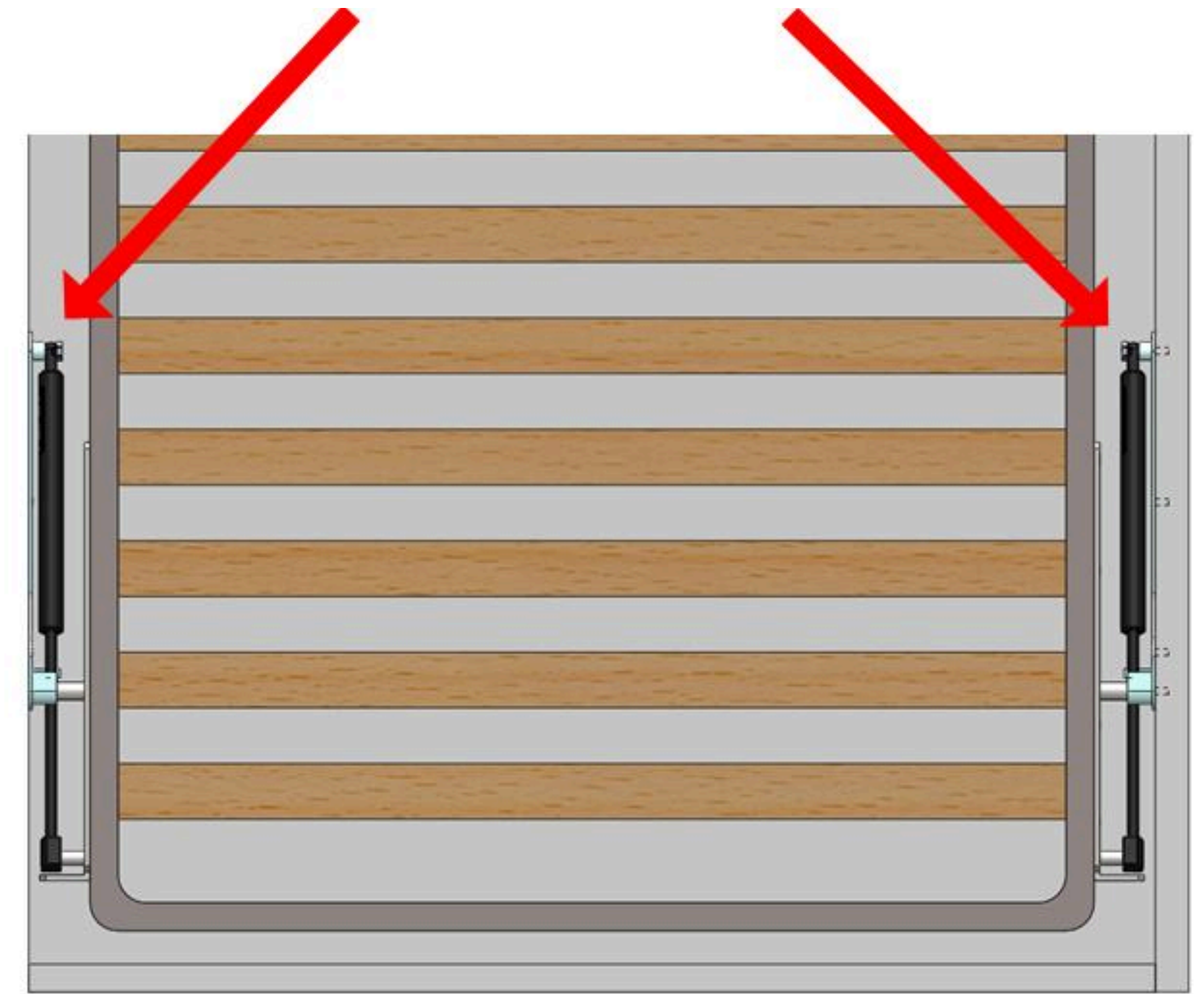
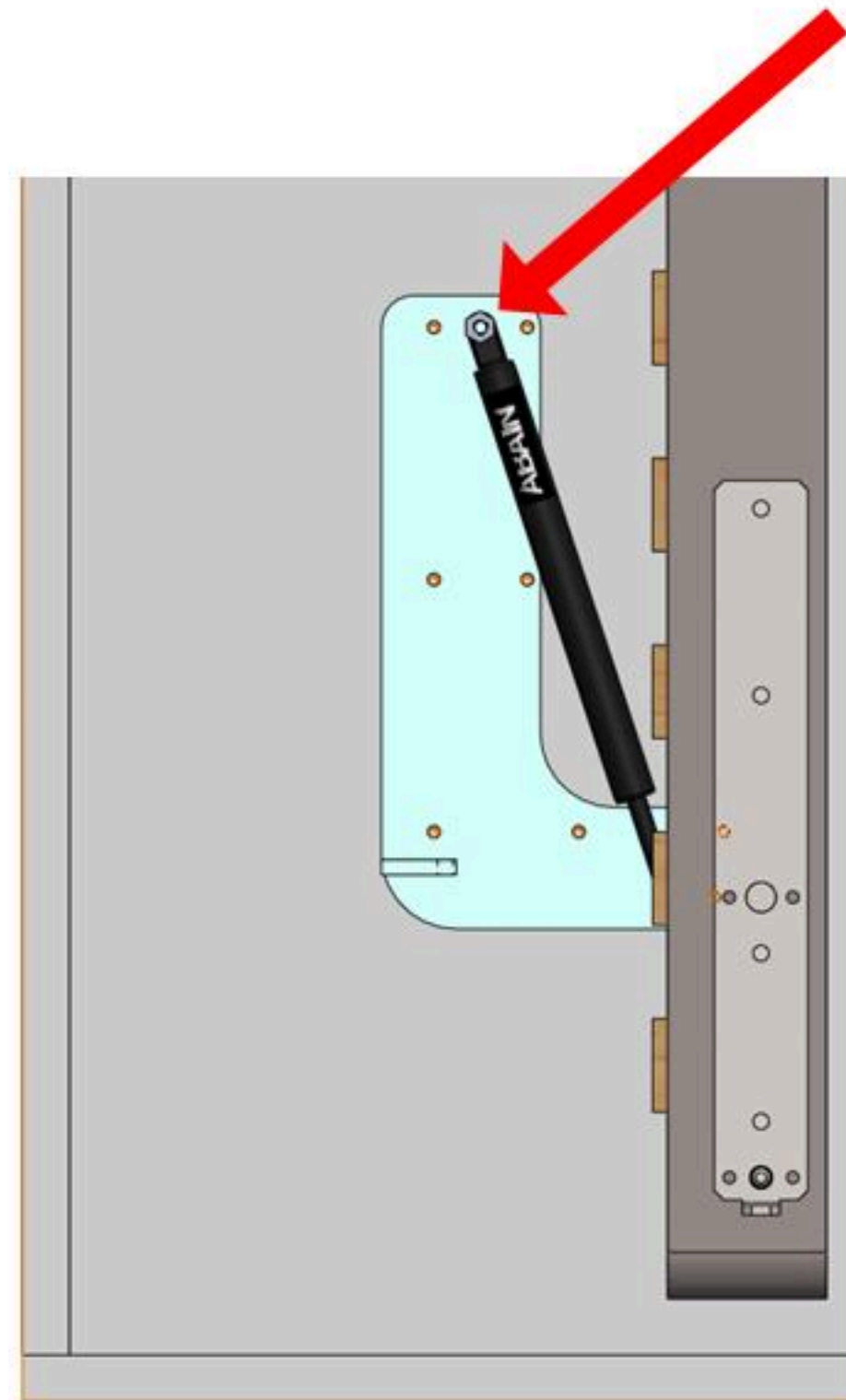

SYSTEM INSTALLATION

Legs Support

7. The **leg support** is **fixed to the bed frame** and **rests on the floor** to support the bed when opened.

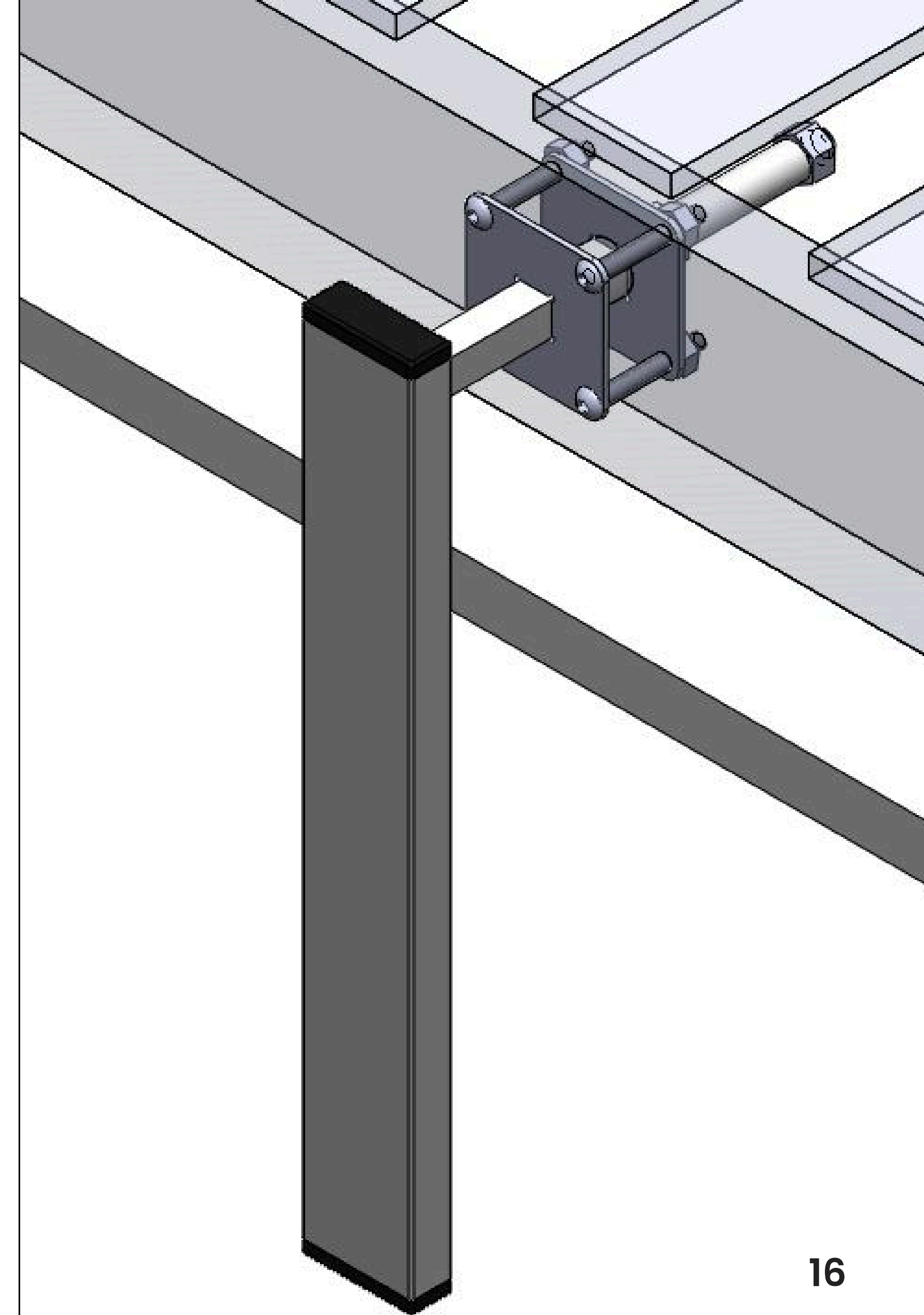

OPERATING SEQUENCE

Smooth Lowering With Support

Bed lowering sequence with automatic leg support engagement in the open position.

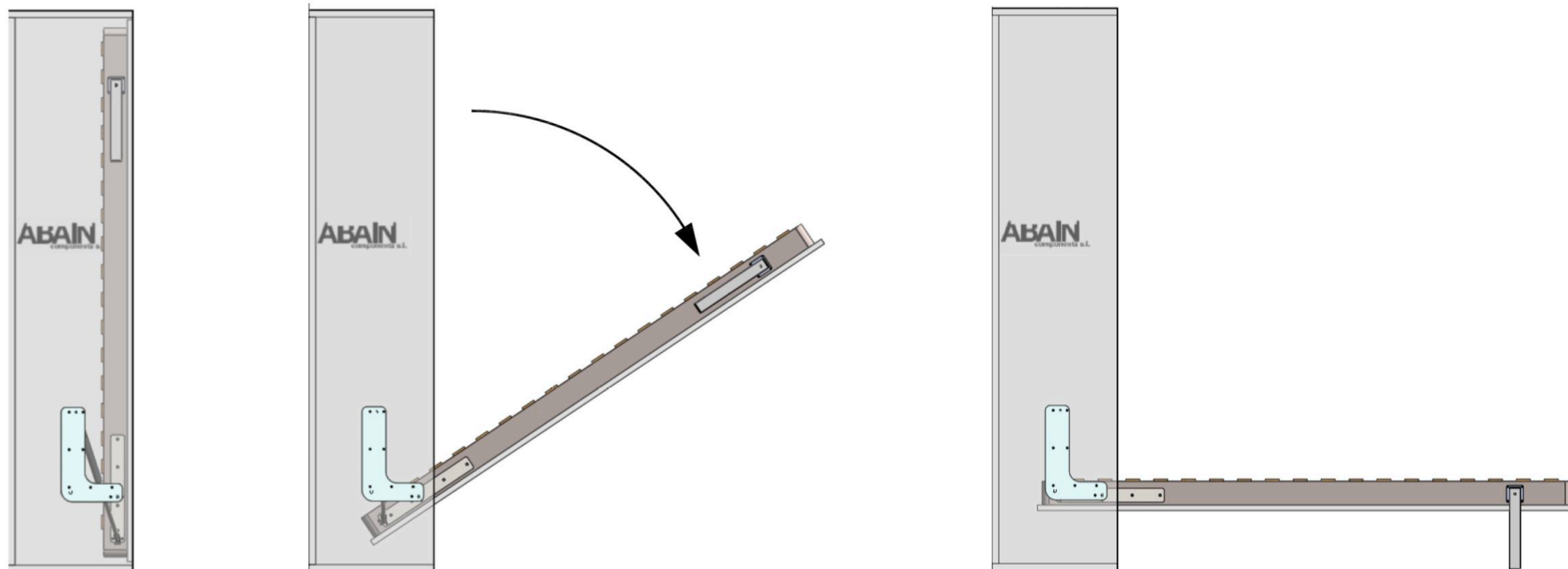



| Bed Systems

Nathalium .Co

Jamal Abdul Nasser Str. – Al Bahsas – Tripoli, Lebanon

Tel: 06/411790 , 06/411 791 – cell: 71/847529

www.nathalium.com – info@nathalium.com



© NATHALIUM 2026. All right reserved